

RECEIVED

JUN 10 2008

WATER RESOURCES DEPT.
SALEM, OREGON

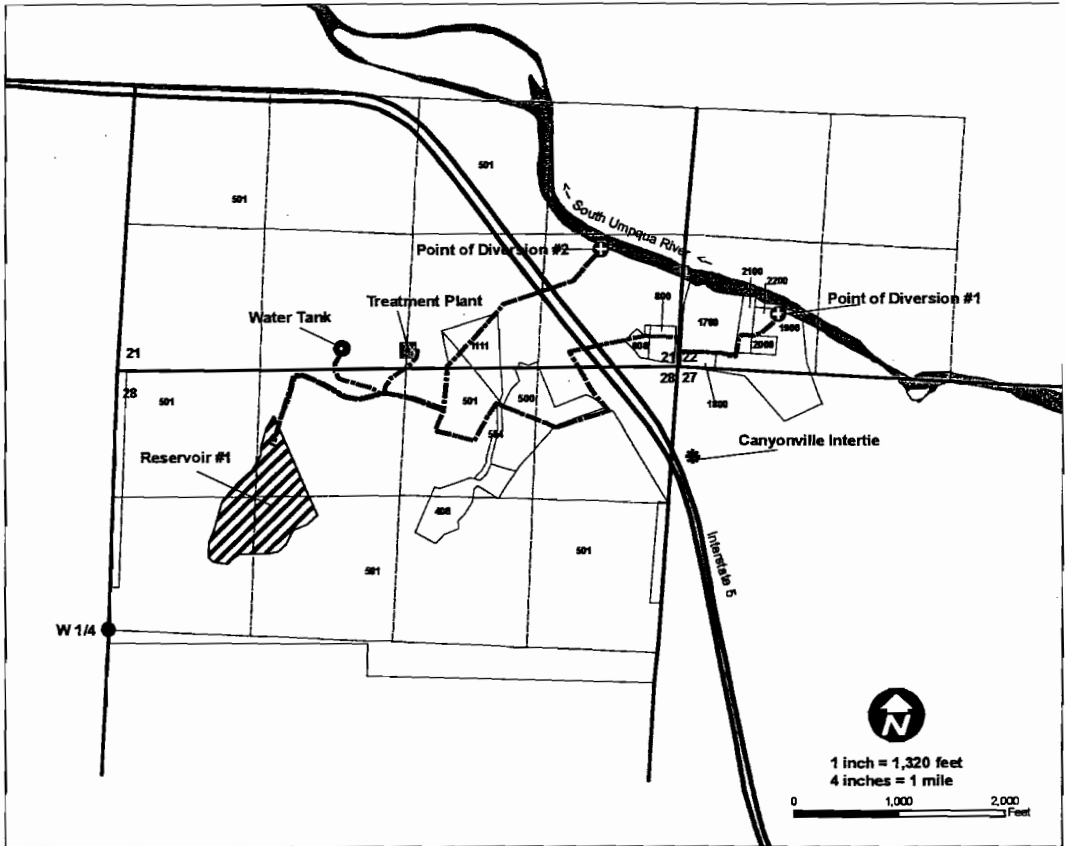

THE POINT OF DIVERSION #1 IS TO BE LOCATED 950 FEET EAST AND 535 FEET NORTH FROM THE SOUTH WEST CORNER OF SECTION 22; BEING WITHIN THE SW1/4SW1/4 OF SECTION 22, TOWNSHIP 30 SOUTH, RANGE 5 WEST W.M.; DOUGLAS COUNTY.

THE POINT OF DIVERSION #2 IS TO BE LOCATED 780 FEET WEST AND 1,150 FEET NORTH FROM THE SOUTH EAST CORNER OF SECTION 21; BEING WITHIN THE SE1/4NW1/4 OF SECTION 21, TOWNSHIP 30 SOUTH, RANGE 5 WEST W.M.; DOUGLAS COUNTY.

THE DAM IS LOCATED IN THE NE1/4NW1/4 OF SECTION 28 WITH THE CENTER OF THE DAM BEING 1,700 FEET EAST AND 1,500 FEET NORTH FROM THE 1/4 CORNER OF SECTION 28, TOWNSHIP 30 SOUTH, RANGE 5 WEST W.M.; DOUGLAS COUNTY.

Legend

- Point of Diversion
- Storage Tank
- Treatment Plant

- ▭ Quasi-Municipal Use Boundary
- ▭ Parcels - Tax Lot Nos.

R-87192

**APPLICATION TO STORE WATER IN A RESERVOIR
IN THE NAME OF
COW CREEK BAND OF UMPQUA TRIBE OF INDIANS
TOWNSHIP 30 SOUTH, RANGE 5 WEST, W.M.**

Place of Use

