

R-87511

RECEIVED

SEC.28 T.25S. R.6W. W.M.
DOUGLAS COUNTY
Scale 1" = 1000'

AUG 10 2009
WATER RESOURCES DEPT
SALEM, OREGON

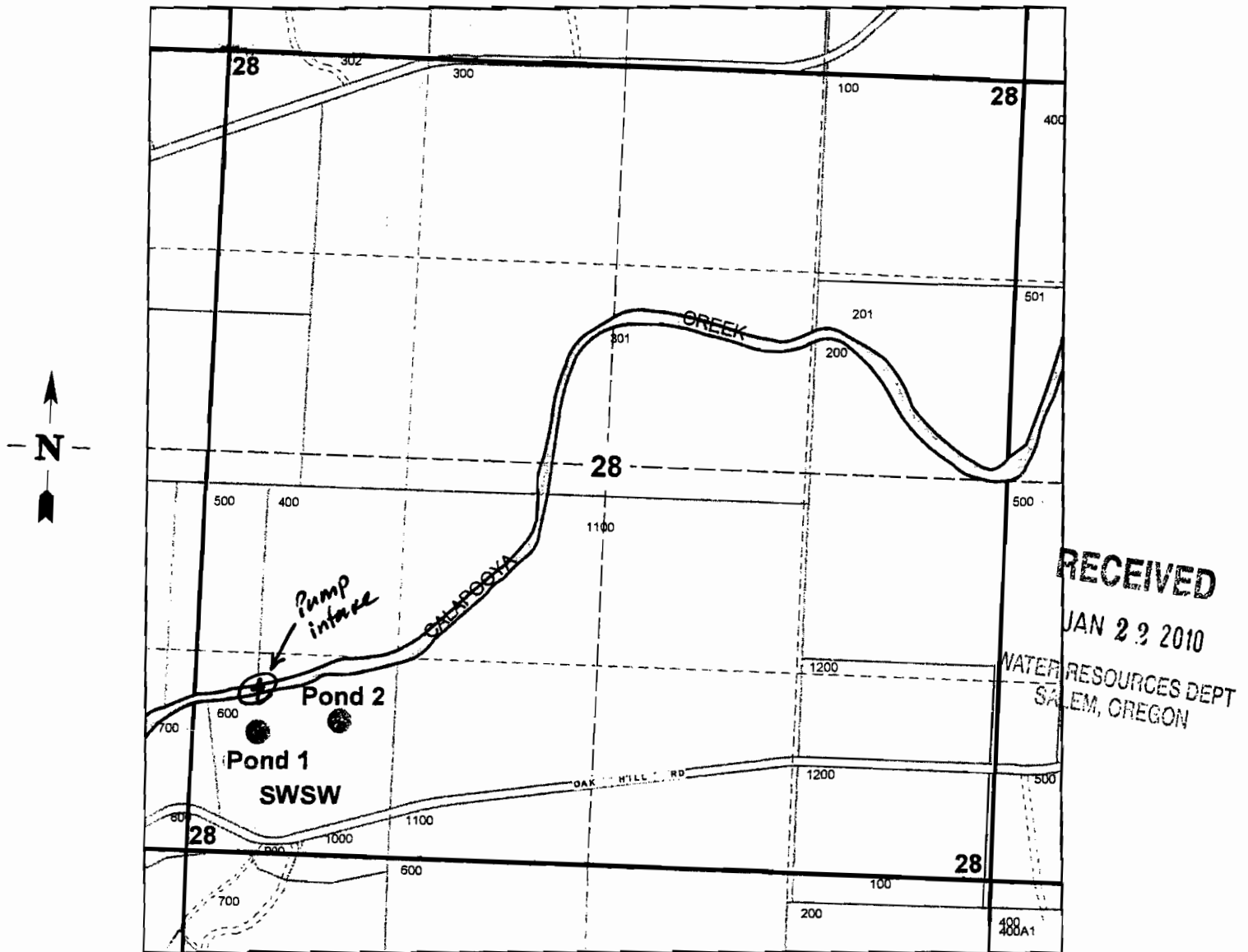

Pond 1 is located 830 ft. N. and 433 ft. E. of the SW corner of Section 28.

Pond 2 is located 896 ft. N. and 981 ft. E. of the SW corner of Section 28.

Pod: 915 N, 433 E of SW corner Sect. 28