

T.13S., R.33E., W.M.

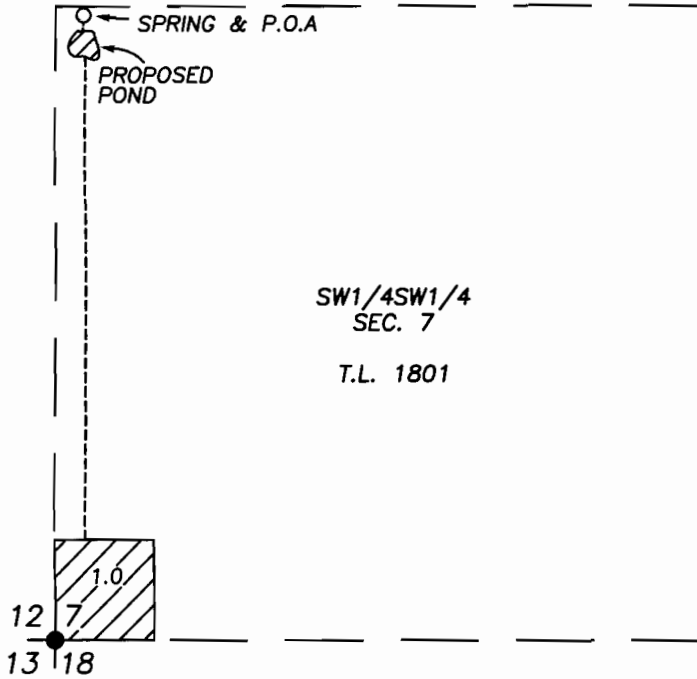

SPRING AND POINT OF APPROPRIATION IS 1310 FT. NORTH AND 60 FT. EAST OF THE SW CORNER OF SECTION 7 T.13S., R.33E., W.M.

Res: 1250 N + 60 E of SW corner
Section 7
(per App map: S-87576)

- FOUND ALUMINUM CAP MONUMENT
- T.L. TAX LOT
- PROPOSED PIPE LINE
- ▨ PROPOSED PLACE OF USE

NOTE: THE PREPARATION OF THIS MAP WAS FOR THE PURPOSE OF IDENTIFYING THE LOCATION OF THE PROPOSED WATER RIGHT AND HAS NO INTENT TO PROVIDE DIMENSIONS OR LOCATION OF PROPERTY OWNERSHIP LINES.



SCALE: 1"=400'

APPLICATION MAP
FOR
POINT OF APPROPRIATION
&
PROPOSED PLACE OF USE
FOR
KELLY & BARBARA VOIGT

BY

ROBERT D. BAGETT
217 N. CANYON BLVD.
JOHN DAY, OREGON
(541) 575-1251

JANUARY 22, 2010

RECEIVED

FEB 03 2010

WATER RESOURCES DEPT
SALEM, OREGON

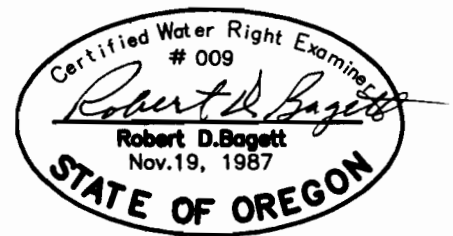

R-87576