

RECEIVED

RECEIVED

DEC 23 2009

IAN 12 2010

WATER RESOURCES DEPT
SALEM, OREGON

WATER RESOURCES DEPT
SALEM, OREGON

T.5S. R.3W. Sec. 4, 5, and 8, W.M.

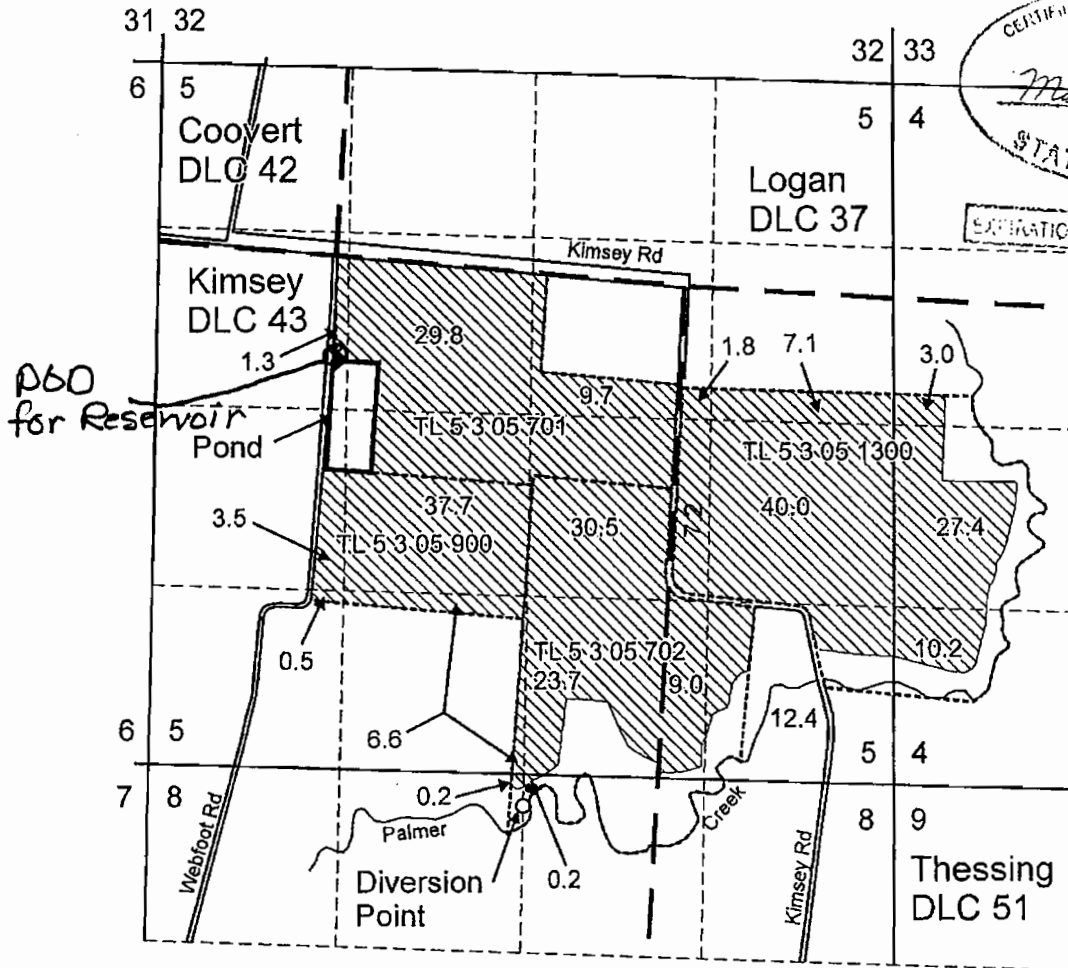

CERTIFIED WATER RIGHT APPLICATION
#60772WRE

Malia B. Kerpelle
MAY 14 2010
JUNE 25 2010
STATE OF OREGON

EXPIRATION DATE 10/30/11

Proposed point of diversion is located 4,020 feet south and 1,350 feet east from the SE corner of DLC 42.

POD for Reservoir 780 feet south & 0 feet west from SE Corner of DLC 42

Area (261.8 Acres) to be irrigated.

DLC boundary

Tax lot boundary

Note: The quarter quarter lines have been projected using a tax map, government land survey maps, an aerial photograph, and best professional judgement.

Scale: 1" = 1,320'



This map was prepared for the purpose of identifying the location of a water right only and is not intended to provide legal dimensions or location of property ownership lines.



Pacific Hydro-Geology Inc.

7/2009

Water Right Application Map
Surface Water Right
Carlton Nursery Co., LLC.
Gordon/Ediger/Webfoot
T.5S. R.3W. Sec. 4, 5, and 8, W.M.

GordonGW-SWApp.cdr

** orig w/s-875dt/mm*