

# Application for a Water Right Permit to Store Water

Nike Inc.

Township 1 South, Range 1 West, Section 5 (W.M.)

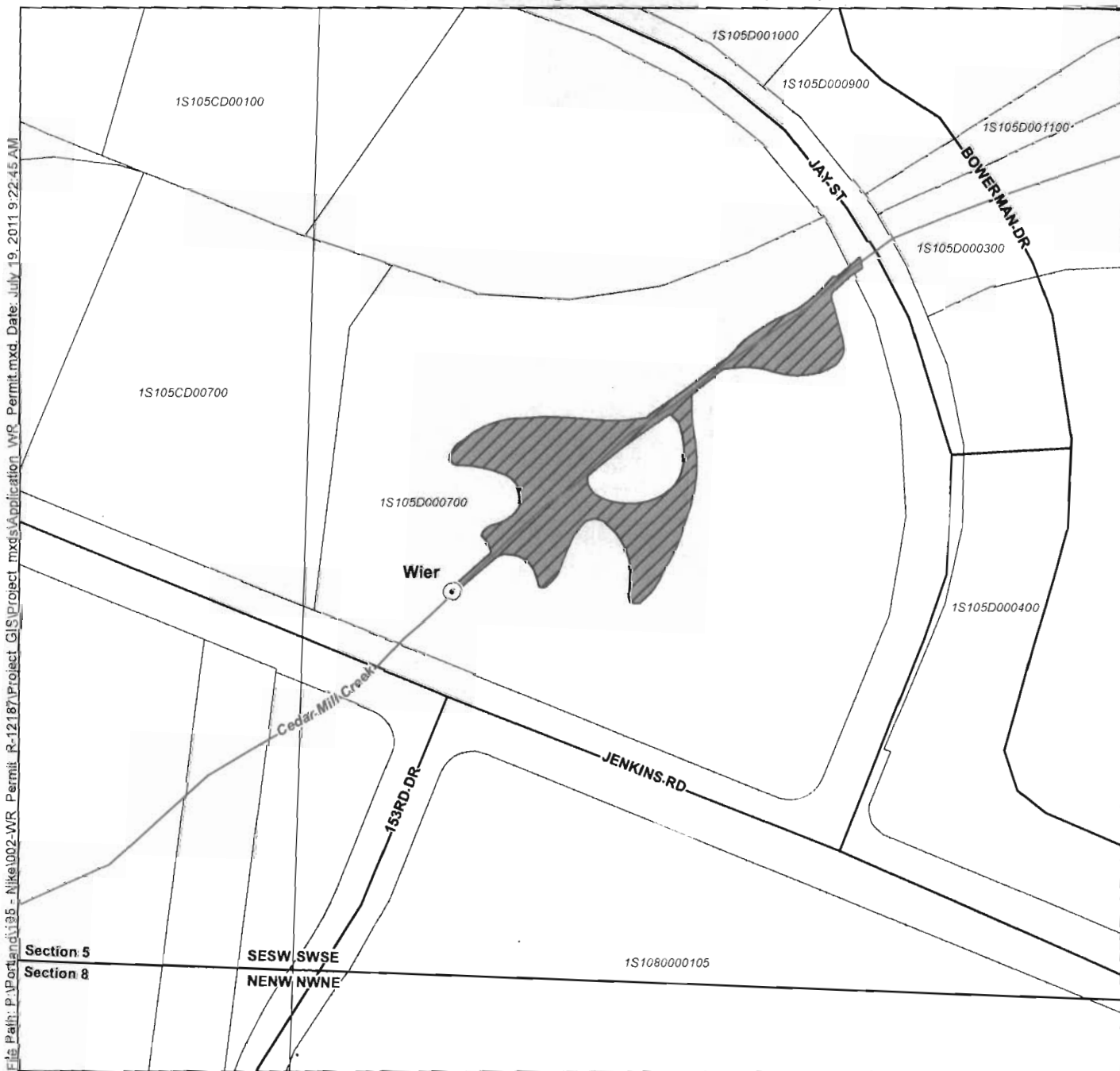

File Path: P:\Portland\135 - Nike\002-WR Permit\_R-12187\Project\_GIS\Project\_mxds\Application\_WR\_Permit.mxd Date: July 19, 2011 9:22:45 AM

**LEGEND**

- Point of Diversion (POD)
- Place of Use (POU)
- Taxlots
- streets
- Watercourses
- Waterbodies

**Disclaimer**

This map was prepared for the purpose of identifying the location of a water right only and it is not intended to provide legal dimensions or location of property ownership lines.

**Map Notes**

Date: July 19, 2011  
Data Sources: Nike, METRO  
Prepared By: GSI Water Solutions, Inc

**RECEIVED**

NOV 08 2011

WATER RESOURCES DEPT  
SALEM, OREGON

**POD Legal Description:**

Weir - Located 505 feet North and 200 feet East from the South quarter corner of Section 5, Township 1 South, Range 1 West (W.M.).

R-87766

