

RECEIVED

AUG 12 2011

WATER RESOURCES DIVISION
SALEEM, OREGON

ROBERT L. and LEANN R. MCKEE RESERVOIR APPLICATION MAP

Addendum to
Application R-17474



Scale 1" = 1320'

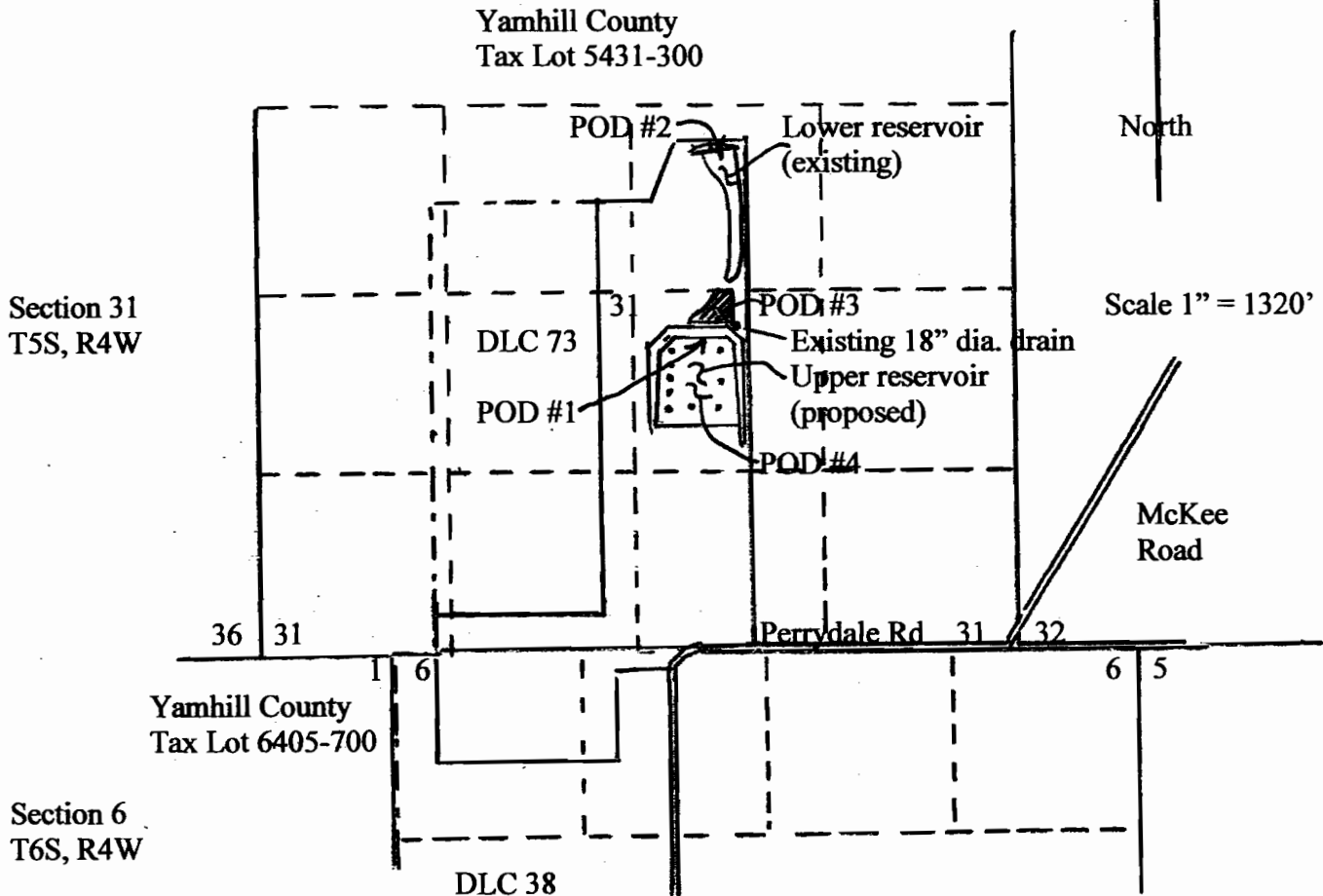

POD #1 for upper reservoir is located 400' east and 350' south from the center of Section 31, T5S, R4W
 POD #2 for lower reservoir is located 550' east and 1000' north from the center of Section 31, T5S, R4W (existing reservoir P-77020)

POD #3 for unnamed diverse spring area located 600' east and 100' south from the center of Section 31, T5S, R4W.

POD #4 for one existing 18" dia. subsurface field drain outlet, and six to eight or more 4" or 6" dia. subsurface field drain outlets, that are expected to be exposed by earth excavation in the upper reservoir area (borrow area) is located near 450' east and 600' south from the center of Section 31, T5S, R4W See Ground Water Application G-17474.

 Unnamed diverse spring area

 4" or 6" diameter subsurface field drain outlets to be exposed by borrow excavation

Note: The 1/4 1/4 lines have been projected using tax lot maps, government land survey maps, an aerial photograph and best professional judgment.

This map was prepared for the purpose of identifying the location of a water right only and is not intended to provide legal dimensions or location of property ownership lines.

ROBERT L. and LEANN R. MCKEE
 SURFACE WATER RIGHT, GROUND WATER RIGHT,
 and RESERVOIR APPLICATION MAP

RECEIVED

JUL 06 2011
 WATER RESOURCES DEPT
 SALEM, OREGON

Yamhill County
 Tax Lot 5431-300

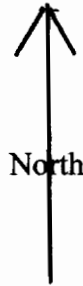

Scale 1" = 1320'

Section 31
 T5S, R4W

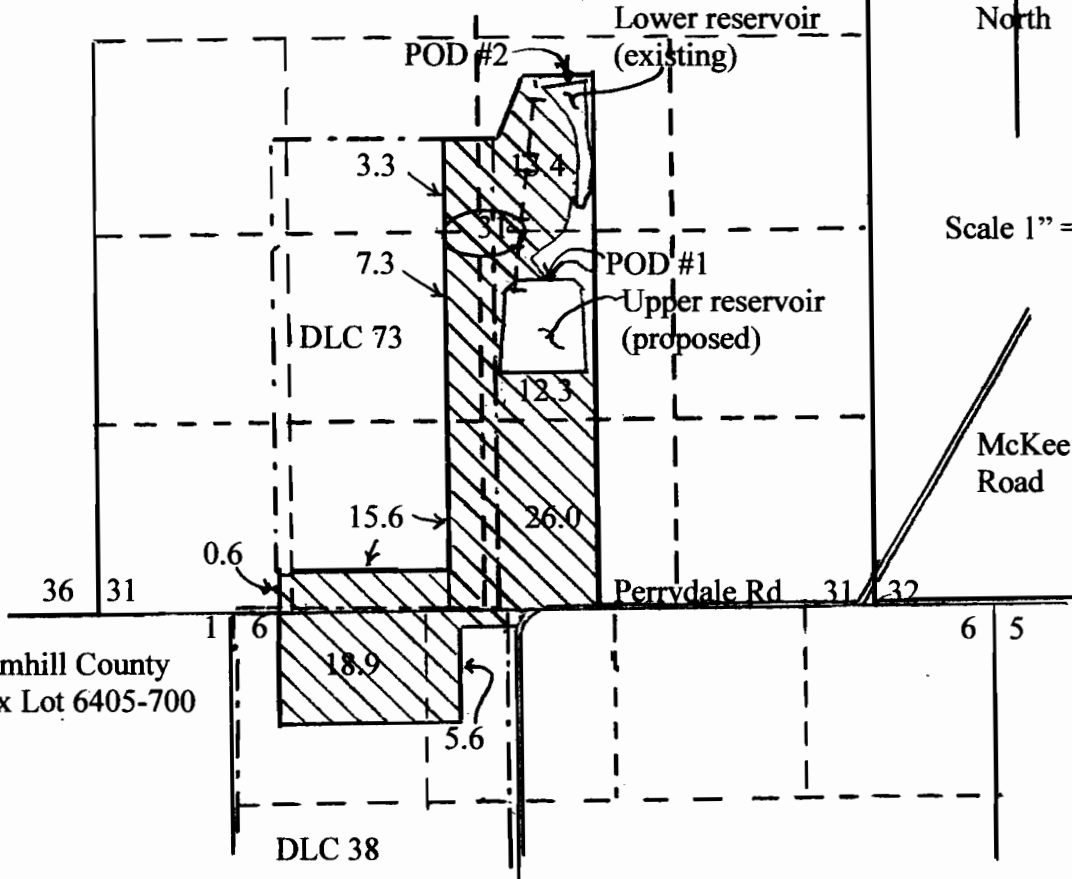

POD #1 for upper reservoir is located 400' east and 350' south from the center of Section 31, T5S, R4W
 POD #2 for lower reservoir is located 550' east and 1000' north from the center of Section 31, T5S, R4W (existing reservoir P-77020)

- Area (103.4 acres) to be irrigated
- - - DLC boundary
- + - + - Pipeline

Note: The 1/4 1/4 lines have been projected using tax lot maps, government land survey maps, an aerial photograph and best professional judgment.

This map was prepared for the purpose of identifying the location of a water right only and is not intended to provide legal dimensions or location of property ownership lines.

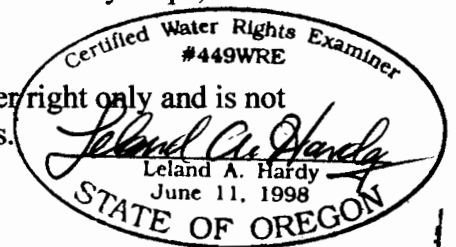

RENEWAL DATE: 6/30/2013

R-87735