

# Alternate Reservoir Application Map 36S-2W-11-SW/SW Tax Lot 2100

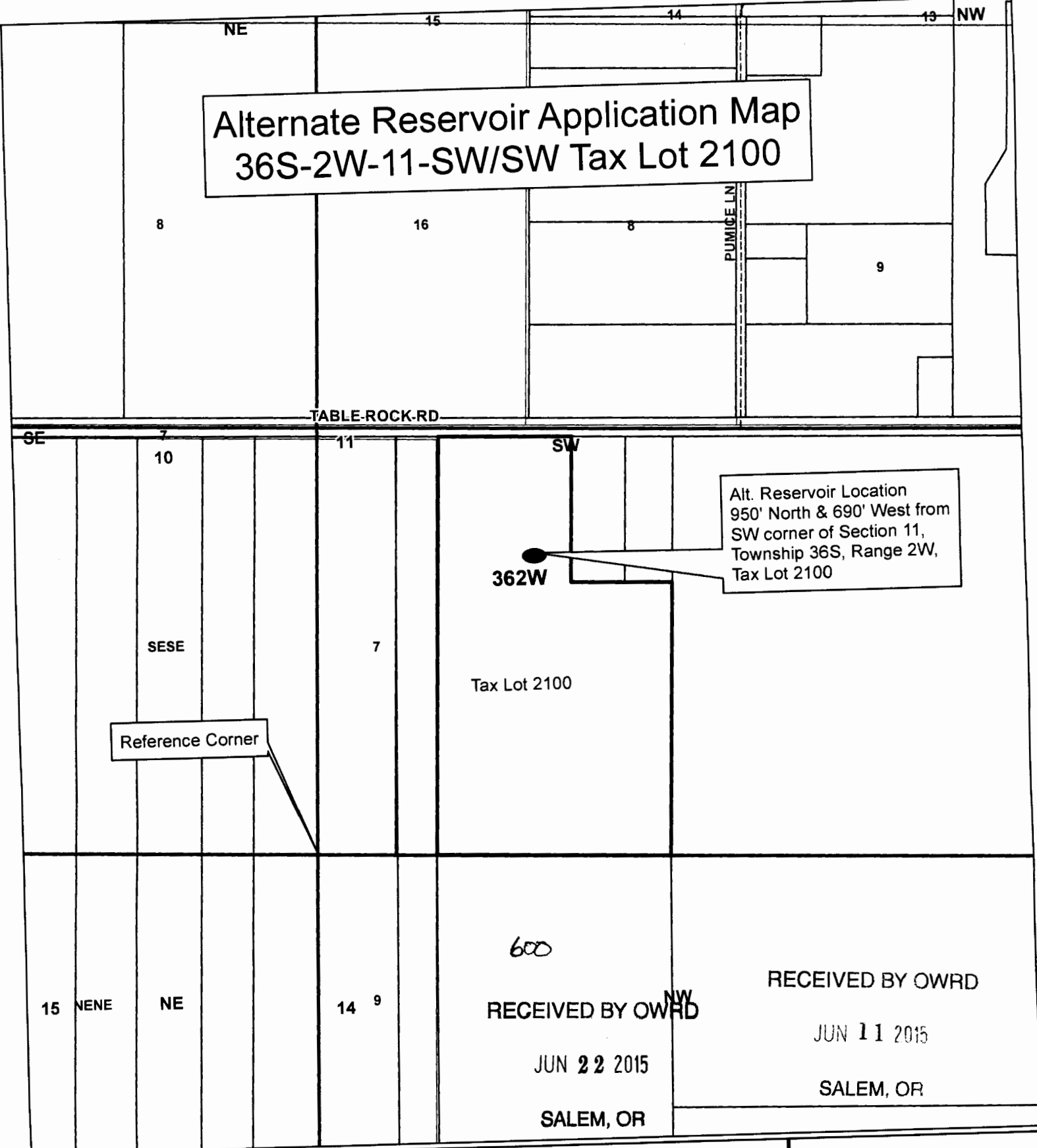

Alt. Reservoir Location  
950' North & 690' West from  
SW corner of Section 11,  
Township 36S, Range 2W,  
Tax Lot 2100

Reference Corner

Tax Lot 2100

RECEIVED BY OWRD

JUN 22 2015

SALEM, OR

RECEIVED BY OWRD

JUN 11 2015

SALEM, OR

### Legend

- Alt. Reservoir
- Taxlot 2100
- Taxlots
- Townships
- Sections
- Quarter Sections
- Quarter Quarter Sections

1 inch = 400 feet

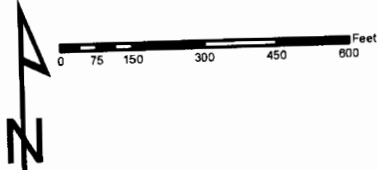

JACKSON COUNTY  
**WATERMASTER**

Prepared by Travis Kelly

This map is based on a digital database compiled by Jackson County from a variety of sources. Jackson County cannot accept responsibility for errors, omissions, or positional accuracy. There are no warranties, expressed or implied.

Date: 04/07/2015; Alt. Reservoir 36S-2W-11-SWSW-taxlot 2100.mxd; Kelly.TN

R-88101