

WATER RIGHTS APPLICATION MAP

TAXLOTS: 3400, SECTION 26; &
1300, 1301 & 1200 SECTION 35; T2S, R3W, WM
YAMHILL COUNTY, OREGON
WILLAMETTE RIVER BASIN

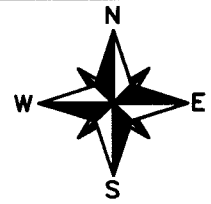

RECEIVED BY OWRD

JUN 11 2014

SALEM, OR

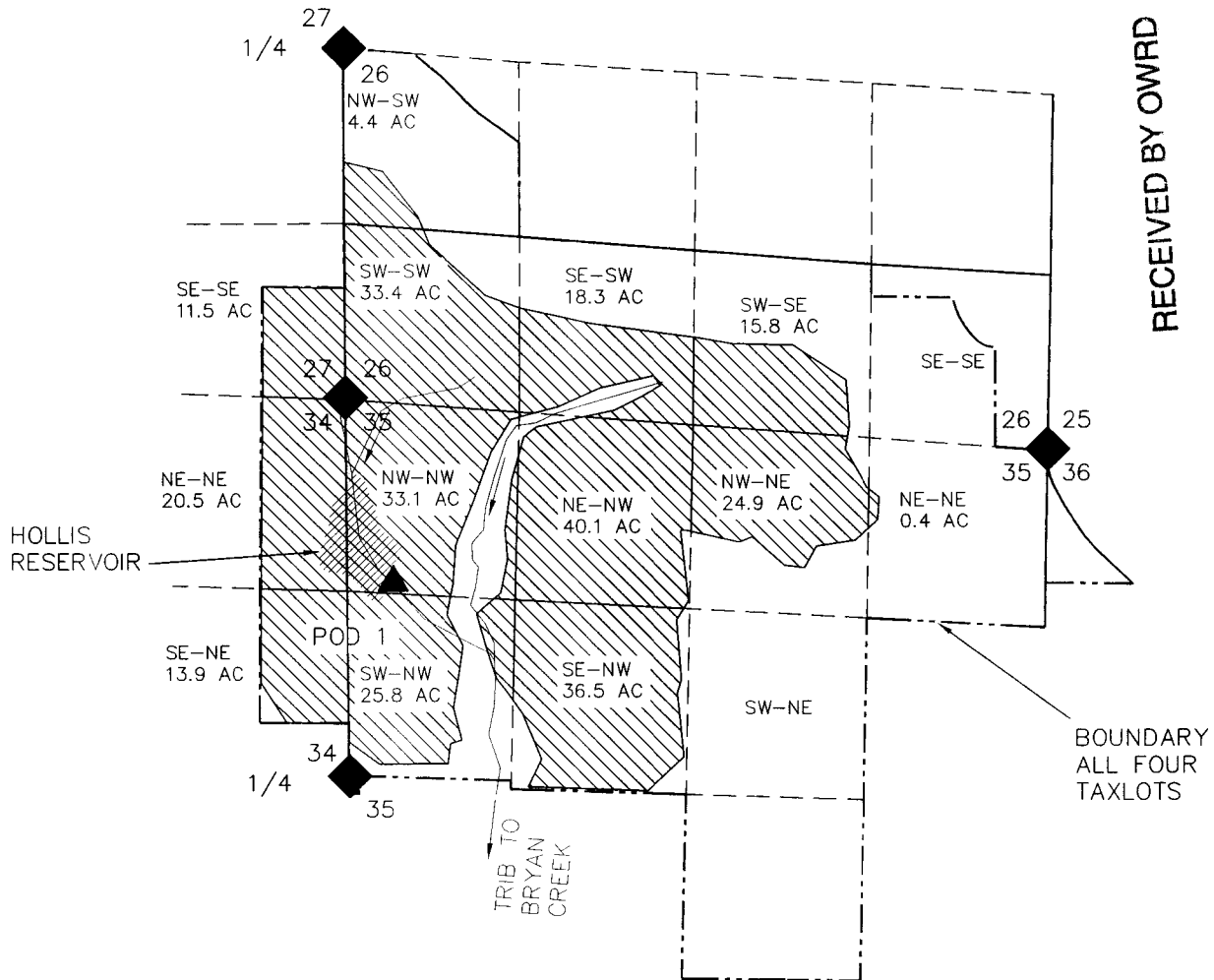

LEGEND:

- ◆ SECTION CORNER or 1/4 CORNER
- ▲ POINT OF DIVERSION (POD)

— PROPERTY LINE

- - - 1/16TH LINE

PROPOSED IRRIGATION AREAS

POD 1 IS 1370 FT SOUTH AND 340 FEET EAST OF NE CORNER S35

MAP BASE:
COUNTY SURVEY RECORD CSP-10277 AND SITE SPECIFIC AERIAL PHOTO

PREPARED FOR:
HOLLIS LAND & TIMBER



Project: 313081
Drawing: 313081J-WRAppl.dwg
By: EAU
Checked by: EAU
Date: 27MAY2014

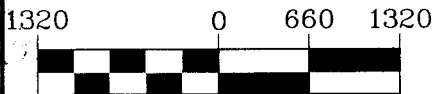

1 inch = 1320 ft.

THIS MAP WAS PREPARED FOR THE PURPOSE OF IDENTIFYING THE LOCATION OF A WATER RIGHT ONLY AND IS NOT INTENDED TO PROVIDE LEGAL DIMENSIONS OR LOCATION OF PROPERTY OWNERSHIP LINES.

R-07985