

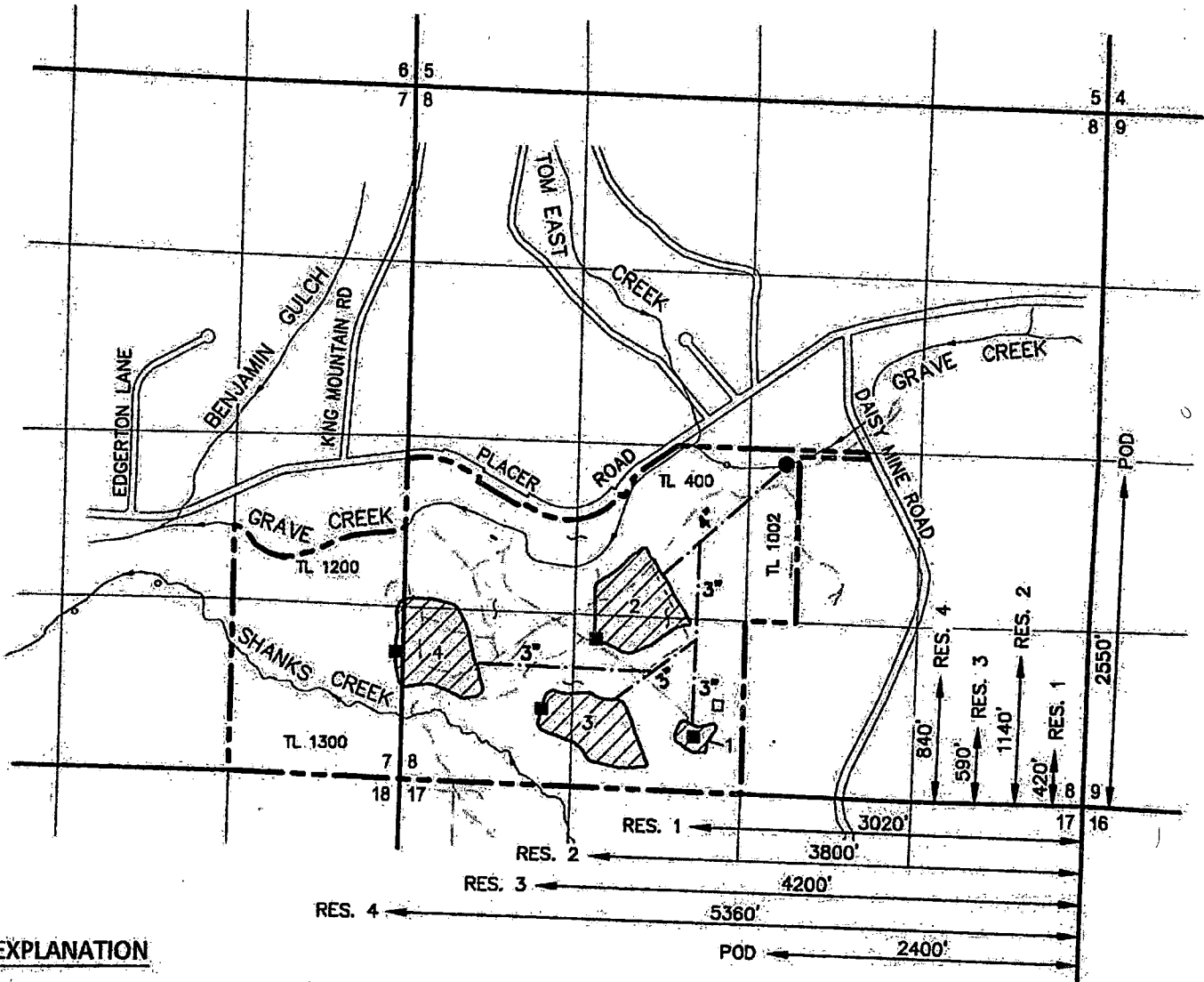

SECTIONS 7 & 8, T34S, R5W, W.M.
JOSEPHINE COUNTY



EXPLANATION

- POINT OF DIVERSION (POD)
- DAM OR CENTER OF RESERVOIR
-  PROPOSED RESERVOIR AND NUMBER
- SECTION LINE
- - - PROPERTY LINE
- CREEK OR INTERMITTENT STREAM
- == PAVED ROAD
- - - UNPAVED ROAD
- - - PROPOSED PIPELINE AND SIZE

NOTE:

RESERVOIRS WILL BE LOCATED OFF CHANNEL.

RECEIVED

SEP 12 2013

WATER RESOURCES DEPT
SALEM, OREGON

AUGUST 7, 2013

THIS MAP IS NOT INTENDED TO PROVIDE
LEGAL DIMENSIONS OR LOCATIONS OF
PROPERTY OWNERSHIP LINES

SKOOKUM
WATER ASSOCIATES INC

P.O. BOX 80174
PORTLAND, OR 97280
(503) 319-8926

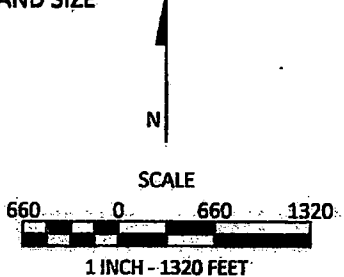

Sunny Valley Sand and Gravel Inc.
Reservoir Application Map
Westlake Consultants, Inc.