

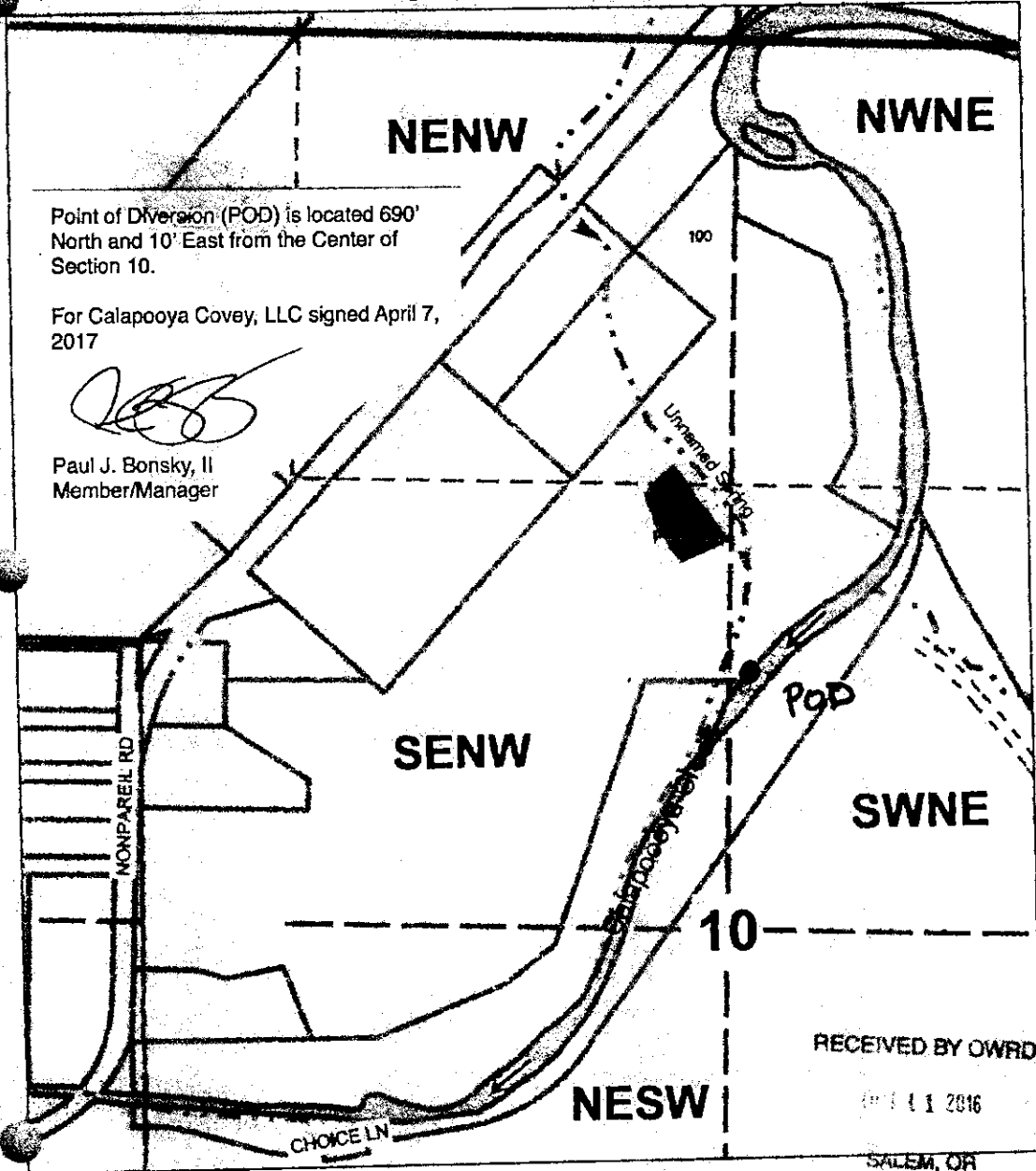

Calapooya Covey, LLC
T.25S. R.4W. Sec. 10
Douglas County
Scale: 1" = 400



Point of Diversion (POD) is located 690' North and 10' East from the Center of Section 10.

For Calapooya Covey, LLC signed April 7, 2017

Paul J. Bonsky, II
Member/Manager

Pond is located 1275' North and 150' West from the Center of Section 10.

R-88298 4.7.2017