

# Application for a Permit to Store Water in the Name of Sarbanand Enterprises Township 4 South, Range 4 West (W.M.)

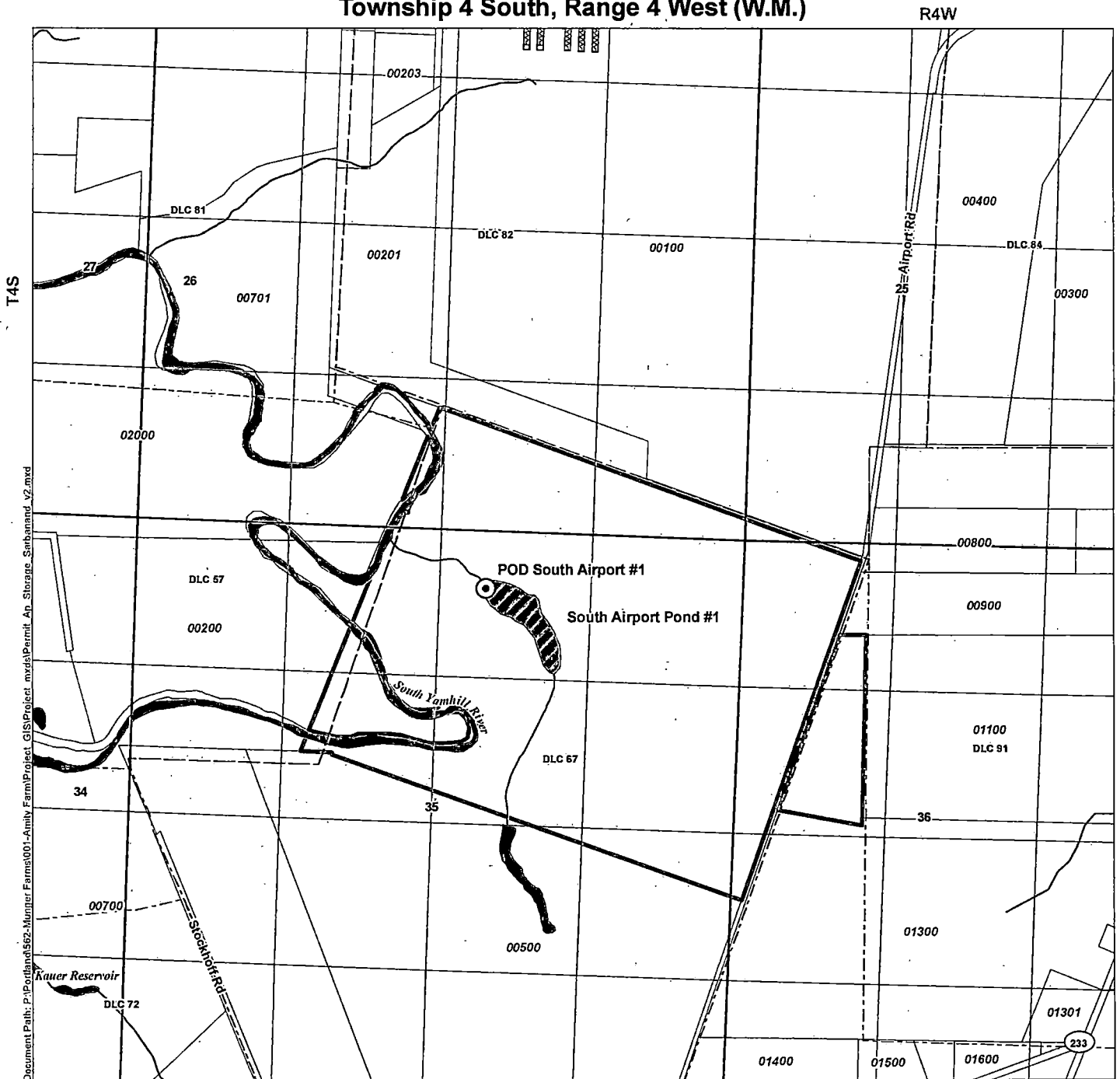

Document Path: P:\Portland\562-Mugner Farms\001-Ambly Farm\Project\_GIS\Project\_mxd\Permit\_An\_Storage\_Sarbanand\_v2.mxd

**LEGEND**

- Point of Diversion (POD)
- South Airport Pond #2
- Property Boundary
- Tax Lot
- Donation Land Claim (DLC)
- Watercourse
- Waterbody

**DISCLAIMER**

This map was prepared for the purpose of identifying the location of a water right only and it is not intended to provide legal dimensions or location of property ownership lines.

**MAP NOTES**

Date: November 1, 2016  
Data Sources: BLM, ESRI, USGS, Yamhill Co.

RECEIVED BY OWRD

JUN 14 2017

SALEM, OR

**POD LOCATION DESCRIPTION**

POD South Airport Pond #1  
Located 510 feet South and 2280 feet East from the NW corner of Section 35, Township 4 South, Range 4 West (W.M.)

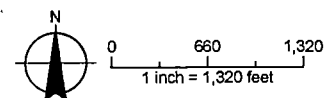

R-88417