

Application for a Permit to Store Water
Application R-86762
 A Water Right in the Name of Roserock West 2, LLC
 Polk County
 Township 7 South, Range 4 West (W.M.)

RECEIVED

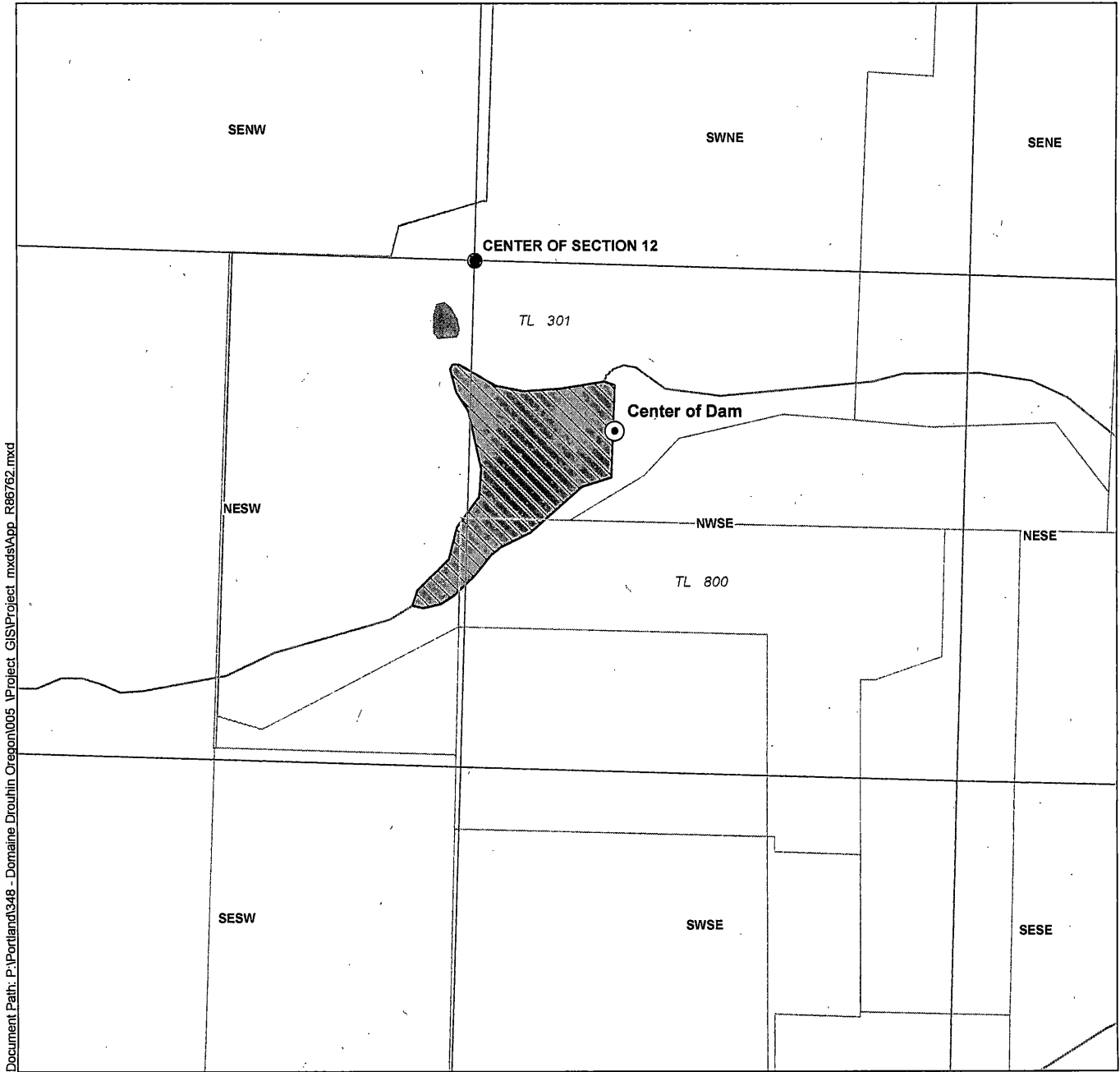



JUL 6 2017

OWRD



Document Path: P:\Portland\348 - Domaine Drouhin Oregon\005 - Project_GIS\Project.mxd\App_R86762.mxd

LEGEND

-  Point of Diversion (POD)
-  Place of Use (POU)
-  Tax Lot
-  Watercourse
-  Waterbody

Disclaimer

This map was prepared for the purpose of identifying the location of a water right only and it is not intended to provide legal dimensions or location of property ownership lines.

Map Notes

Date: November 24, 2015
 Data Sources: BLM, USGS, Polk Co.
 Prepared By: GSI Water Solutions, Inc.

POD Location Description

Center of Dam
 Located 435 feet South and 385 feet East from the center of Section 12, Township 7 South, Range 4 West (W.M.)

