

SECTION 10, T05, R7 W, W.M., POLK COUNTY  
 Section 33, T5S, R5W, W.M., Yamhill County  
 Zach Christensen

FROM MAP

TO MAP

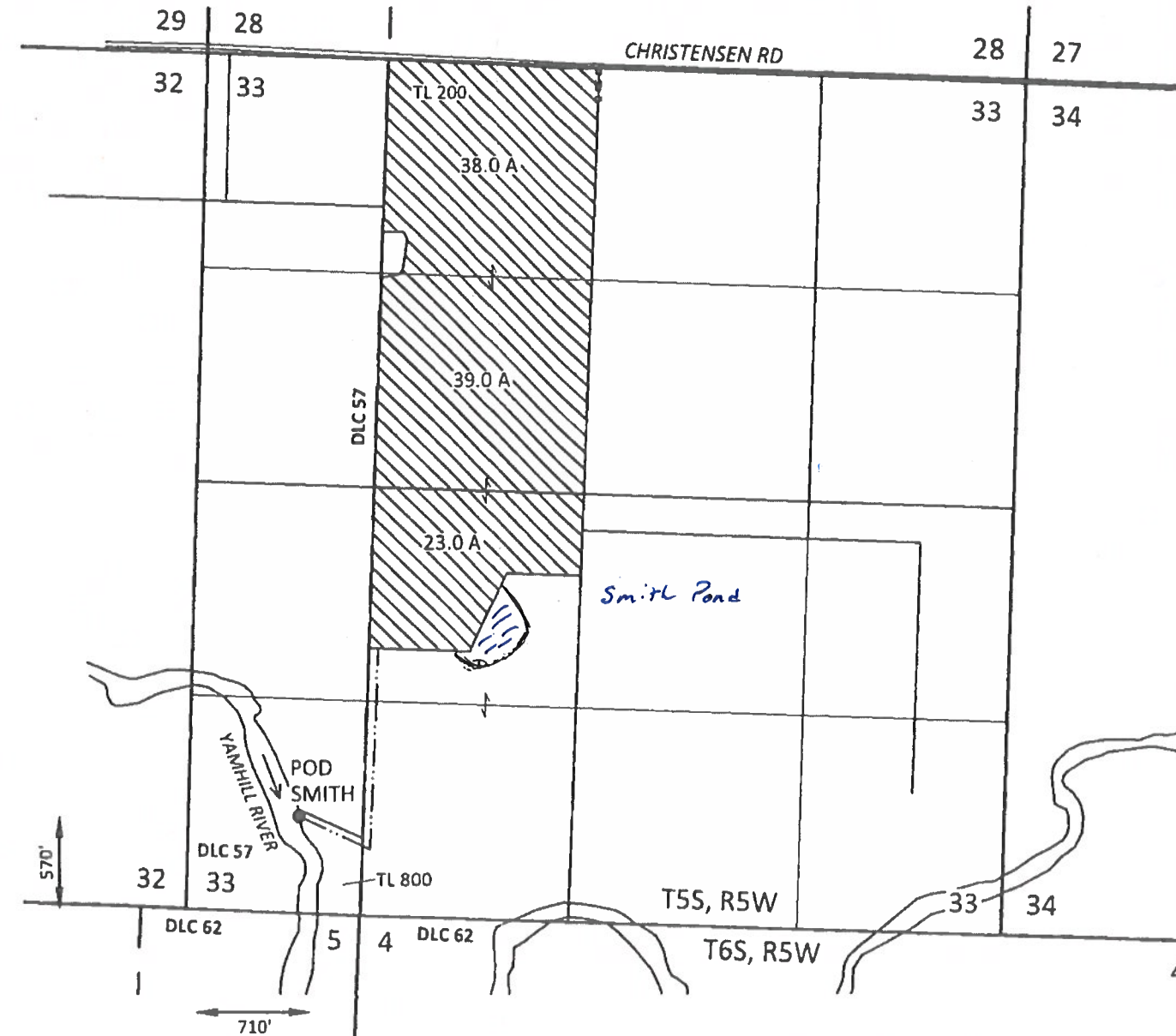
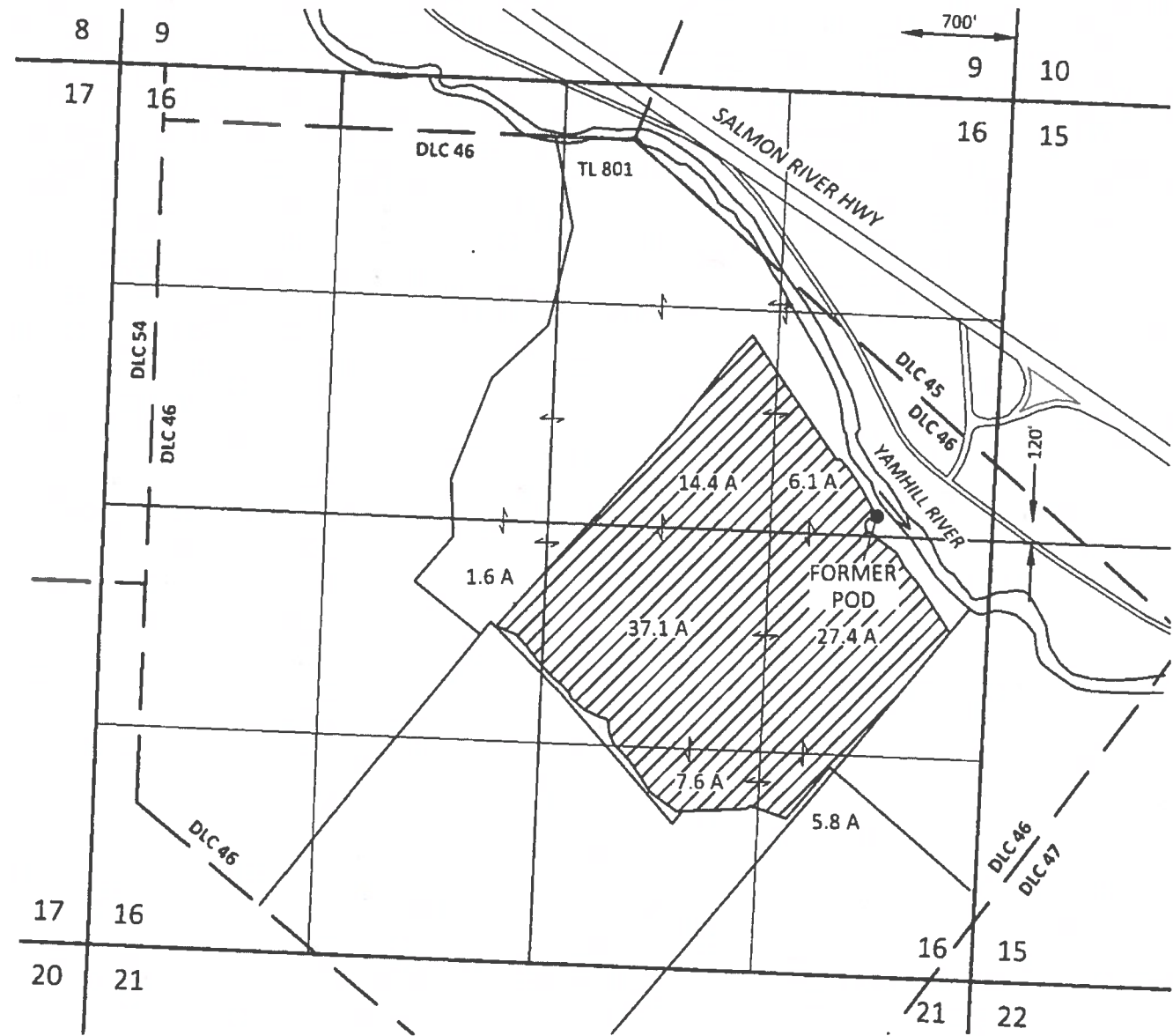

Dam 1480' North and 1890 East from SW corner section 33

EXPLANATION

FROM LANDS



CERTIFICATE 62271 (100.0 AC)  
 IRRIGATION - SOUTH YAMHILL RIVER  
 PRIORITY: 3/3/1978

TO LANDS



CERTIFICATE 62271 (100.0 AC)  
 IRRIGATION - SOUTH YAMHILL RIVER  
 PRIORITY: 3/3/1978

RECEIVED

MAR 22 2018

OWRD

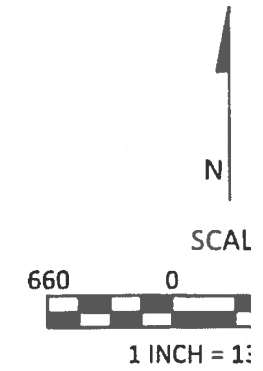
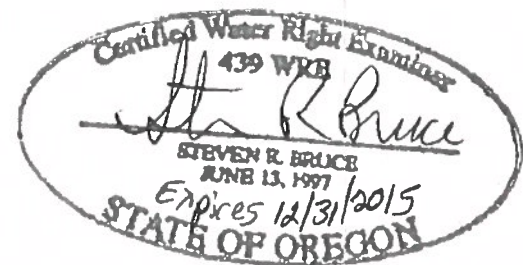

July 23,

This map is not intended

P.001111

