

# 22853 Harris Rd Gallagher Proposed Pond 1:4000

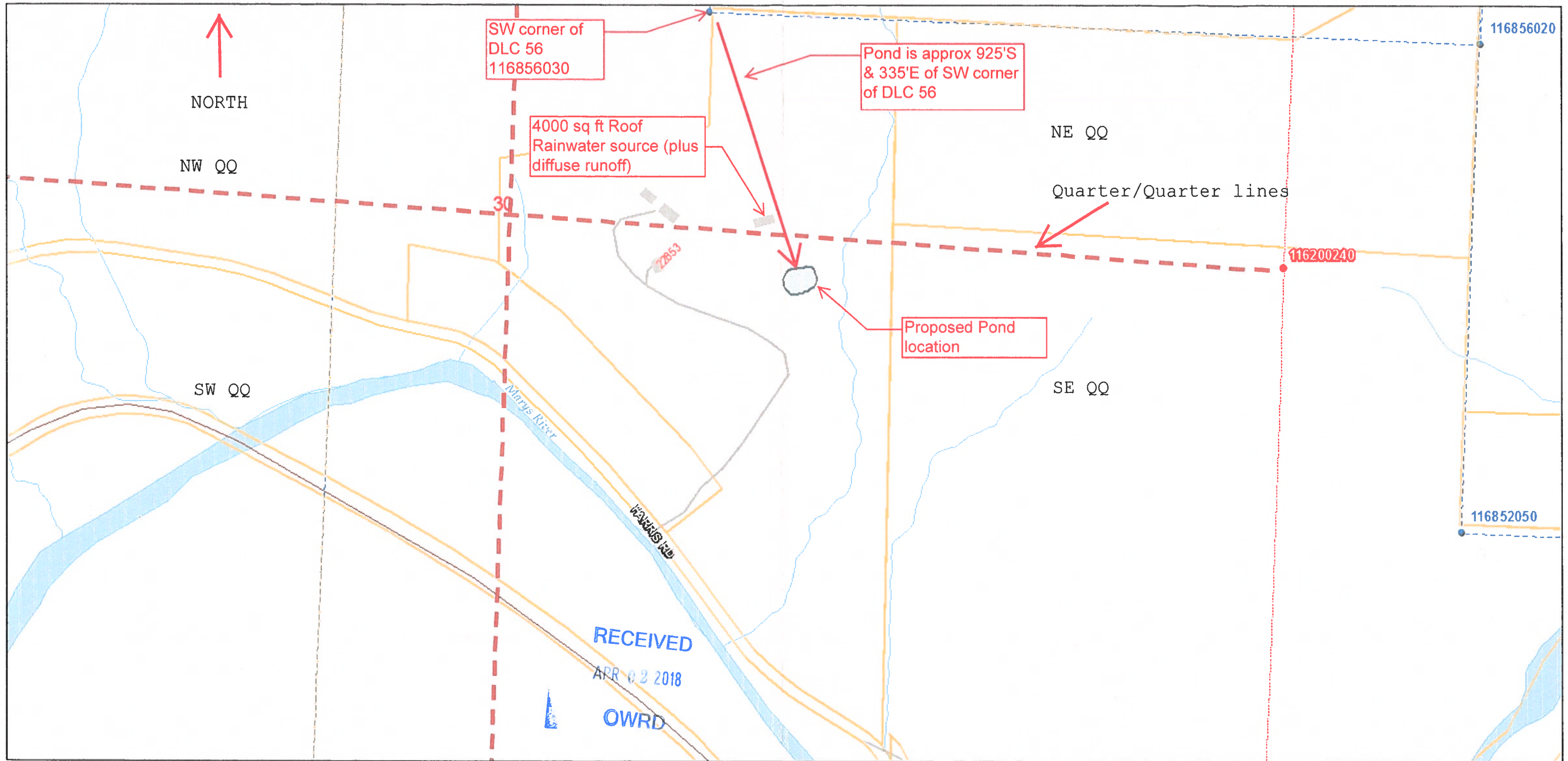

2/22/2018, 12:14:29 AM

ArcGIS\_Public.SDE.sectionlines

SEC-LINE

ArcGIS\_Public.SDE.section\_centroids

TaxlotOwners

ArcGIS\_Public.SDE.Railroads

ArcGIS\_Public.SDE.Roads

ArcGIS\_Public.SDE.dlc\_corner\_index

ArcGIS\_Public.SDE.section\_corner\_index

Donation Land Claims

ArcGIS\_Public.SDE.survey\_index

County\_Addresses

Buildings

Driveways

Hydro\_polys

Hydro\_lines

Cities and Places

County Boundary

County Parks

11S Township

6W Range

30 Section

NE/SE Quarter/Quarter

Tax Lot: 302

1:4,000

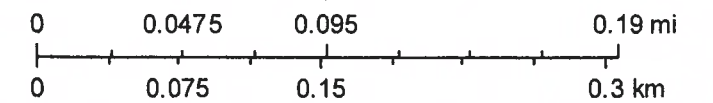

Benton County, Oregon

Benton County, Oregon

This product is for informational purposes and may not have been prepared for, or be suitable for legal, engineering, or surveying purposes. Users of this information should review or consult the primary data and information.

R-88461