

Reservoir Application Map
Will Vogel
NE Sec. 36 T.24S. R.5W. W.M.
Douglas County
Scale 1" = 400'

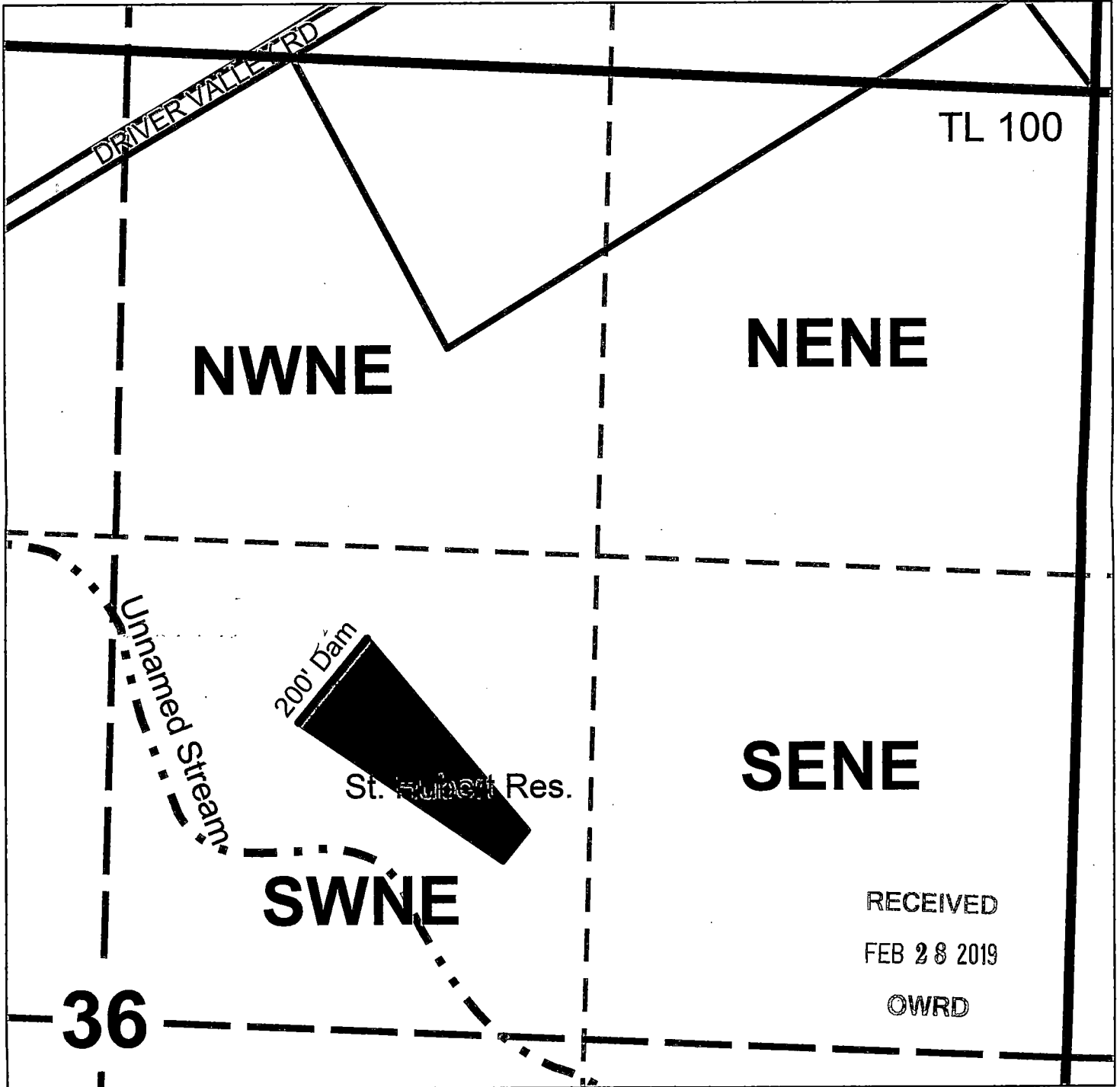

**Dam is located 1670 ft. South and 2040 ft. West from
the Northeast Quarter Corner of Section 36.**

Reservoir Application Map
Will Vogel
NE Sec. 36 T.24S. R.5W. W.M.
Douglas County
Scale 1" = 400'

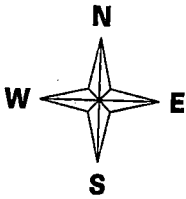
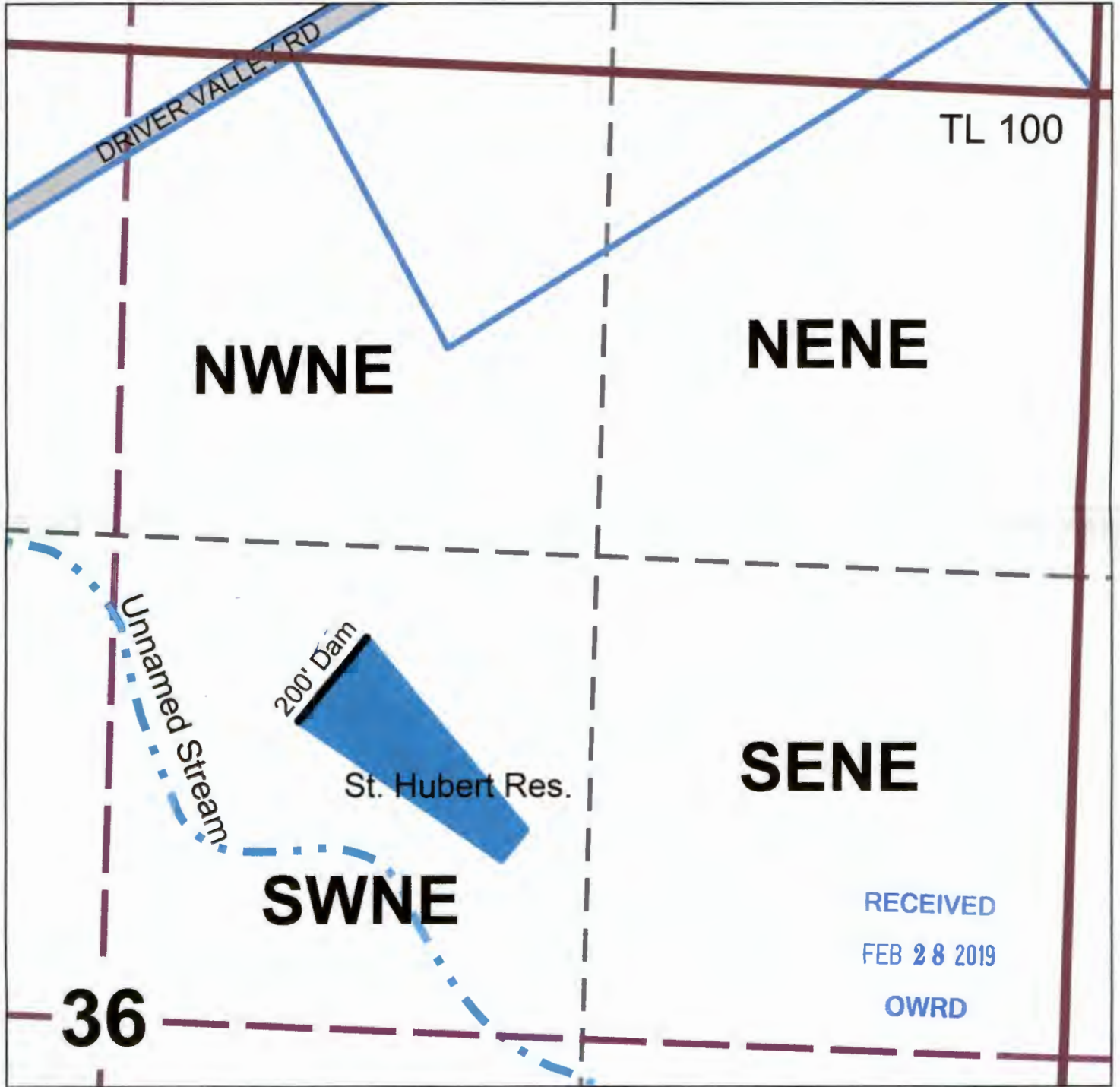

**Dam is located 1670 ft. South and 2040 ft. West from
the Northeast Quarter Corner of Section 36.**

R-88753