

RECEIVED

FEB 19 2020

OWRD

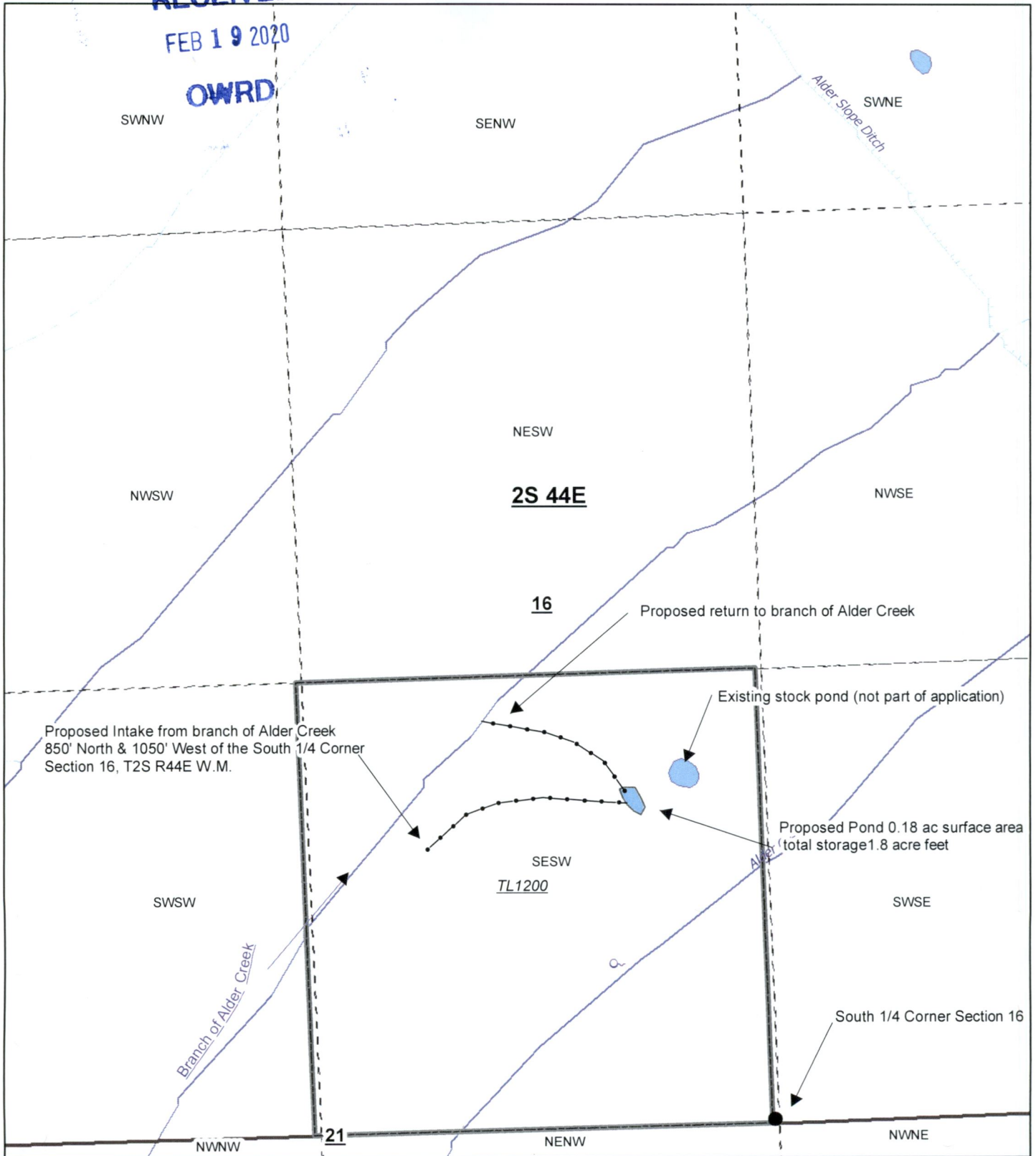

**Shaw Pond Storage Application Map - 2019**

Map Disclaimer:  
 This product is for informational purposes and may not have been prepared for, or be suitable for legal, engineering, or surveying purposes. Users of this information should review or consult the primary data and information sources to ascertain the usability of the information.  
 This map is not intended to display property lines.

Disclaimer: This listing is the result of a manual search of the records of the Watermaster's Plat Cards and the WRIS database. The listing has not been field checked. That a right is of record is no guarantee that it has not been abandoned under the conditions of ORS 540.610. The plat card records of listed by the 40.0 acre quarter-quarter within a section. If the water right listed within a quarter-quarter is on more than one tax lot, this office has not itemized that water rights for each tax lot - only a survey could accurately depict how much of the water rights are on each tax lot.

**Legend**

- TL\_1200 Point
- D7\_TWP FType
- D7\_SEC
- D7\_QQ
- SpringSeep
- Stream, perennial
- Stream, intermittent
- Canal
- Lake

Scale 1"=400'





**Shaw Pond Storage Application Map - 2019**

Map Disclaimer:  
 This product is for informational purposes and may not have been prepared for, or be suitable for legal, engineering, or surveying purposes. Users of this information should review or consult the primary data and information sources to ascertain the usability of the information.  
 This map is not intended to display property lines

Disclaimer: This listing is the result of a manual search of the records of the Watermaster and the WRIS database. The listing has not been field checked. That a right is of record and a right has not been abandoned under the conditions of ORS 540.610. The plat card records of listed by the 40 acre quarter-quarter within a section. If the water right listed within a quarter-quarter is on more than one tax lot, this office has not itemized that water rights for each tax lot - only a survey could accurately depict how much of the water rights are on each tax lot.

RECEIVED

FEB 10 2020

OWIP

**Legend**

- TL\_1200 Point
- D7\_TWP FType
- D7\_SEC
- D7\_QQ
- Spring/Seep
- Stream, perennial
- Stream, intermittent
- Canal
- Lake

Scale 1"=400'

