

Application No. 2314
 Permit No. 1151

Application No. 2313
 Reservoir Permit No. 185

OFFICE OF STATE ENGINEER
 DEPT. OF AGRICULTURE
 MAY 20 1914
 OREGON

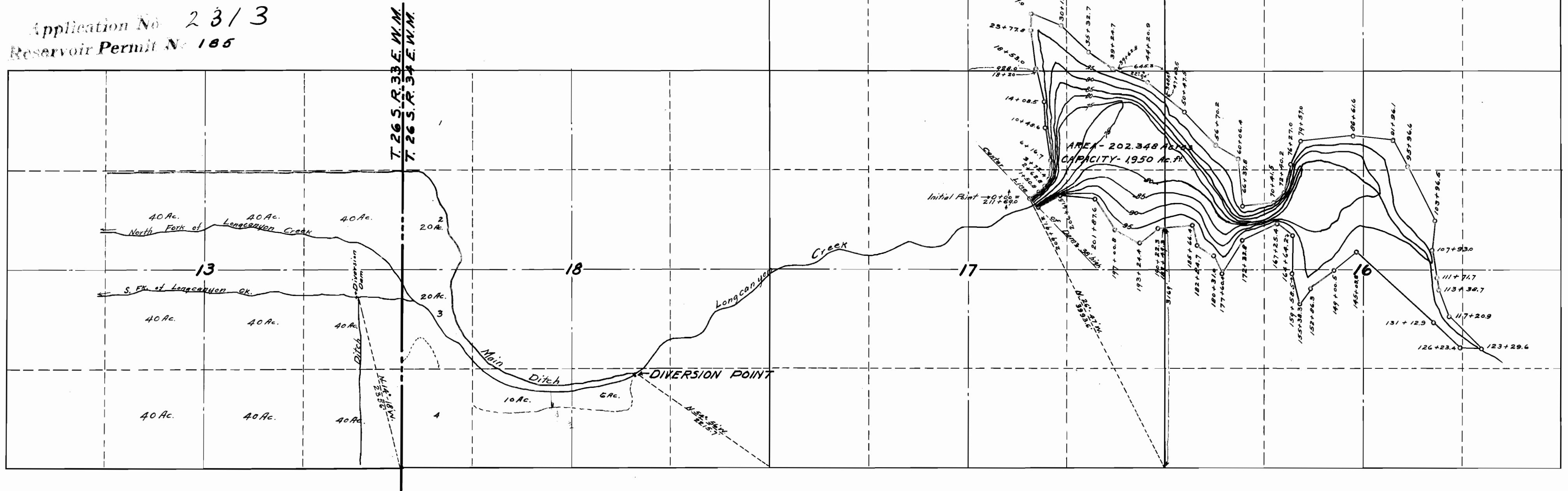

MAP
 of
ORON THOMPSON'S IRRIGATION SYSTEM
 IN HARNEY COUNTY, OREGON.

Scale - 1" = 1000'

CERTIFICATE OF SURVEYOR.

I, A. O. Faulkner, of Burns, Oregon, do hereby certify that this map was made from notes taken during an actual survey made by me on the 7th to 10th of May, 1912, and that it correctly represents the works described in the accompanying application, together with the location of streams and other ditches in the immediate vicinity, and has written thereon the area in each smallest legal subdivision which it is proposed to irrigate.

A. O. Faulkner,
 Surveyor

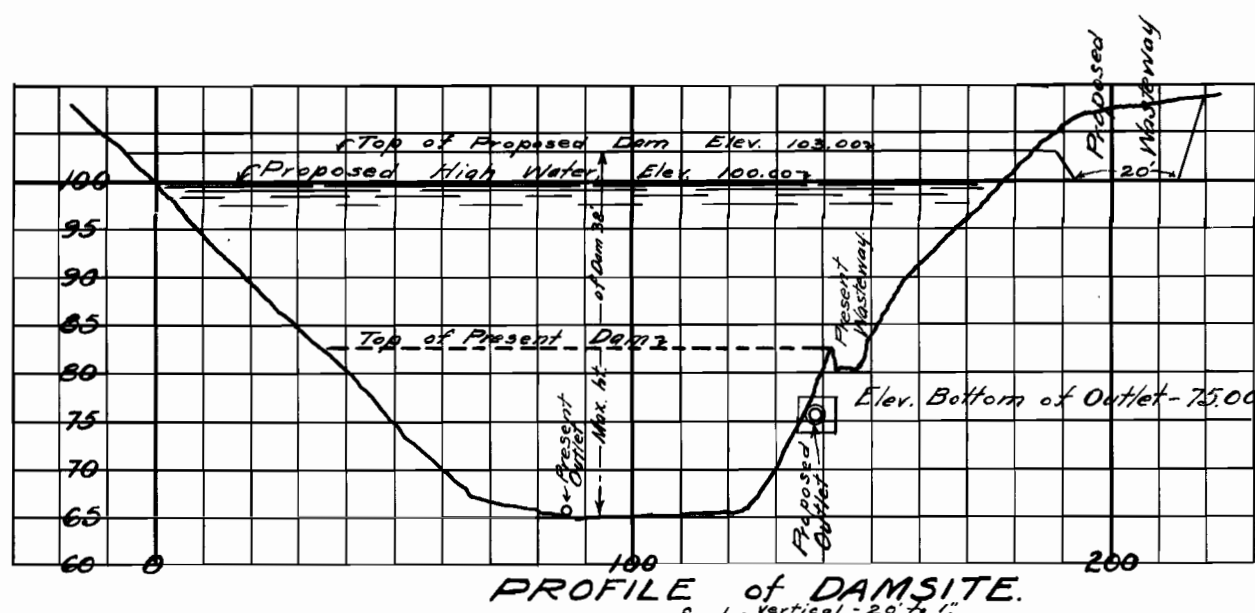

PROFILE of DAMSITE.
 Scale: Vertical - 20 ft. = 1 in.; Horizontal - 100 ft. = 1 in.

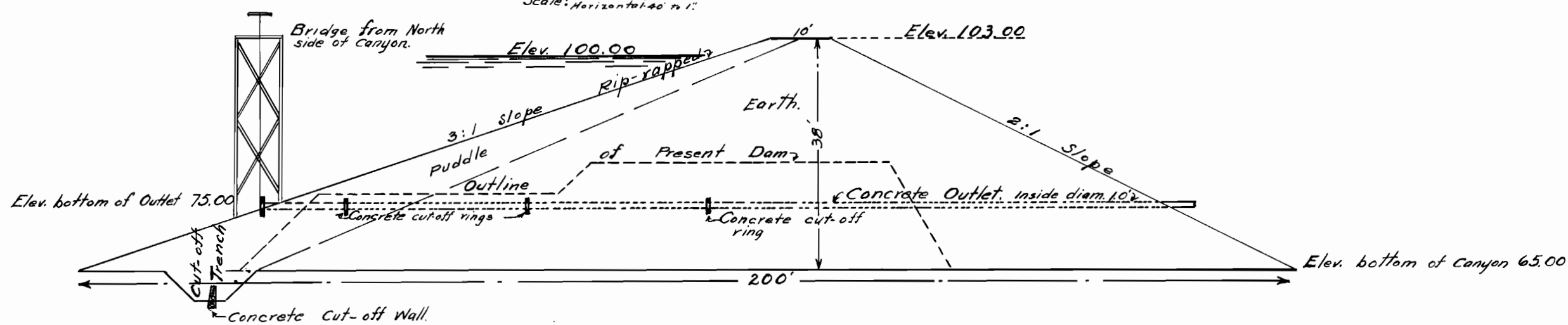

CROSS-SECTION OF DAM.
 Scale: 1" = 20'