

Map to accompany the application of Keith Remer of Lakeview Oregon to appropriate water from Dry Creek and Remer Reservoir for irrigation purposes. Located in Sections 13, 14, 15, 16, 17, 18, 19, 20, 21, 22, 23, 24, 25, 26, 27, 28, 29, 30, 31, 32, 33, 34, 35, 36, 37, 38, 39, 40, 41, 42, 43, 44, 45, 46, 47, 48, 49, 50, 51, 52, 53, 54, 55, 56, 57, 58, 59, 60, 61, 62, 63, 64, 65, 66, 67, 68, 69, 70, 71, 72, 73, 74, 75, 76, 77, 78, 79, 80, 81, 82, 83, 84, 85, 86, 87, 88, 89, 90, 91, 92, 93, 94, 95, 96, 97, 98, 99, 100. T415 R19E-N14E Lake County Oregon.

I, Glenn E. Tyler of Lakeview Oregon do hereby certify that the foregoing map was prepared from field notes taken during an actual survey made by me on April 24 - 29 1926. The point of proposed diversion being at the S. corner of the West Side of section 13 T415 R19E-N14E. Said year being reference of by an iron pipe of a point 25' north of said S. corner.

The accompanying details are showing from survey and elevations of field lines and structures and representation of existing conditions and structures and proposed point as made by me Remer for said year.

Glenn E. Tyler
County Surveyor
Lake County Oregon

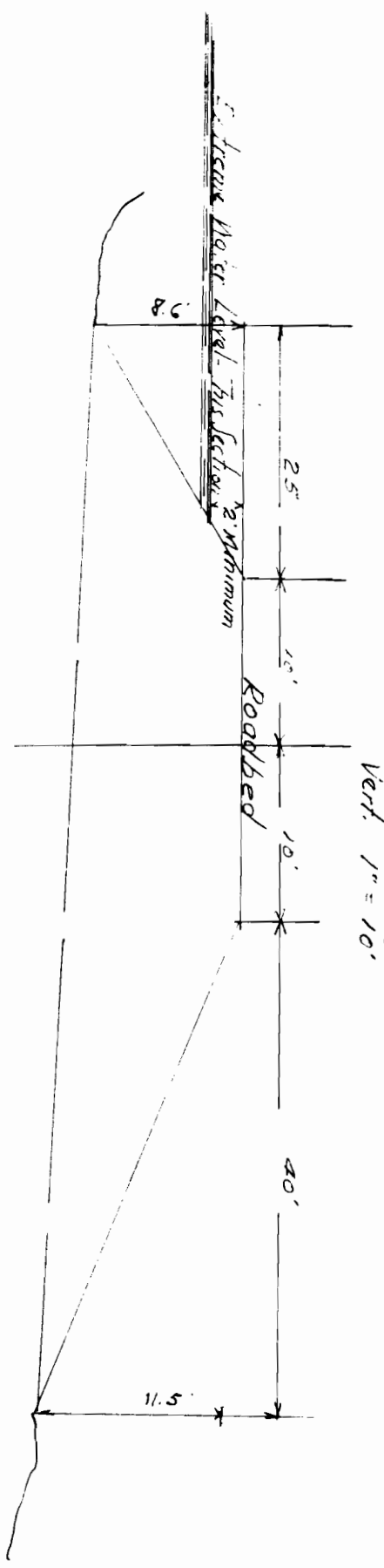
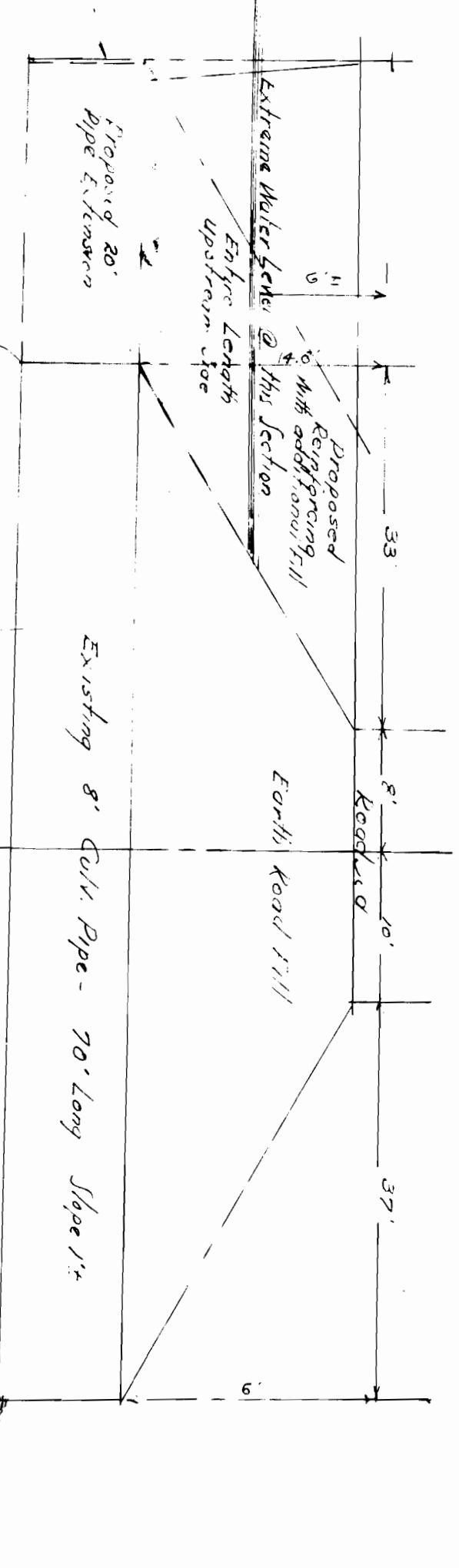
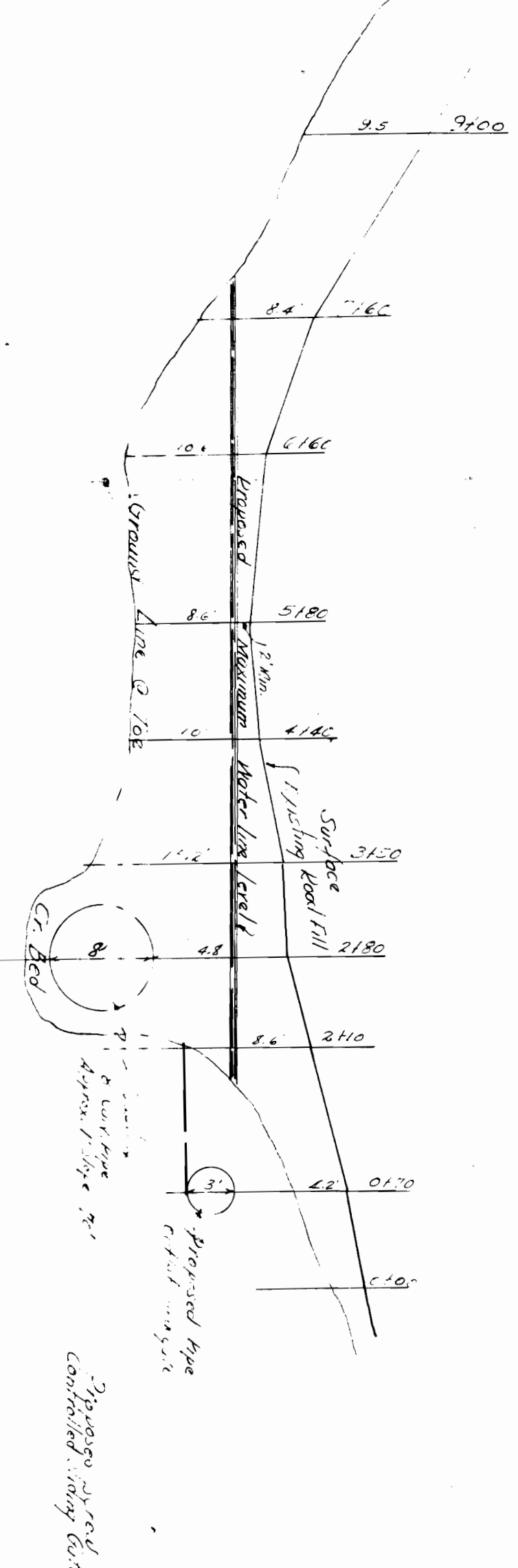
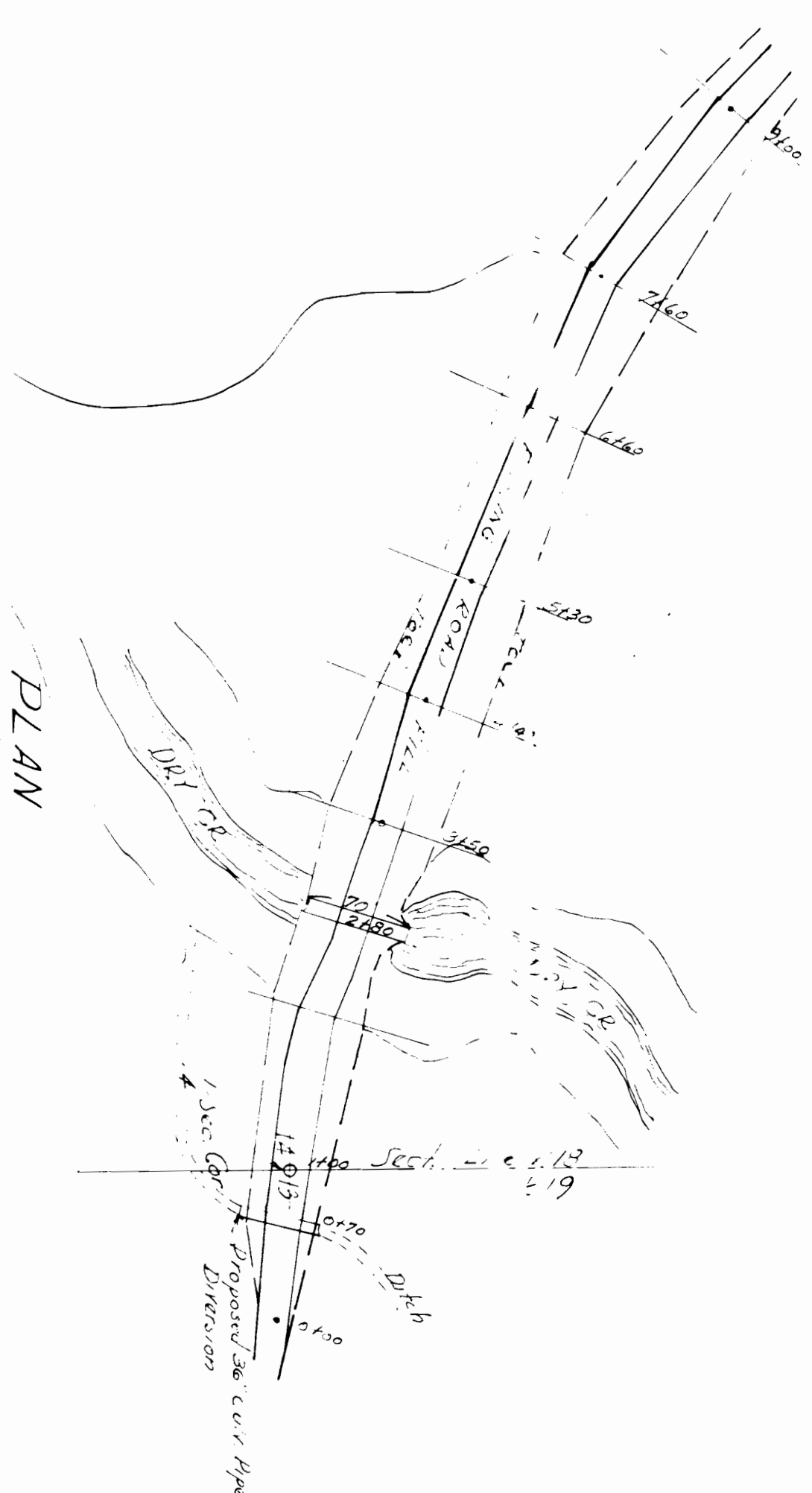

DETAIL PLANS AS PROVIDED BY MR. REMER FOR DRAIN EXISTING NEAR FIELD AS INDICATED DIVERSION FROM DRAIN DRAINAGE FROM FIELD INTO AND THROUGH DAM APRIL 25 1926
Glenn E. Tyler County Surveyor

CROSS SECTION @ 5130
Scale: Hor. 1"=10' Vert. 1"=10'