

FERRY CREEK RESEVOIR.

C & O LUMBER CO.
CURRY CO.,
OREGON.

CERTIFICATE OF SURVEYOR.

I, W. J. Ward, of Brookings, Ore. do hereby certify that this map was made from notes taken during an actual survey made by me in August 1913, and that it correctly represents the works described in the accompanying application, together with the location of streams and ditches in the immediate vicinity, and has written thereon the area in each smallest legal subdivision which it is proposed to irrigate.

W. J. Ward
Surveyor.

POINT OF DIVERSION

4023 ft, N 1° 15' 20" W of $\frac{1}{4}$ Sec. Cor. between Sec. 32, Tp. 40 S, R 13 W and Sec. 5, Tp 41 S, R 13 W, being within the N.E. $\frac{1}{4}$, N.W. $\frac{1}{4}$ of Sec. 32, Tp 40 S, R 13 W, Willamette Base and Meridian, Curry Co., Oregon.

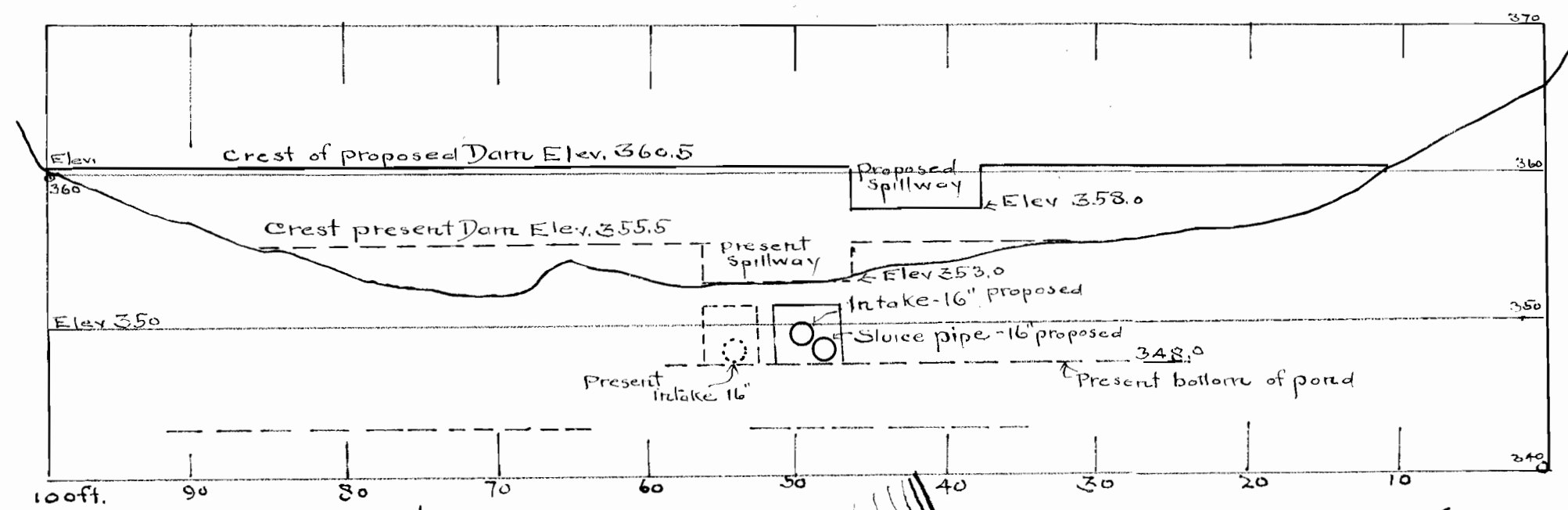
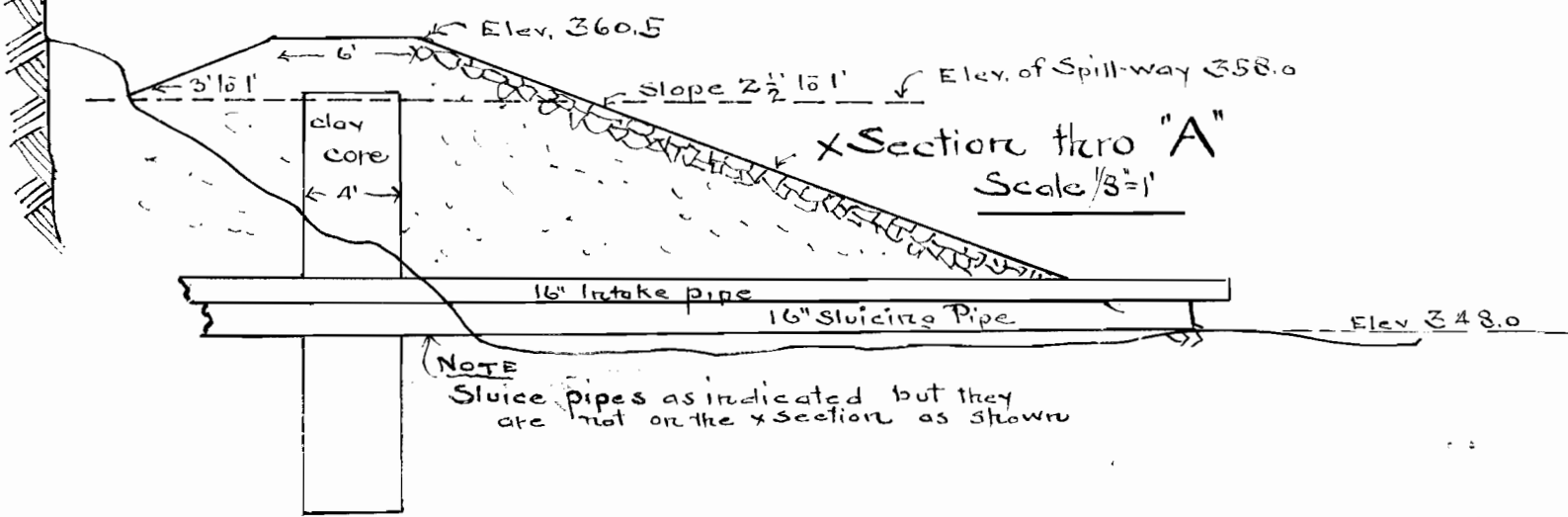

Scale 1" = 10'

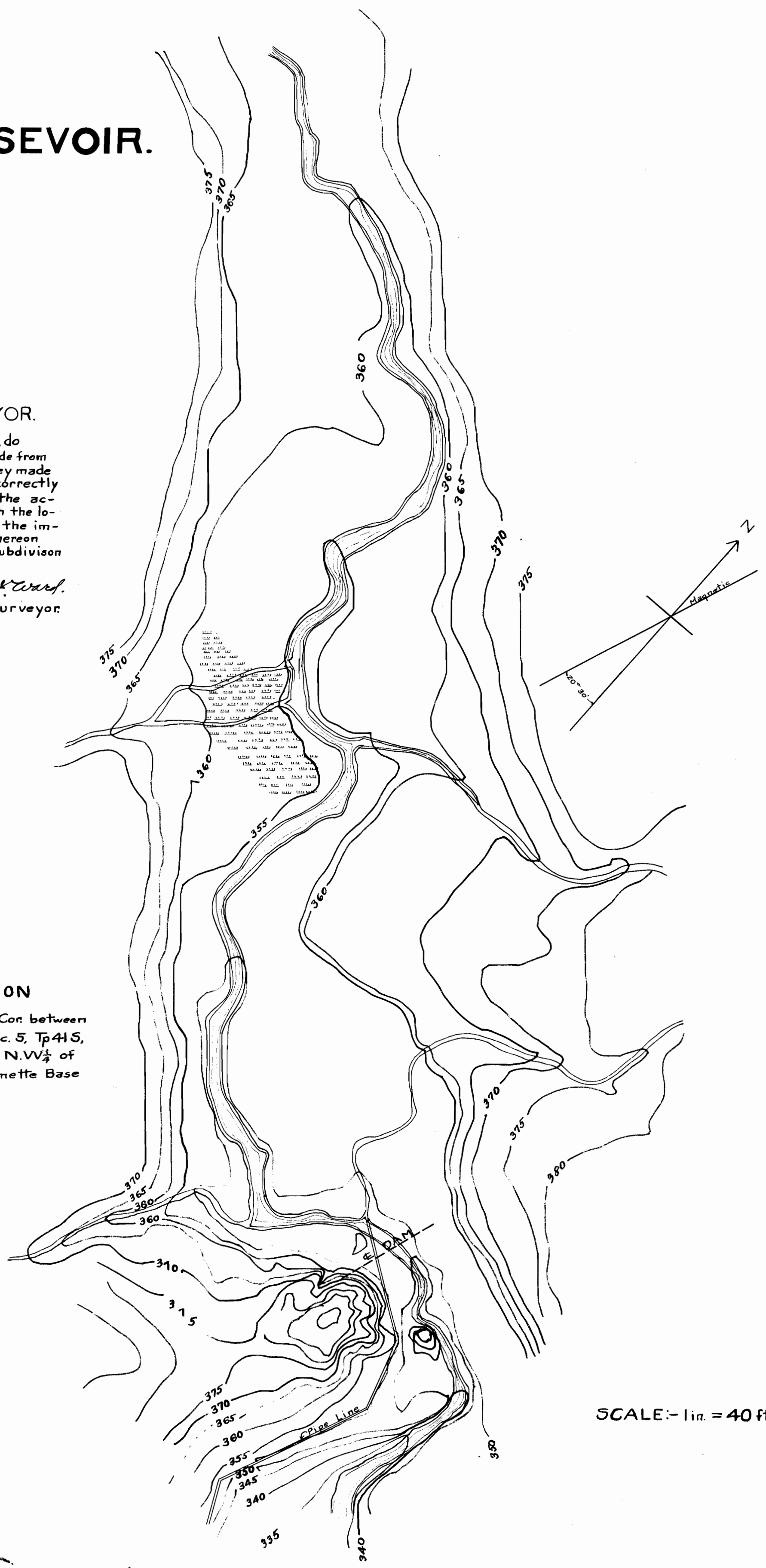
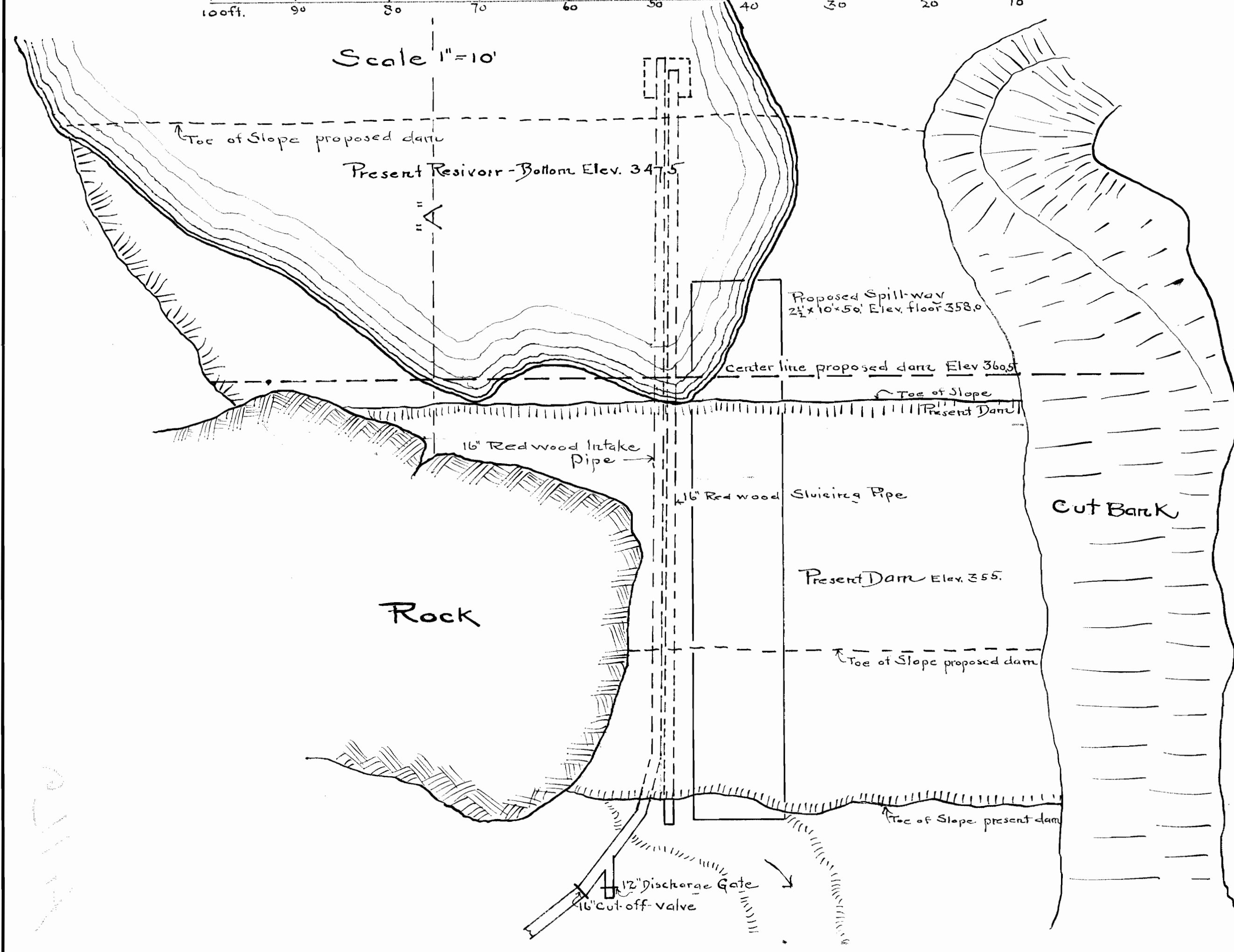

SCALE: 1 in. = 40 ft

5114
R 372

T. 7010