

OFFICE OF STATE ENGINEER

RECEIVED

OCT 9 1919

SALEM, OREGON

Township 12 S Range 21 E

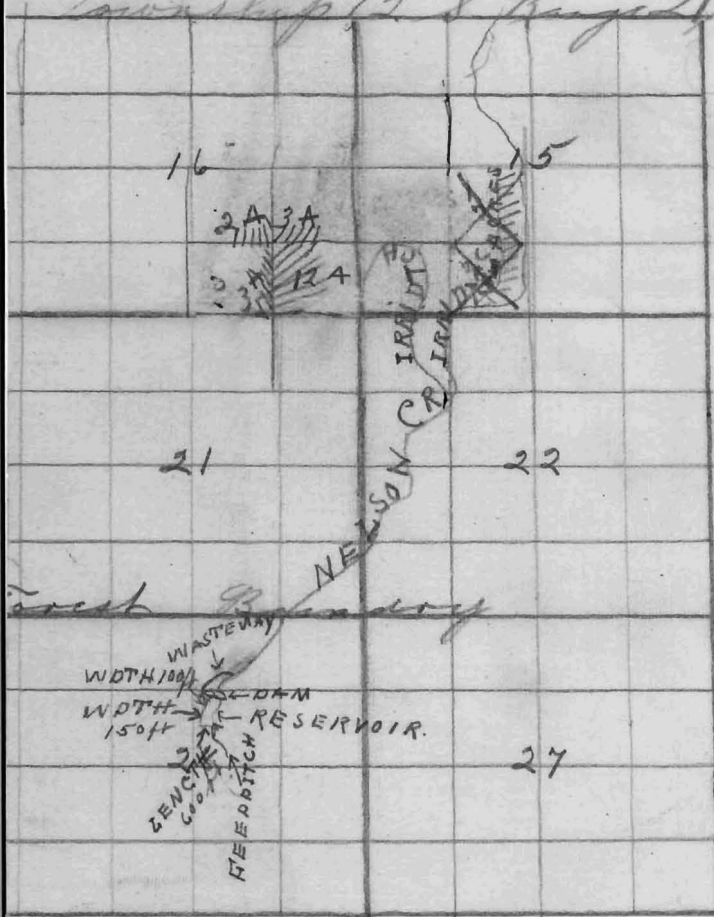

Land to be irrigated

Drawn by G. W. Nelson  
Oct 4, 1919.

Scale 2 IN = 1 MI

Application No. 6805  
Reservoir Permit No. 462



I G. W. Nelson of Mitchell Or. do hereby certify that this map was made from notes taken during an actual survey made by me on Oct 4 1919 & that it correctly represents the works described in the application

G. W. Nelson Surveyor