

Location Map - for - N. B. Wright Reservoir  
and Irrigated lands

 Showing Area To be Irrigated  
9.0 Acres

Scale: 1" = 400' N  
Oct 10 1965  
Josephine Co. Oregon

T.  
36  
S

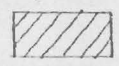
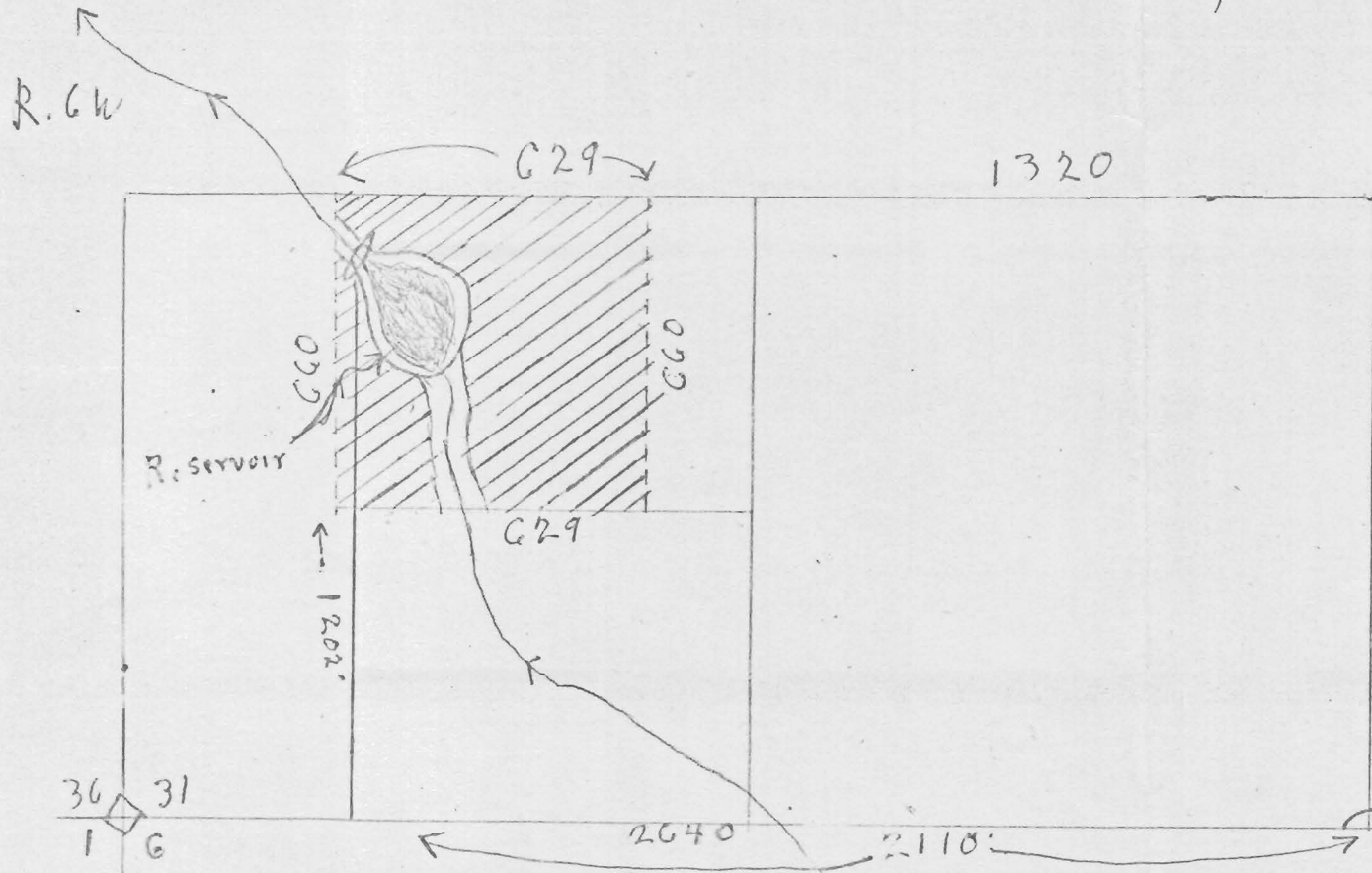

**RECEIVED**  
OCT 26 1965  
STATE ENGINEER  
SALEM OREGON

South Sec 31  
1/4 cor.

Application No. R-41554  
41555  
Permit No. R-4679  
30997

T.  
37  
S.