

Permit: R 5413
 Volume: 5
 Strm: UNN STR
 Trib: QUARTZ CR
 Priority: 1/15/69

RECEIVED
 DEC 13 1974

WM. DIST. 14
 GRANTS PASS, ORE

T.35S.R.6W.W.M.

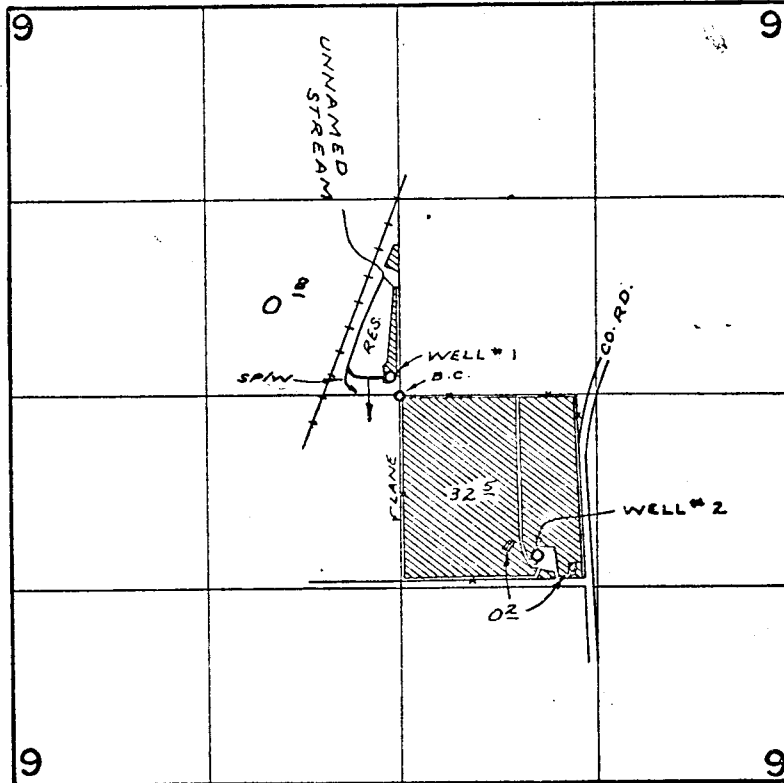

DIV. PTS LOC: WELL #1 - 120' N. & 70' W.; WELL #2 - 1100' S. & 930' E.
 STREAM - 120' N. & 220' W, ALL FROM GEN. SEC. 9
 WELL #1 & RES → [diagonal hatching] WELL #2 → [diagonal hatching]

FINAL PROOF SURVEY
 UNDER

R-44177 R-5104
 44178 33008
 R-45707 R-5413
 45708 34095

Application No. G-~~4269~~ Permit No. G-~~2488~~
 IN NAME OF

BUREAU OF LAND MANAGEMENT

Surveyed APR. 17, 1972, by R. MUCKEN