

SECTION 18 T3S R5W W.M.

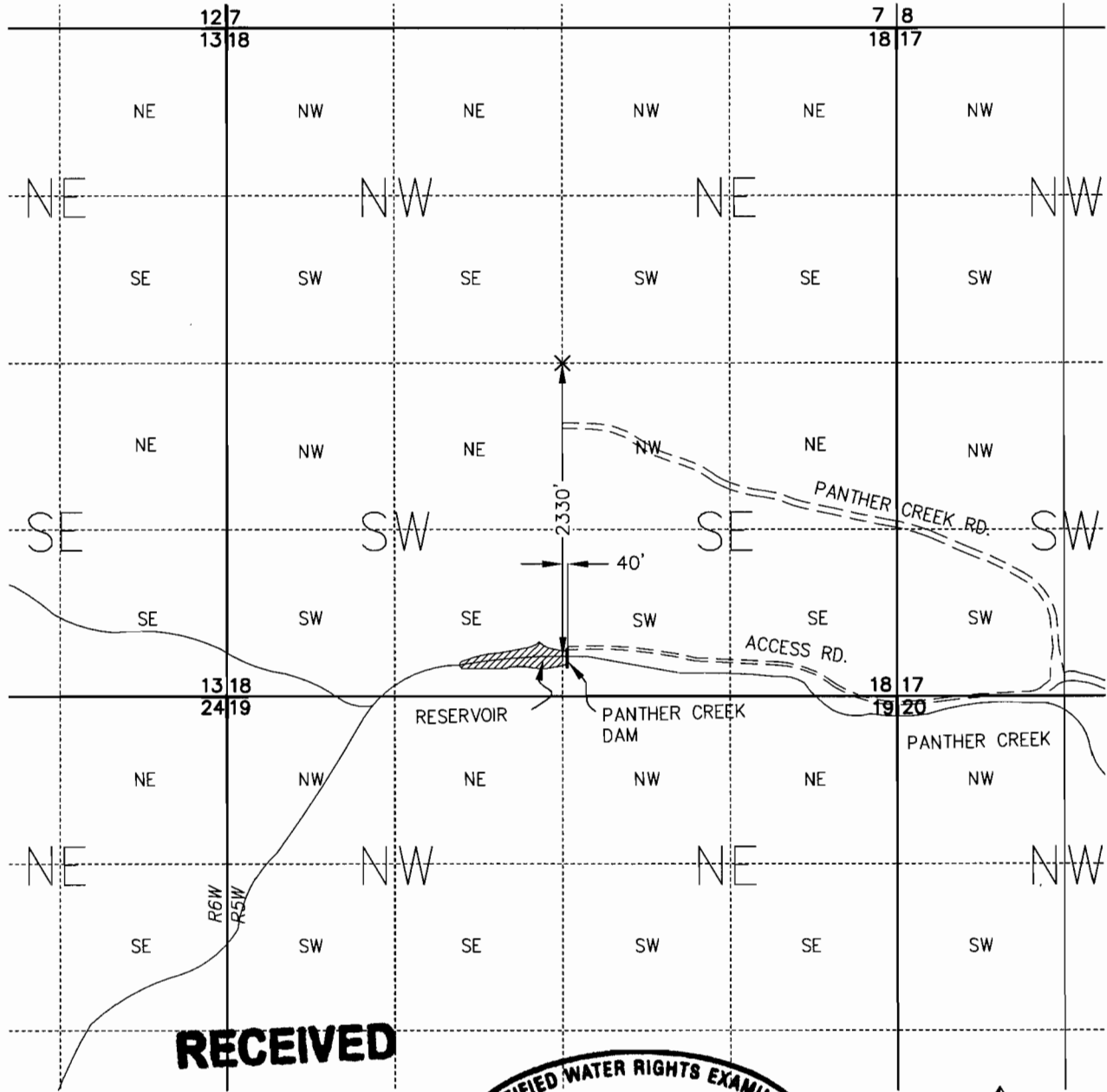

**RECEIVED**

DEC 21 2004

WATER RESOURCES DEPT  
SALEM, OREGON

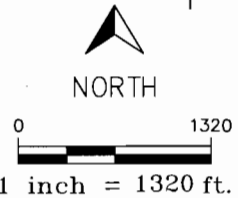
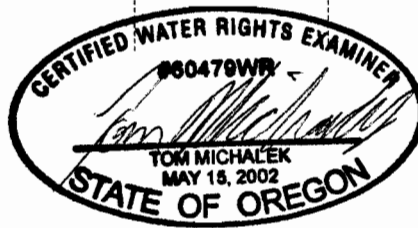

POINT OF DIVERSION: PANTHER CREEK DAM, LOCATED  
40' E AND 2330' S FROM THE CENTER OF SECTION 18.

THE PREPARATION OF THIS MAP WAS FOR  
THE PURPOSE OF IDENTIFYING THE LOCATION  
OF THE WATER RIGHTS AND HAS NO INTENT  
TO PROVIDE DIMENSIONS OR LOCATIONS OF  
PROPERTY OWNERSHIP LINES.

PREPARED FOR:

CITY OF CARLTON  
P.O. BOX 452  
CARLTON, OREGON 97111



Planners  
Engineers  
Surveyors

20085 N.W. TANASBOURNE OR.  
HILLSBORO, OREGON 97124  
PHONE: (503) 858-4242  
FAX: (503) 645-5500  
www.ldcdesign.com

DRAWING TITLE:

CLAIM OF BENEFICIAL USE MAP  
APPL. R-46504  
PERMIT R-5527  
CITY OF CARLTON

KMH

JOB NO.:

0037.002

DRAWING NO.:

1 OF 1