

Plat showing
 location of
 Proposed Reservoir
 and
 New Roadway
 for
 Ashland, Oregon.
 (The clearing of which
 is to be done by contract)

Scale approximately
 1" = 300'

April 1927

T. 39 S. R. 1 E. F. H. Walker
 City Engr

SE. 1/4 of SE. 1/4 of SE. 1/4
 Sec 20

SW. 1/4 of SW. 1/4 of SW. 1/4
 Sec 21.

Govt. Lot #1
 City of Ashland
 Deed Vol. 55 p. 230
 Apr. 1906 - Jackson County
 Records

Certificate of Surveyor.

I, F. H. Walker - City Engineer of Ashland, Oregon do hereby
 certify that this map was made from notes taken during an
 actual survey made under my immediate supervision
 during March 1927, and that it correctly represents the works
 described in the accompanying application, together with
 the location of streams in the immediate vicinity, and

F. H. Walker
 City Engineer
 Cert. No. 652

Application No 11489
 Permit No. 7984

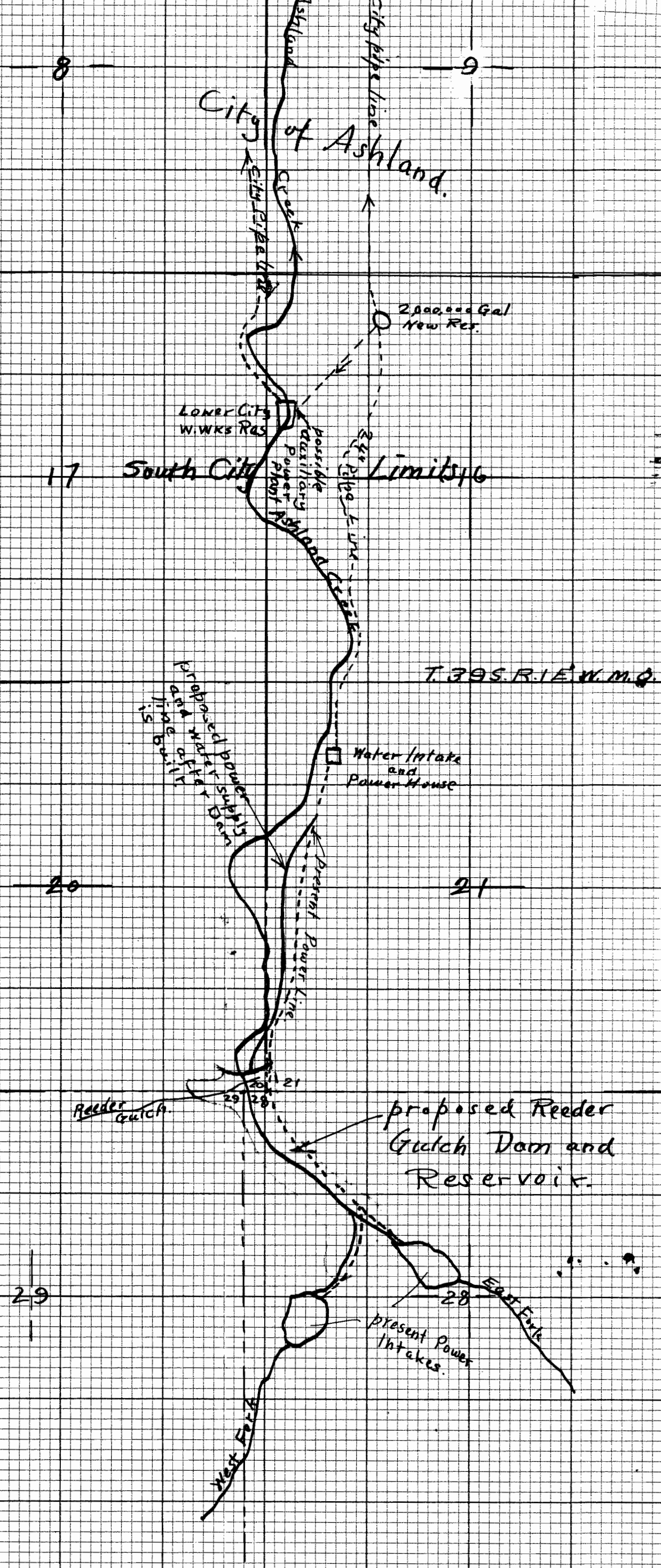

Plat showing
 General Location from Ashland
 to proposed Reeder Gulch Reservoir,
 showing present and proposed
 arrangement of pipe lines for
 Water Supply and Power Uses
 May 1921

Application No. 11484
 Permit No. 7984
 Application No. 11518
 Permit No. 7385

T. H. Walker
 City Engr

Post #652