

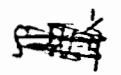

1" = 400'

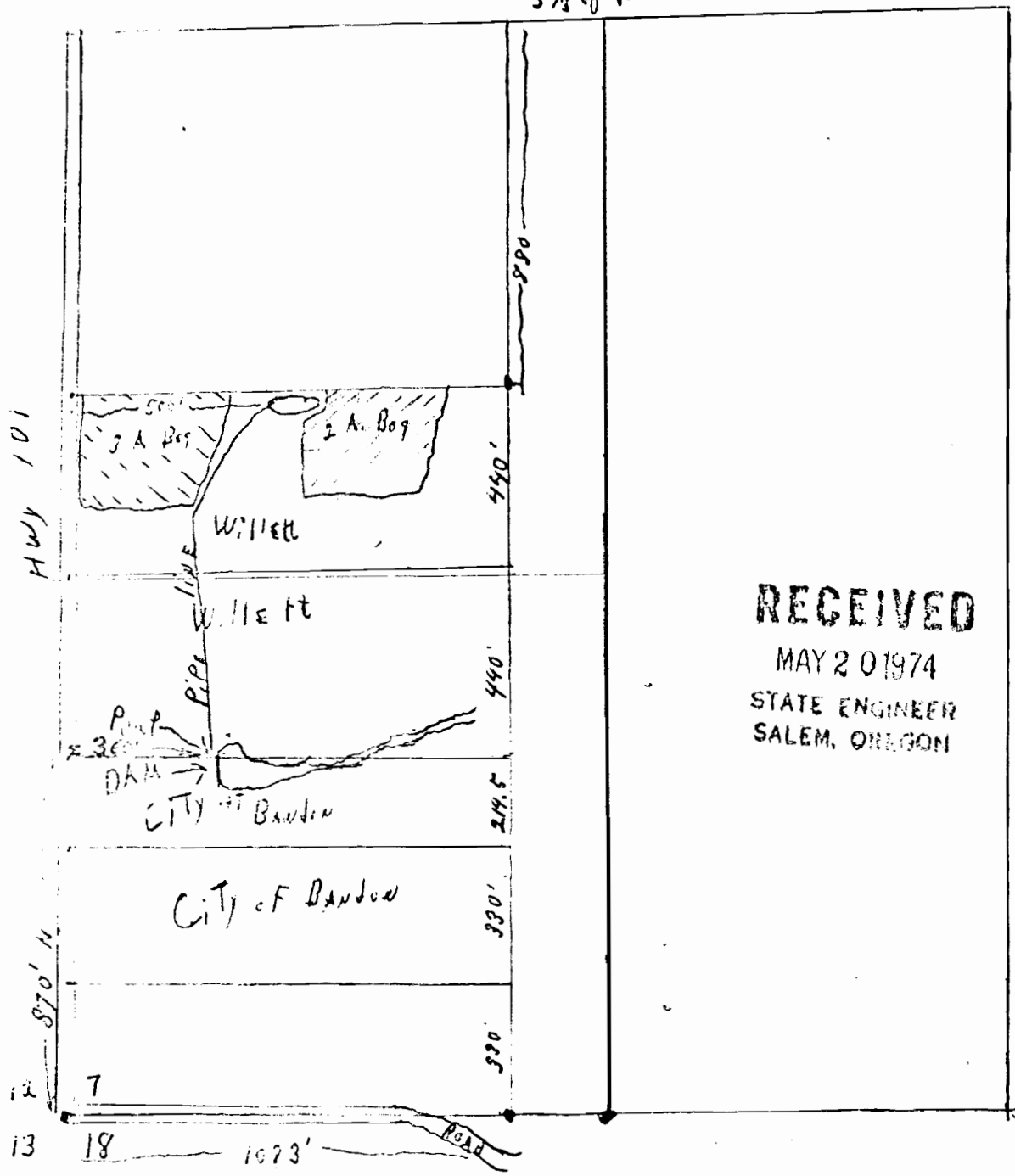

Willett Property Located in Section 7, Twp 29 SR WMM  
5/3 of Lot 3 and 1/2 of Lot 4

NEW ROY SHADED

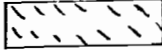

-  Appl. No 51964
-  Appl. No 51605

**RECEIVED**  
MAY 20 1974  
STATE ENGINEER  
SALEM, OREGON

**RECEIVED**  
AUG 16 1974  
STATE ENGINEER  
SALEM, OREGON

Application No. 51964, R-52034, & 51605  
Permit No.