

T.9S. R.1E. W.M.
Scale: 1"=100'

4 TRACT

N.W. Corner
ALF FITZGERALD
D.L.C. NO. 57

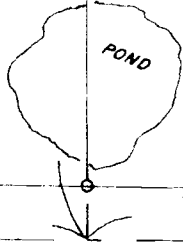

30.30'

PC 44+38.65

M.C.M.

603.82'

454.35'

$\Delta = 39^{\circ} 06' 35''$
 $R.D. = 89'$

216.95'
N 00° 21' E

IP

PC 49+59.08

M.C.M.

M.C.M.

PT 49+27.52

1481.34'
N 00° 21' E

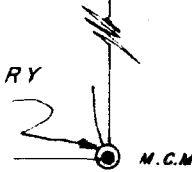

Application No. R-52340
Permit No. R 6301

RECEIVED
SEP 27 1974
STATE ENGINEER
SALEM OREGON

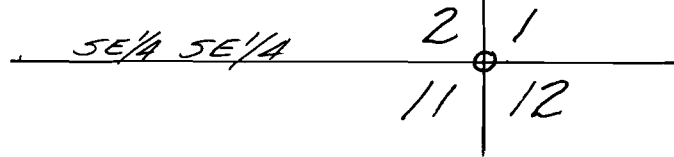

SE. Cor. J. PERRY
D.L.C. NO. 56

RECEIVED
PERMIT NO. 6301
LAND DIVISION

David L. Harbo
DAVID L. HARBO
785