

SECTION

35 } 37 S.
36 }

1 } 38 S.
2 }

TOWNSHIP 37 S., RANGE 3 W., W. M.
38 S. 3 W.

North

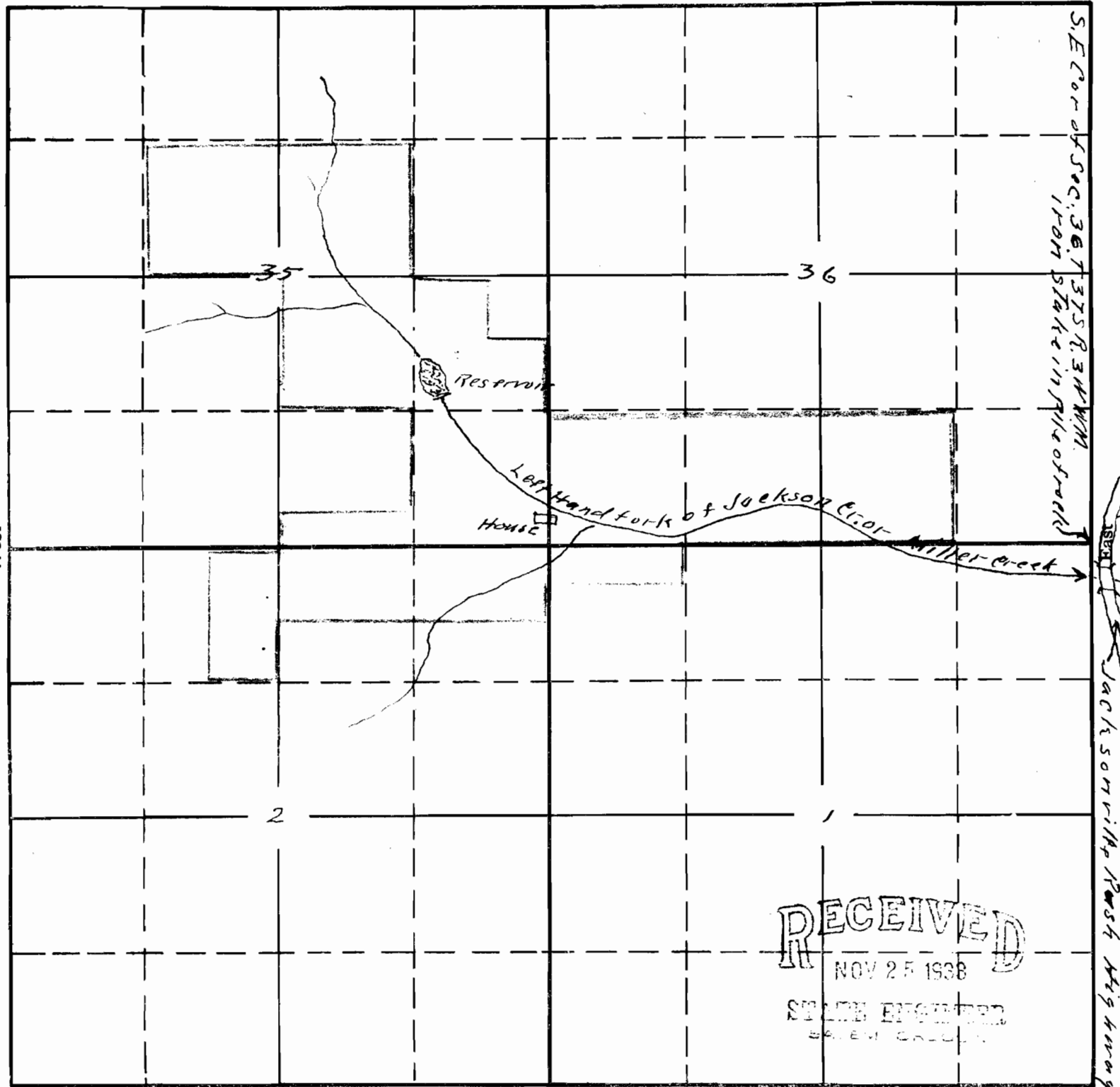

RECEIVED
 NOV 25 1938
 STATE ENGINEER
 SALT LAKE CITY

South

Map to accompany application of
 J.C. Brewer for Reservoir.
 Made from map made by J.C. Brewer,
 by actual survey
 - Inclosed Lands of J.C. Brewer

APPLICATION No. 15205
 PERMIT No. R-670