

Application No. 57032, R 57031
 Permit No. 43053, R 7254
 T. 40S. R. 2W. W. M.

HASKIN DITCH DIV. IS LOCATED 283' N. AND 1154' W. FROM THE SE COR. OF SEC. 31, T. 40S. R. 2W. W. M. BEING WITHIN THE SE 1/4 SE 1/4 OF SEC. 31.

RES. #1 IS LOCATED 800'S. AND 210'E. FROM THE W 1/4 COR. OF SEC. 6 BEING WITHIN THE NW 1/4 SW 1/4 (GOV'T. LOT 6) OF SEC. 6, T. 41S. R. 2W. W. M.

SLICKTAW DITCH DIV. IS LOCATED 840' N. AND 1530' E. FROM THE W 1/4 COR. OF SEC. 6, BEING WITHIN THE SW 1/4 NW 1/4 SEC. 6, T. 41S. R. 2W. W. M.

RES. #2 IS LOCATED 650' N. AND 1700' E. FROM THE W 1/4 COR. OF SEC. 6, BEING WITHIN THE SW 1/4 NW 1/4 (GOV'T. LOT 5) OF SEC. 6, T. 41S. R. 2W. W. M.

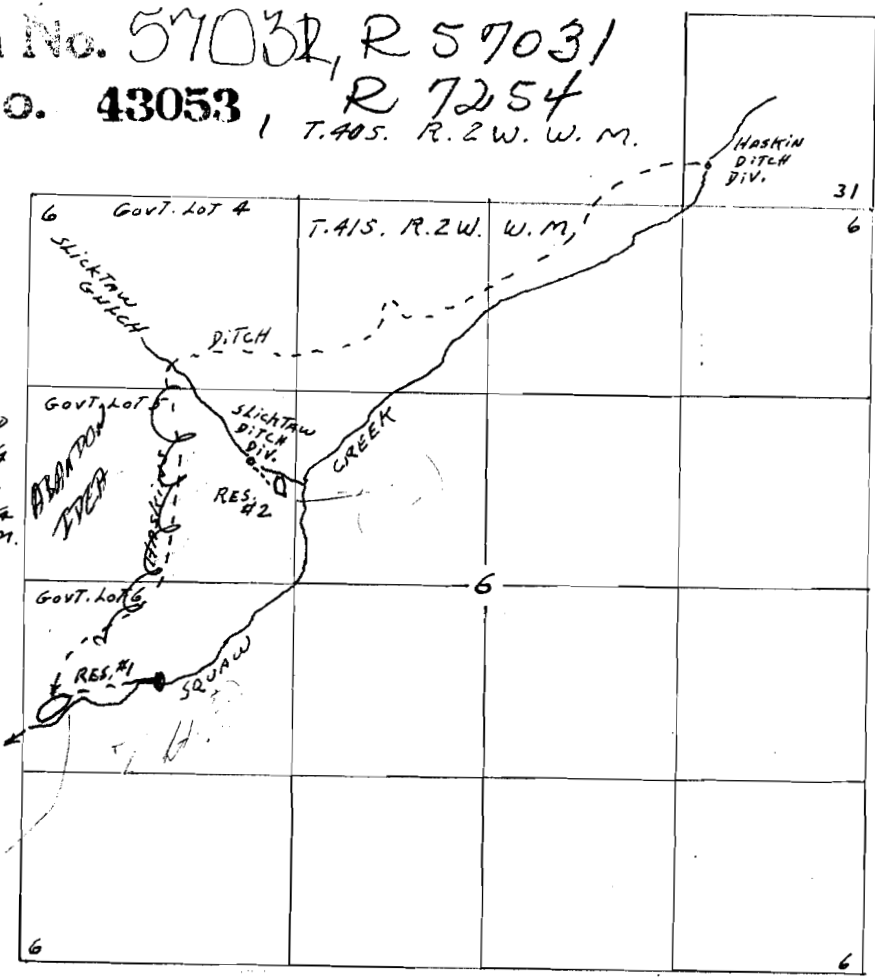

MAP TO ACCOMPANY APPLICATION OF A.C. PIERCE FOR FISH CULTURE IN THE HASKIN AND SLICKTAW DITCHES AND RESERVOIRS #1 AND #2

THIS MAP FORWARDED BY:
John E. Cummings

SCALE 4" = 1 MILE



1-30-78

WATER RESOURCES DEPT
 TALEM, OREGON