

78

TOWNSHIP 65, RANGE 1W, W. M.

North

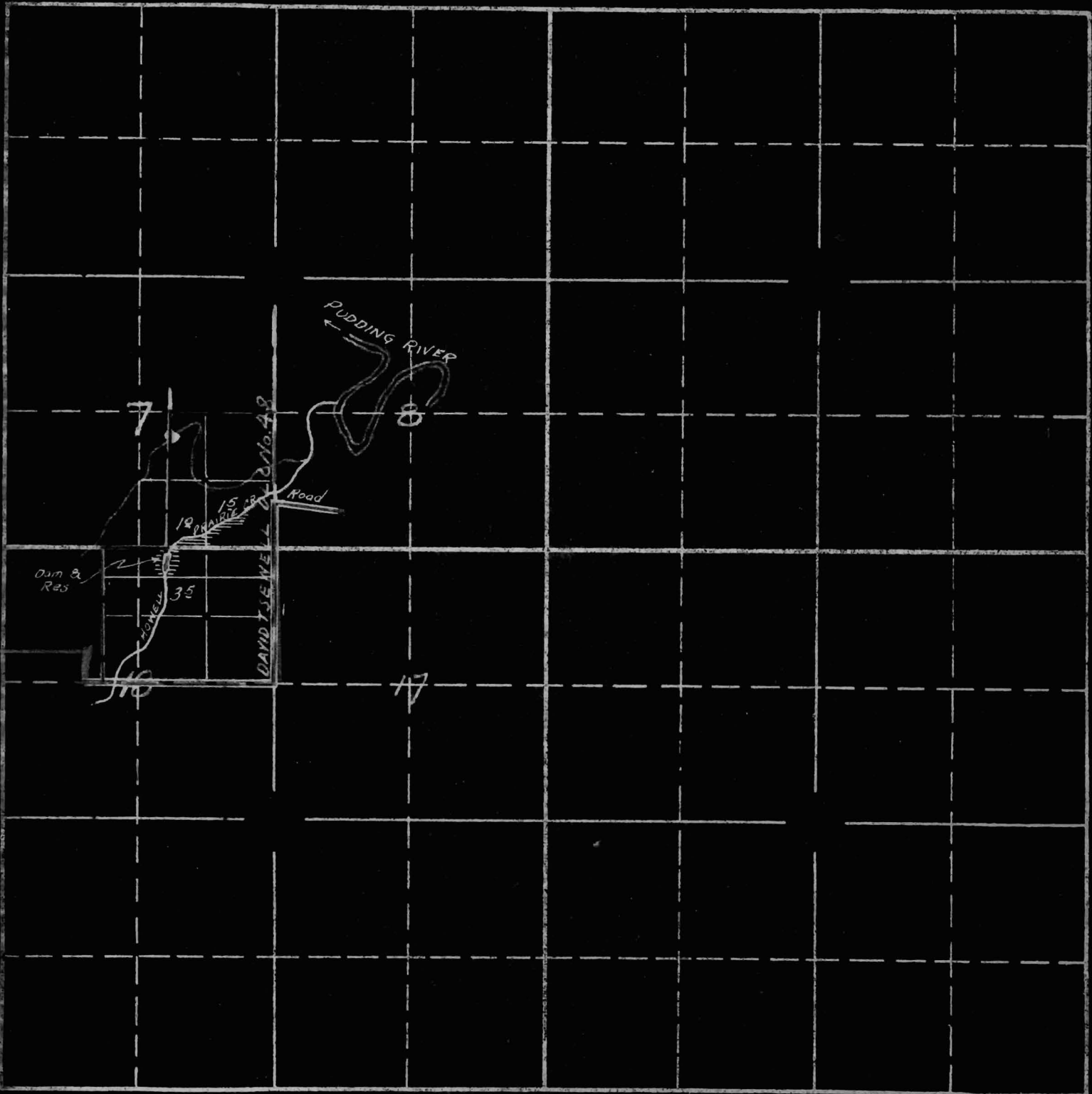

South

This sketch prepared in office  
 of State Engineer from <sup>Map</sup>sketchers  
 Map and information submitted  
 by applicant

7/20/41

App R-19418 and  
 19419

19419 or 19419  
 2-230  
 APPLICATION No. 19418  
 PERMIT No.

14967  
 R-765