

T. 29 S. R. 4 W. S. 23

14 13
23 24

Application No. R 57393
Permit No. 43476 R 7702

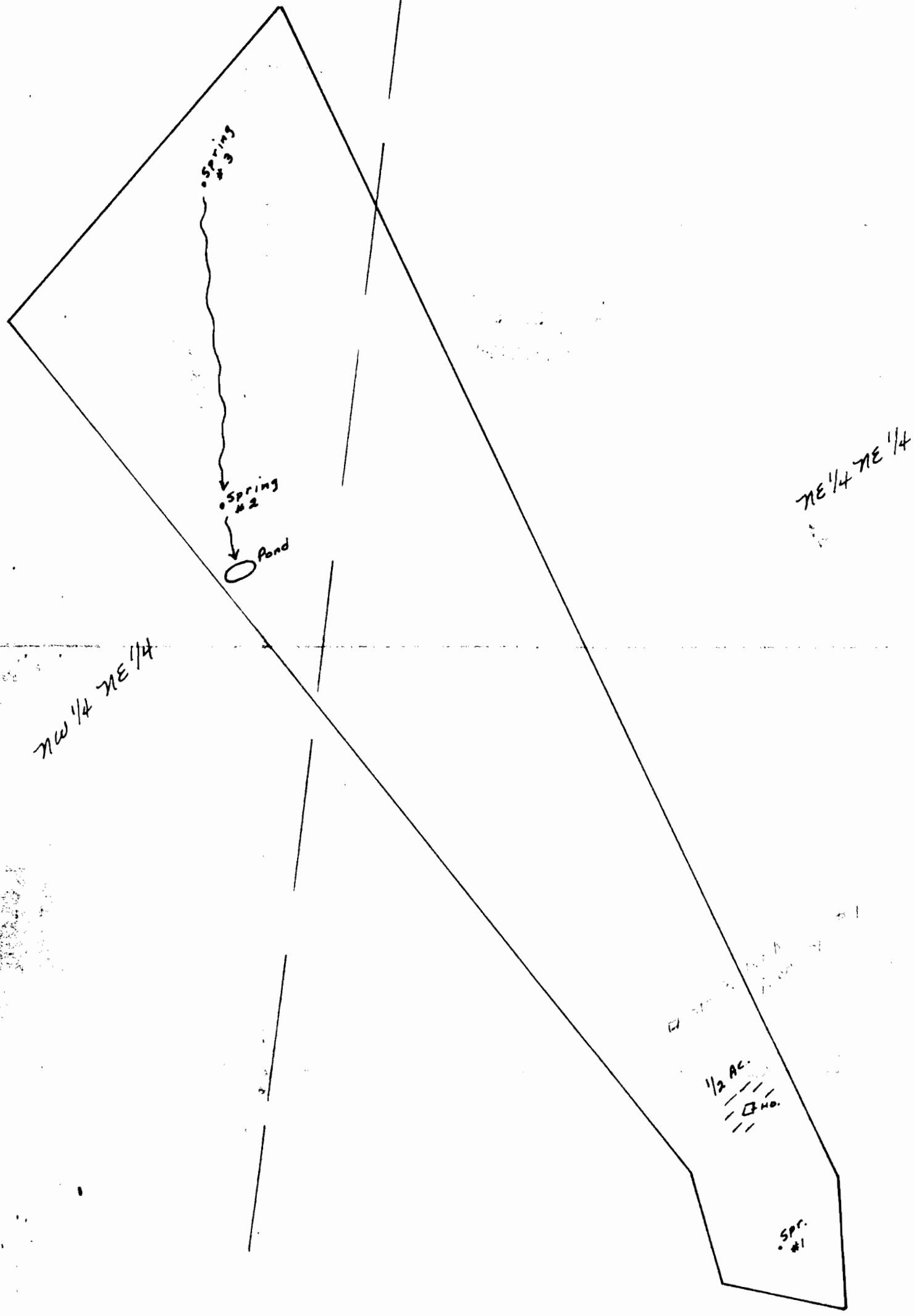

Spring #1 - 870'w, 1095's
 #2 - 1410'w, 460's
 #3 - 1465'w, 190's

Reservoir - 1410'w, 510's.
 all from NE Cor. S. 23.

