

SECTION

\_\_\_\_\_  
\_\_\_\_\_  
4  
\_\_\_\_\_

6  
TOWNSHIP 38 S, RANGE 4 W, W. M.

North

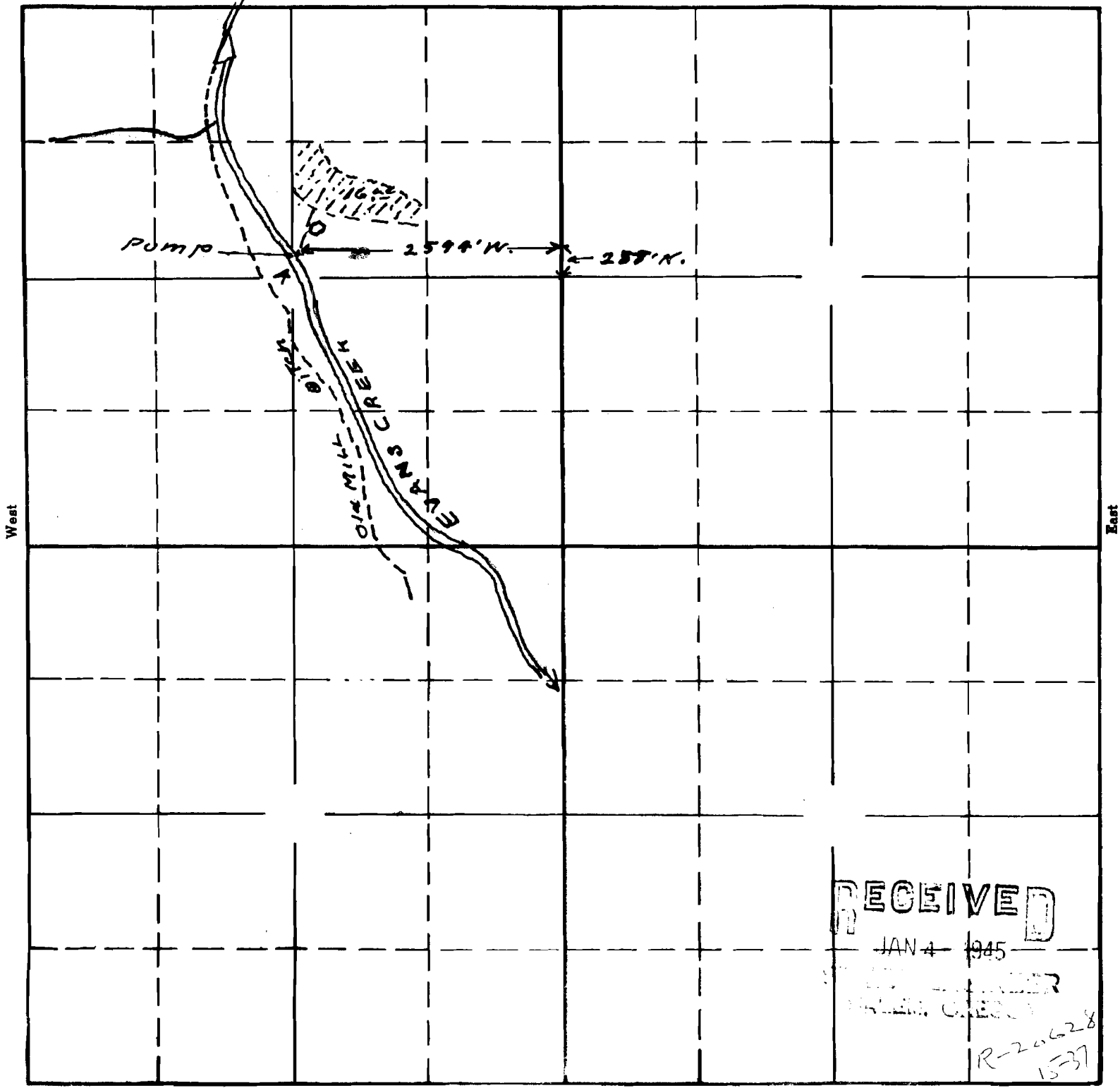

RECEIVED

JAN 4 1945

STATE ENGINEER  
WATER CREEK

R-20628  
15-31

South

Map To accompany application of  
Say Porter for use of waters of Evans Creek  
for irrigation purposes

APPLICATION No. R-20628  
PERMIT No. R-809

Map made from State Engrs. Survey  
June 24-26 1936

This office 12/28/44 photo