

RECEIVED

MAY 27 1981

WATER RESOURCES DEPT
SALEM, OREGON

T29S R14W
Sec 8
NW 1/4 NW 1/4

RECEIVED

JUL 28 1980

WATER RESOURCES DEPT
SALEM, OREGON

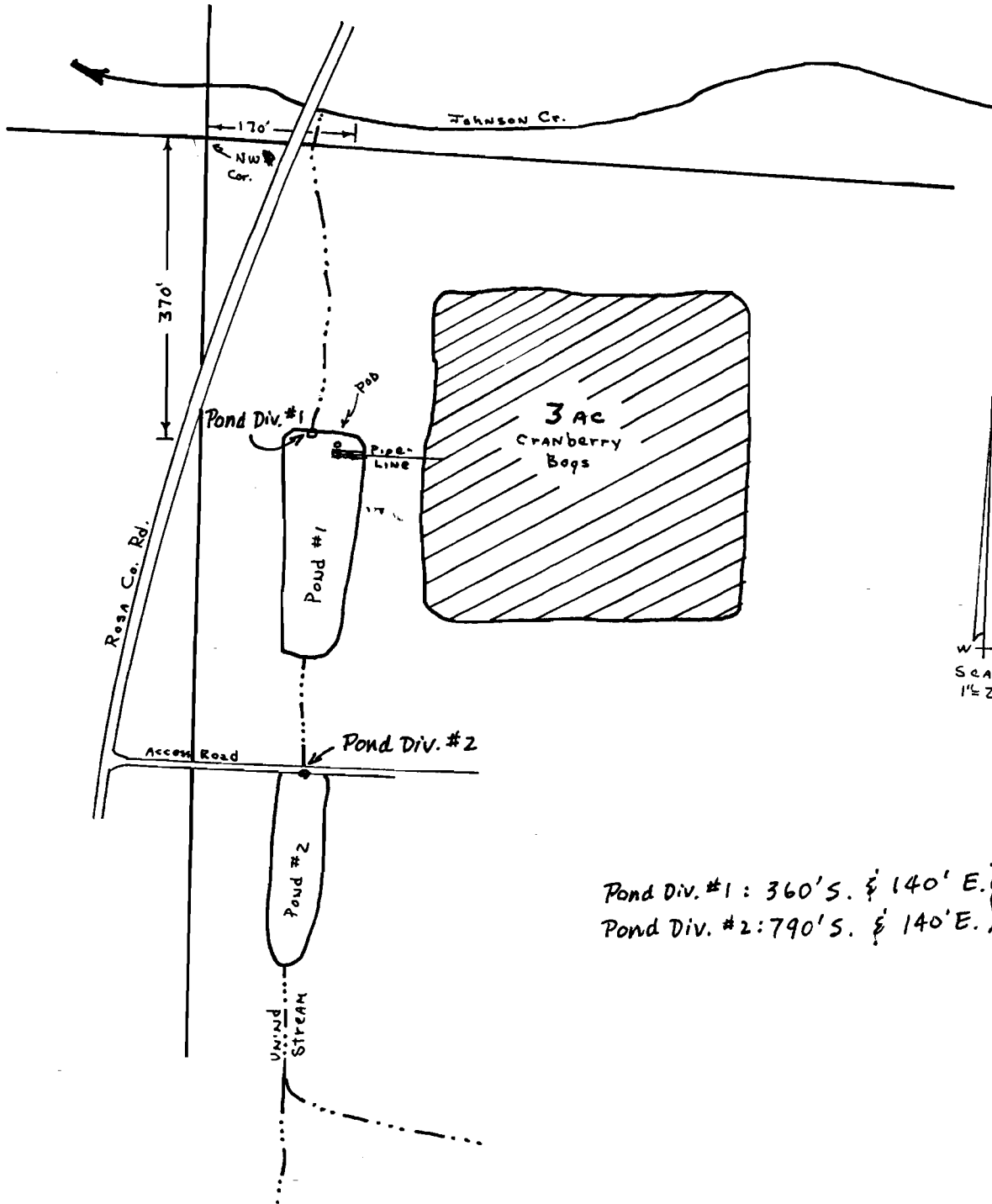

Pond Div. #1 : 360' S. & 140' E. } from
 Pond Div. #2 : 790' S. & 140' E. } NW Cor. Sec. 8

Application No. R-60384 & 60385

Permit No. R 8271 45773