

RECEIVED

AUG 17 1981

WATER RESOURCES DEPT  
SALEM, OREGON

T. 2 N. R. 33 E.

Sec. 8

NW 1/4 NW 1/4

Application No. R-62332 &  
62333

Permit No. R 8375 46543

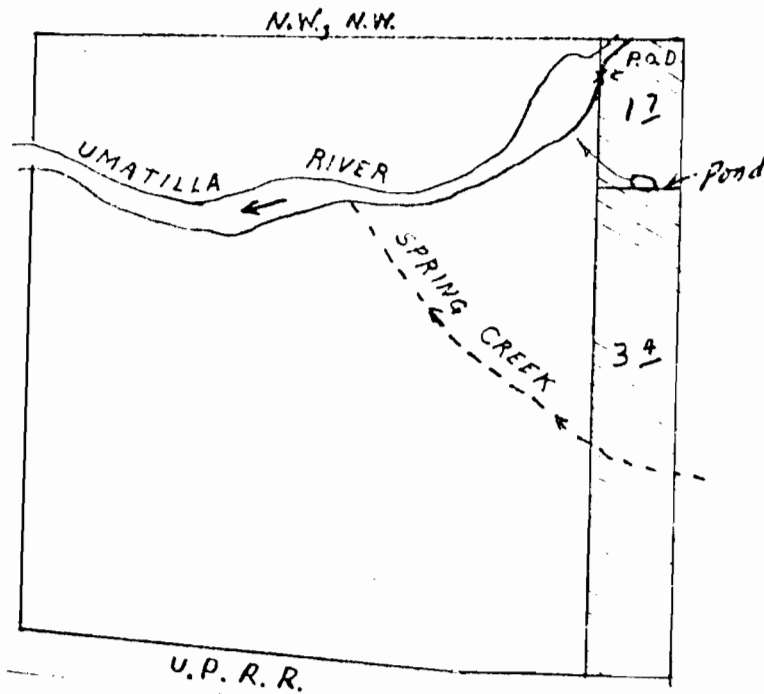

P.O.D. Location 1200 ft. E. + 100 ft. S.  
from N.W. Cor. Sec. 8

Spring pond Located 1250 ft. E + 300 ft. S.  
from N.W. Cor. Sec. 8

Scale: 1" = 400'

RECEIVED

MAY 16 1982

WATER RESOURCES DEPT  
SALEM, OREGON