

Application No. 66009 + R-66008
 Permit No. 48042
 R 9093

T26S R12W
 SW 1/4 SW 1/4
 Sec 1

RECEIVED
 SEP 9 1983
 WATER RESOURCES DEPT.
 SALEM, OREGON

RECEIVED
 NOV 2 1983
 WATER RESOURCES DEPT.
 SALEM, OREGON

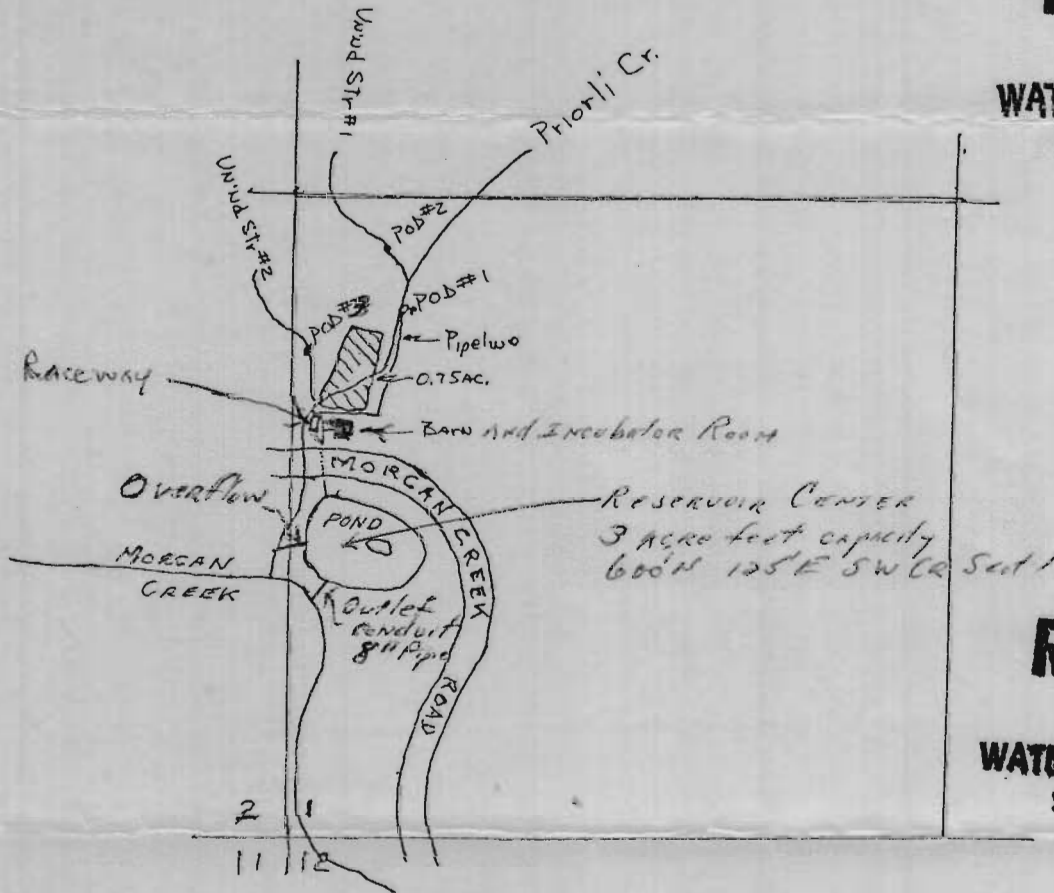

RECEIVED
 OCT 24 1983
 WATER RESOURCES DEPT.
 SALEM, OREGON

POD#1 is 1090' N, 235' E from the SW cor. Sec 1
 POD#2 is 1220' N, 190' E "
 POD#3 is 1050' N, 35' E "

Owner: Korru-Tek (U.S.A.), Inc.

Official Property Description:

The Southwest quarter (SW 1/4) of the Southwest quarter (SW 1/4) of Section One (1), Township Twenty-six (26) South, Range Twelve (12) West of Willamette Meridian, Coos County, Oregon (26-12-1 TL 200)