

Sec 6

Tp. 39 S R 5 W, W.M.

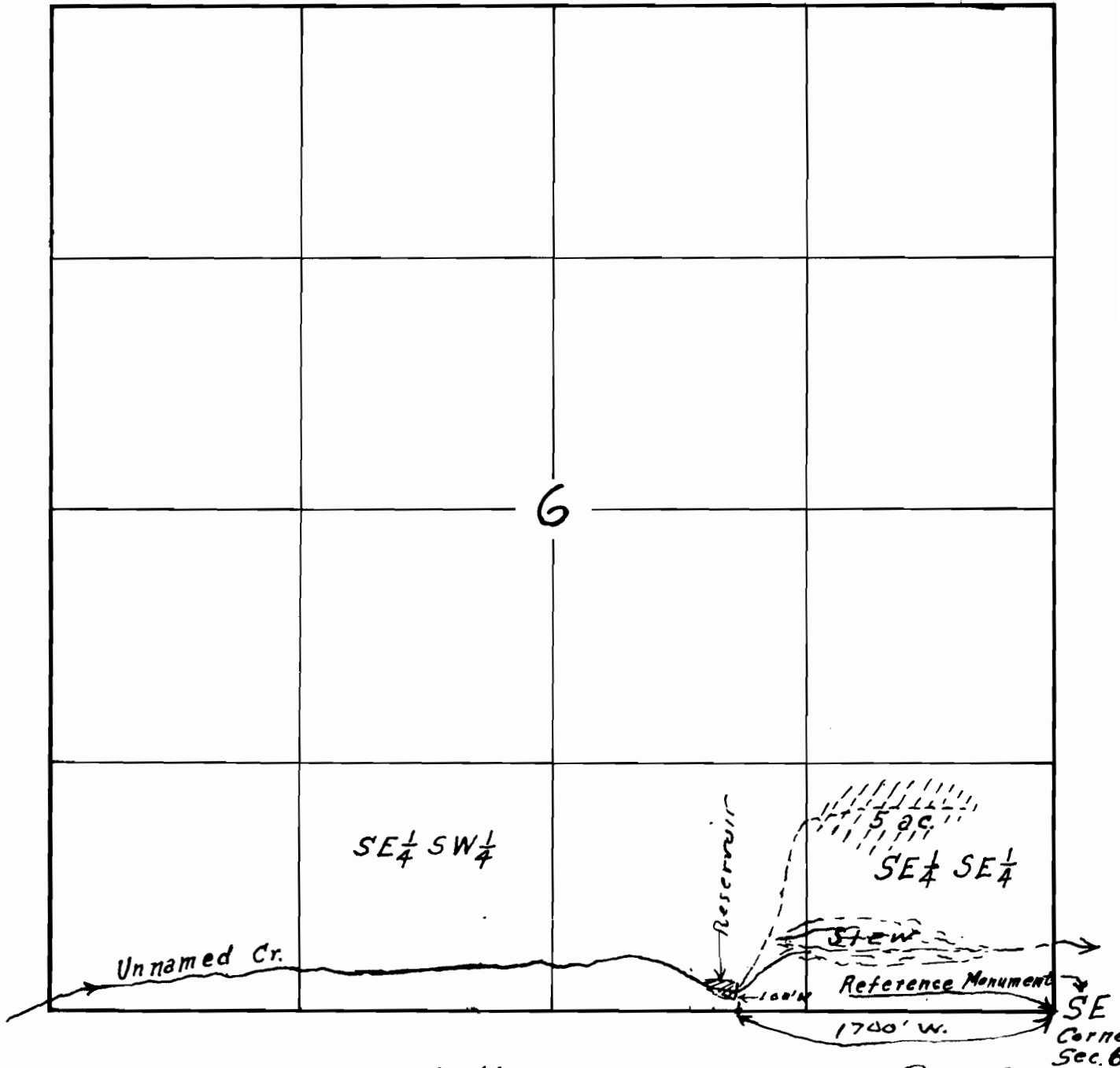

Map to accompany application
 of Harry Dunlap for Use of
 water from unnamed Cr trib. to W.Fk.
 Williams Cr. for irrigation purposes.

Application No. R-22982
 22983
 Permit No. R-919
 18096

Scale: ~~1" = 100'~~
 1" = 800'

This office
 9-29-47 CMS
 1-6-48

15-12-
 22983
 15-16 D