

R 9263
63212

UNITED STATES
DEPARTMENT OF THE INTERIOR
BUREAU OF LAND MANAGEMENT

RECEIVED

SEP 23 1983
WATER RESOURCES DEPT.
SALEM, OREGON

SECTION
35
SE 1/4 SE 1/4

Oregon State Water Filings

TOWNSHIP 38S., RANGE 4E., W. M.

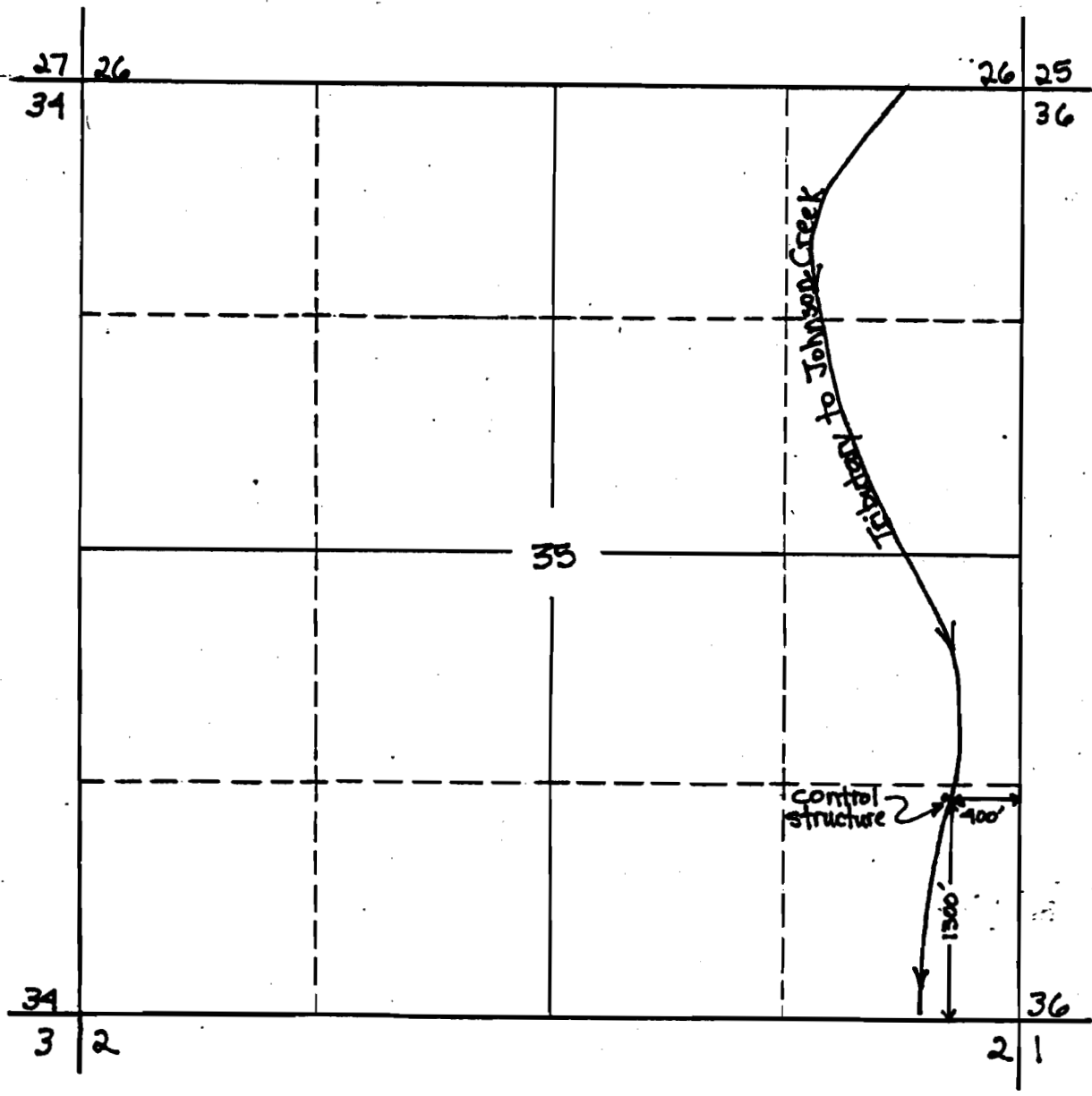

SCALE : 1" = 1000'

Application No. B-66717
Permit No. R 9263