

# MAP

TO ACCOMPANY APPLICATION TO  
APPROPRIATE THE PUBLIC WATERS OF  
THE STATE OF OREGON

RECEIVED  
JUL 15 1948  
STATE ENGINEER  
SALAS  
DIVISION

MARVIN E. YOUNG

APPLICANT

RANGE 36 EAST W.M.

T  
W  
P  
26  
S

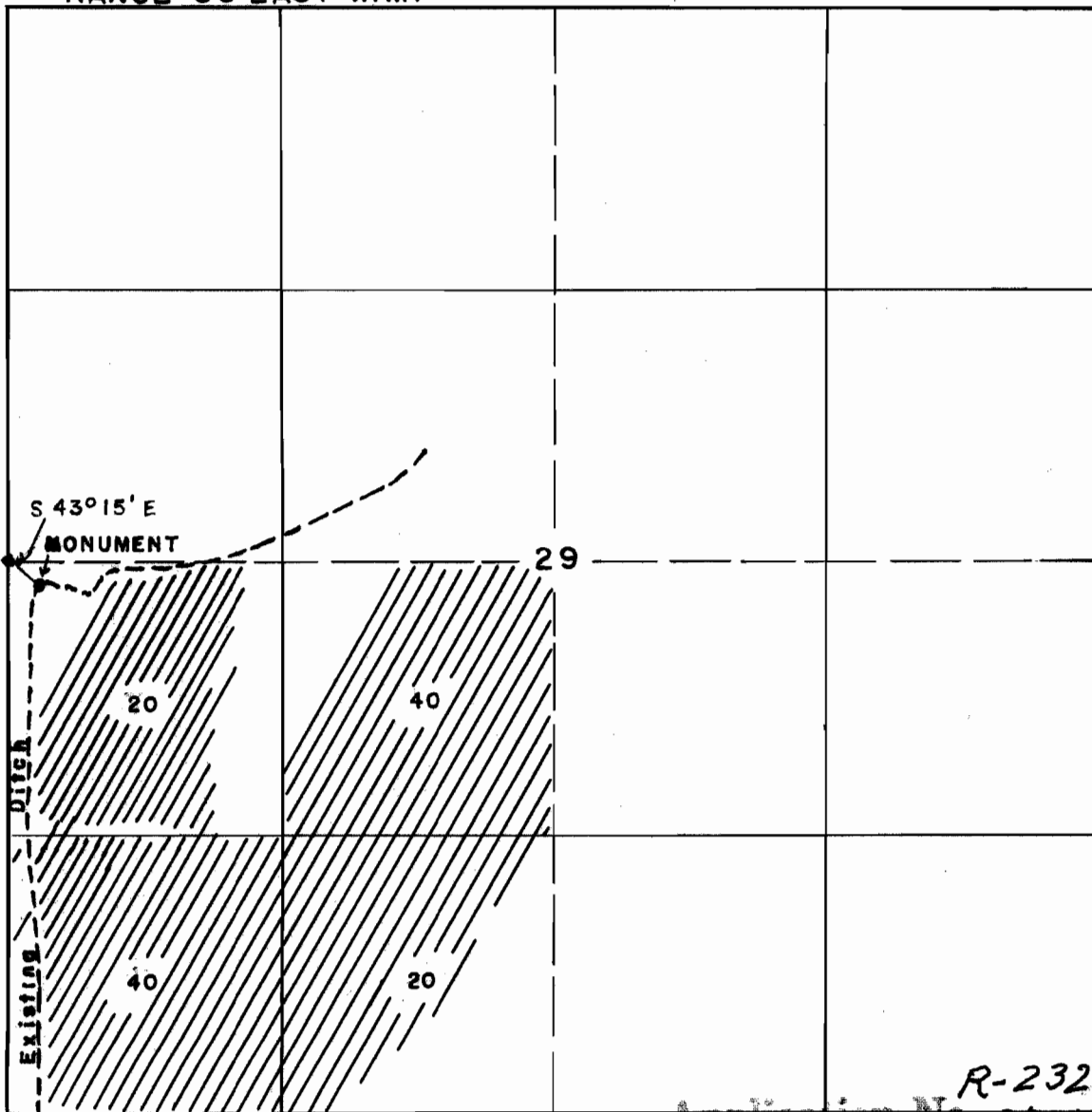

SCALE 1/6" = 1 MILE

Application No. ~~23235~~ R-23234  
Permit No. ~~R-01~~ 18348

I, Paul R. Revis of Burns, Oregon, do hereby certify that this map was made from notes taken during an actual survey made by me on March 6-7, 1948; that the monument shown on this map consisting of an iron pipe is S 43° 15' E, 685.0' from the W 1/4 Corner of Section 29, Twp 26 S., Range 36 E.W.M.

Oregon License No. 2511.

*Paul R. Revis*  
Registered Professional Engineer