

T.39S., R.13E.

T.39S., R.14E.

Application No. R-22973,
R-22974, R-22975 + 22976
Permit No. R-979, R-980,
R-981 + 18863

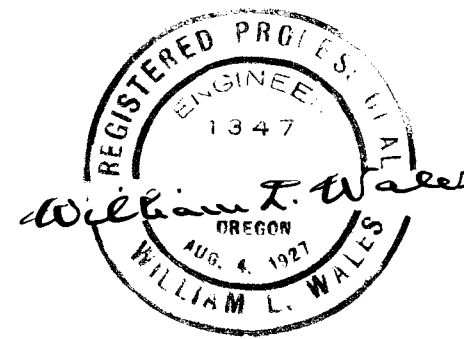
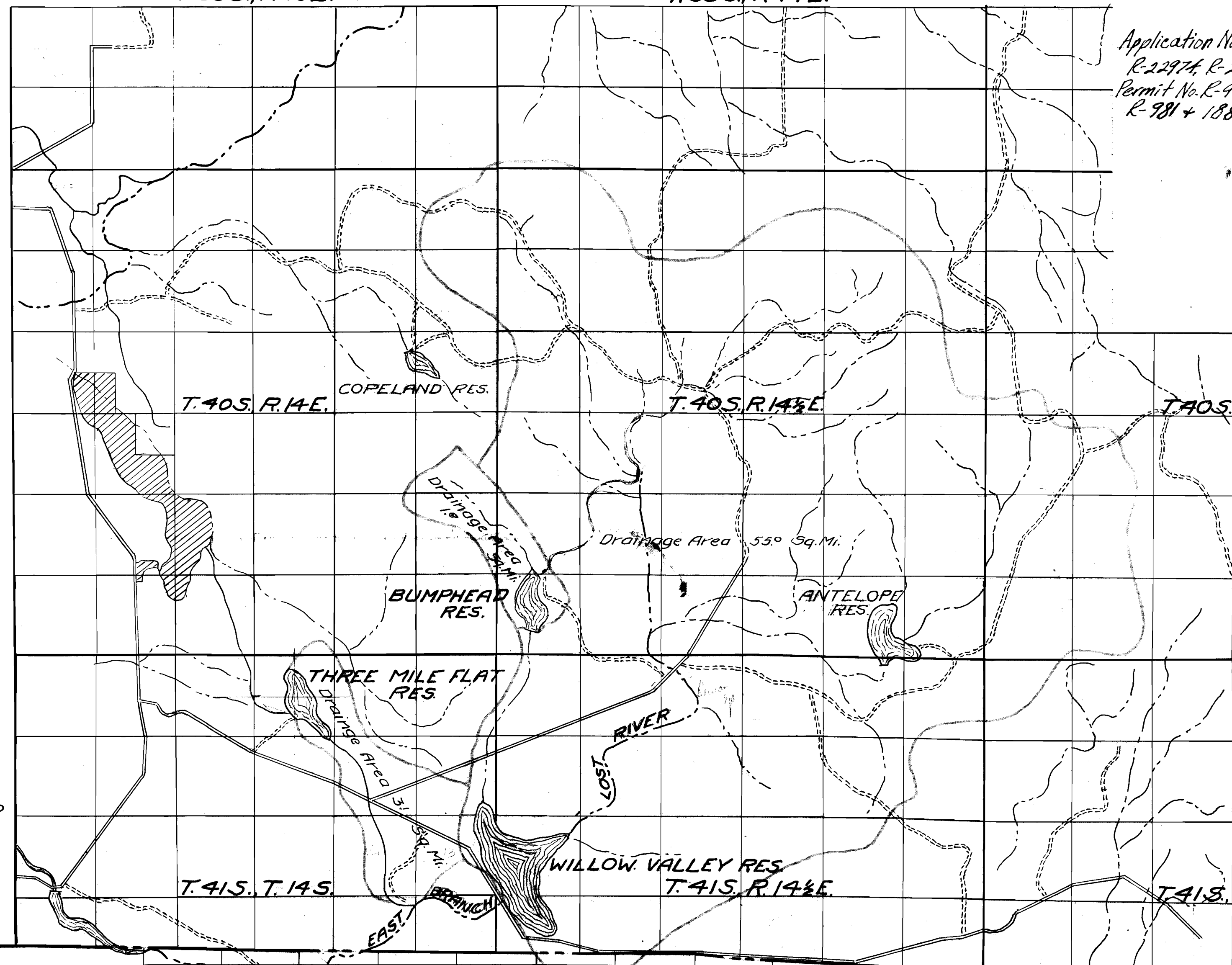
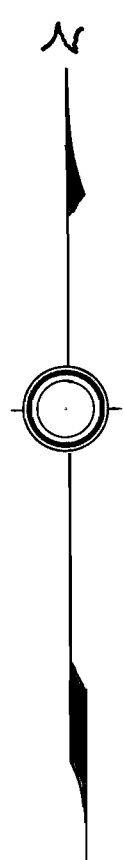

OREGON
CALIFORNIA

NOTE: This map based on General Land Office and Grazing District Maps and Soil Conservation Service Aerial Photographs with ground inspection.

MAP OF
WATERSHEDS OF THE
WILLOW VALLEY
IRRIGATION DISTRICT
KLAMATH COUNTY, OREGON.
Scale 1"=1Mi.
Survey & Map by William L. Wales & Son,
Klamath Falls, Oregon.

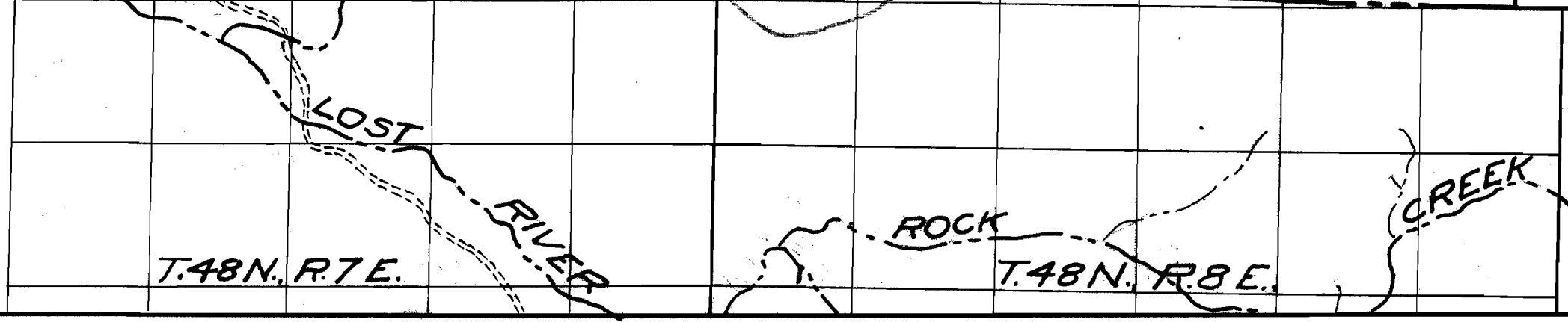

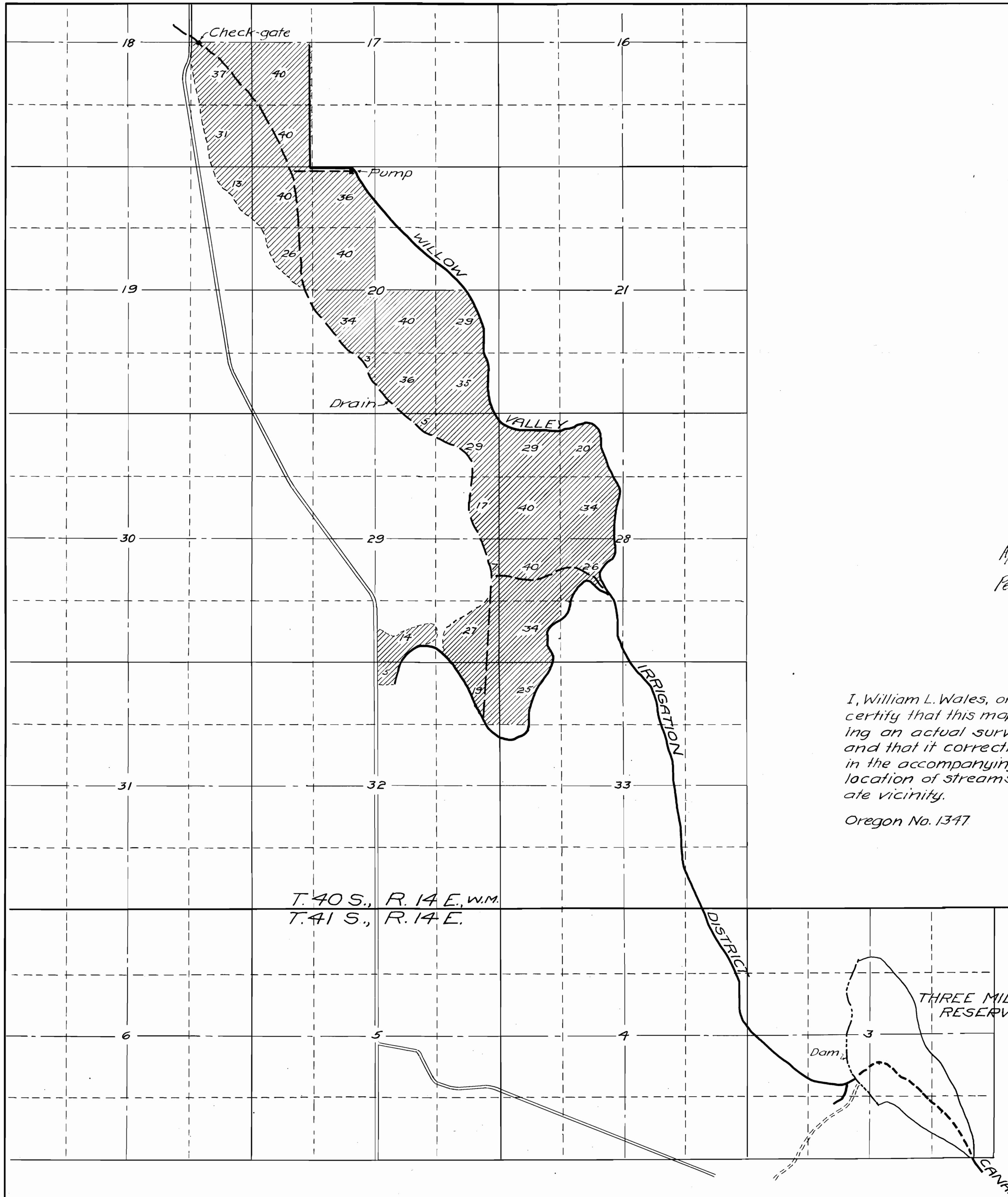

Application No. R-22973, R-22974, R-22975 & 22976
 Permit No. E-979, R-980, R-981 + 18863.

I, William L. Wales, of Klamath Falls, Oregon, do hereby certify that this map was made from notes taken during an actual survey made by me on April 2, 1947 and that it correctly represents the works described in the accompanying application together with the location of streams and other ditches in the immediate vicinity.

Oregon No. 1347

William L. Wales
 Registered Professional Engineer.
 Date of Registration Aug. 4, 1927.

William L. Wales

MAP OF
 ADDITIONAL WATER-RIGHTS
 WILLOW VALLEY
 IRRIGATION DISTRICT.
 KLAMATH COUNTY, OREGON
 Scale 4" = 1 Mile.
 Surveyed and Mapped by: William L. Wales,
 Klamath Falls, Oreg.