

Application No. 13924

Serial No. 10048

U.S. DEPARTMENT OF AGRICULTURE
FOREST SERVICE
MT. HOOD NAT'L FOREST
SUMMIT RANGER STATION

WATER RIGHT
CLACKAMAS COUNTY, ORE.

T. 3 S., R. 8 1/2 E. W. M.

Scale 1 inch = 300 ft.

Frances E. Williamson Jr.

November 1930

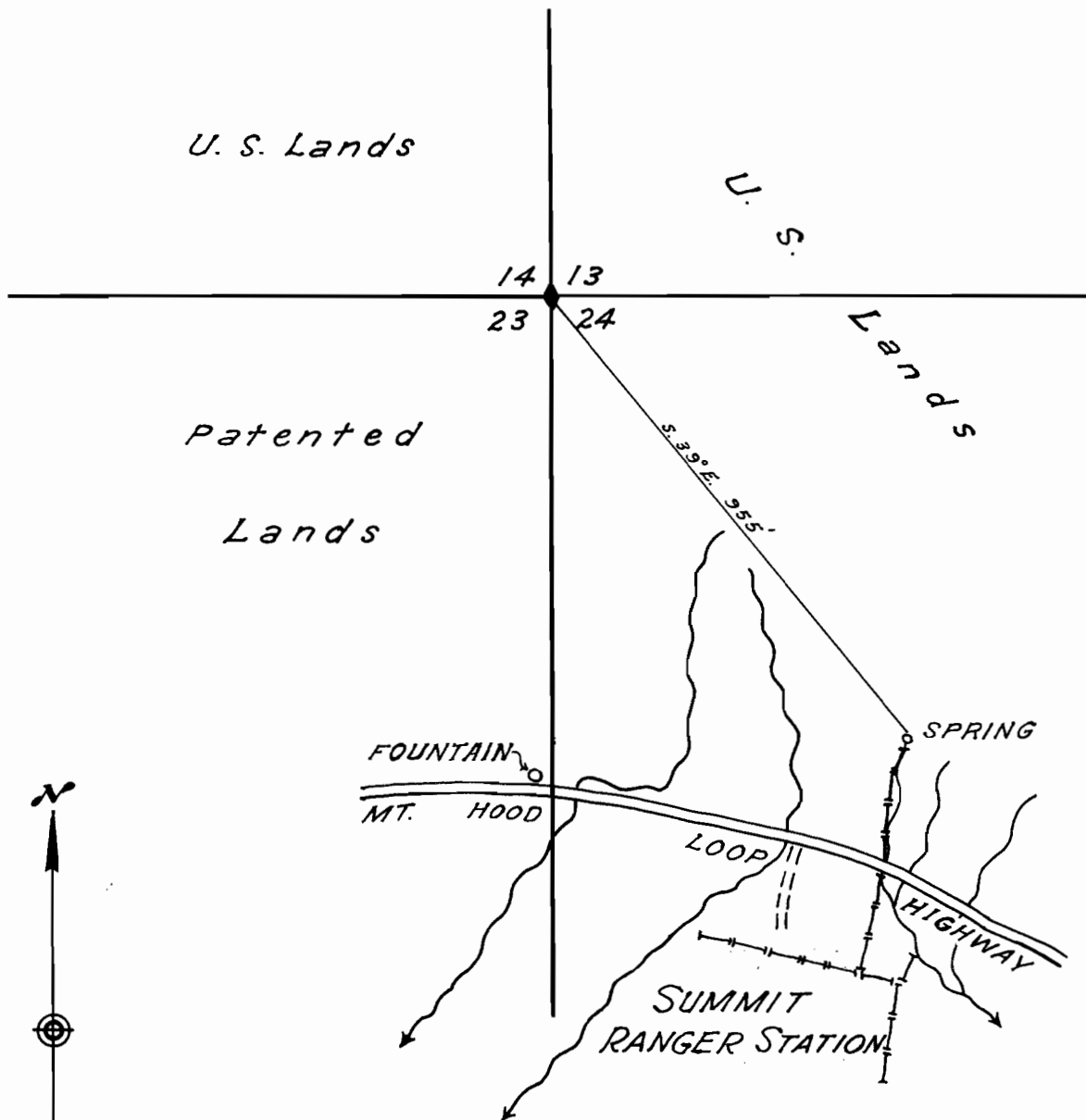

Submitted January 13, 1931

By *Frances E. Williamson Jr.*
RECREATION ASSISTANT