

MAP

Accompanying application of Scott Davis of Medford Jackson County Oregon for Permit to the waters of Rogue River Jackson County through the Nichols Ditch for the purpose of Irrigation

April 4 1931

STATE ENGINEER
RECEIVED
APR 9 1931
SALEM, OREGON

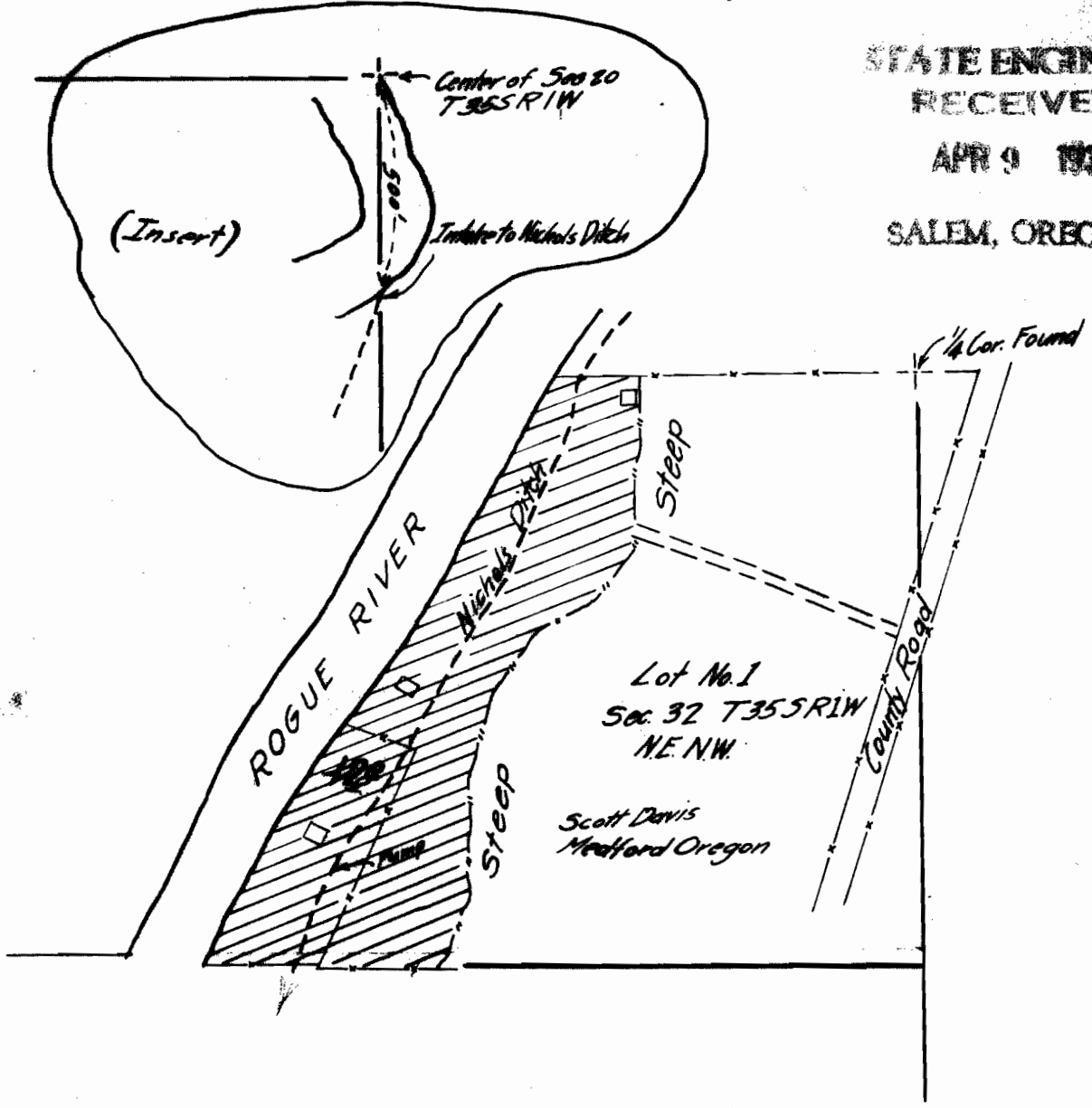

Map made from Plane Table Survey by Chester A. Cummings

Application No. 14032
Permit No. 10119