

Township 2 North Range 32 East Will, Mer. Or.

Map of
E. F. Straugh's Irrigation Ditches. Showing Pumping Stations,
for Irrigating Land above Ditches.

OFFICE OF STATE ENGINEER
PENDLETON, OREGON
DEC 30 1911
J. W. KIMBRELL

I, John W. Kimbrell of Pendleton Oregon do hereby certify that this map was made from notes taken during an actual survey made on the 26th day of December 1911 and that it correctly represents the location of streams and other ditches in the immediate vicinity, and has written thereon the area in each smallest legal subdivision which it is proposed to irrigate.

John W. Kimbrell
Surveyor.

Application No. 1960
Permit No. 1022

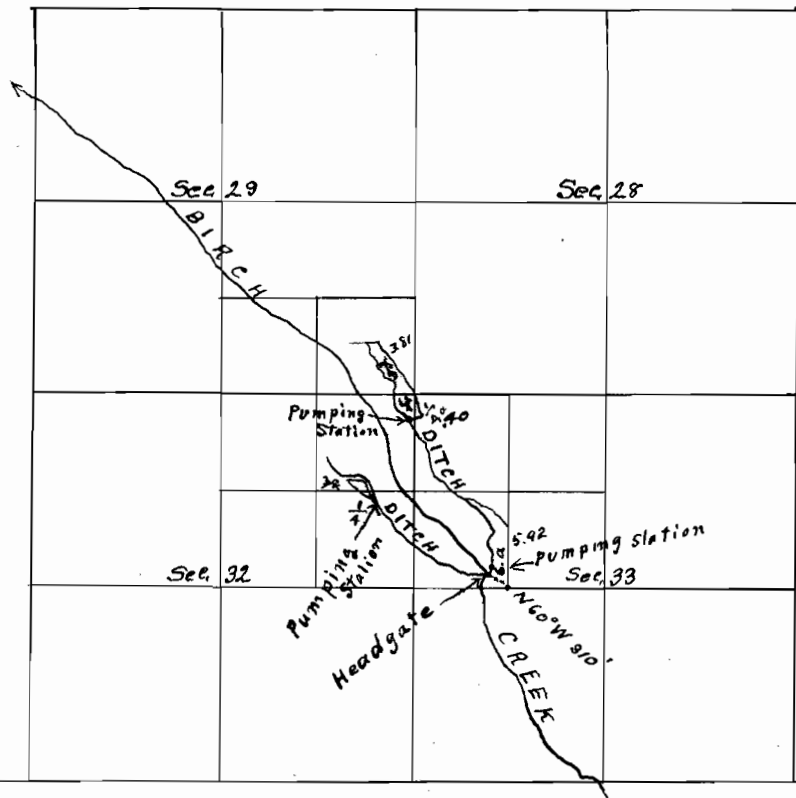

True Meridian
Var. 21° 30' E
Scale 40 chs 1"