

IRRIGATED DISTRICT OUTLINED IN BLUE

SEC 14 - T 27 S. R 12 W

App. No. 14159
Permit No. 10225

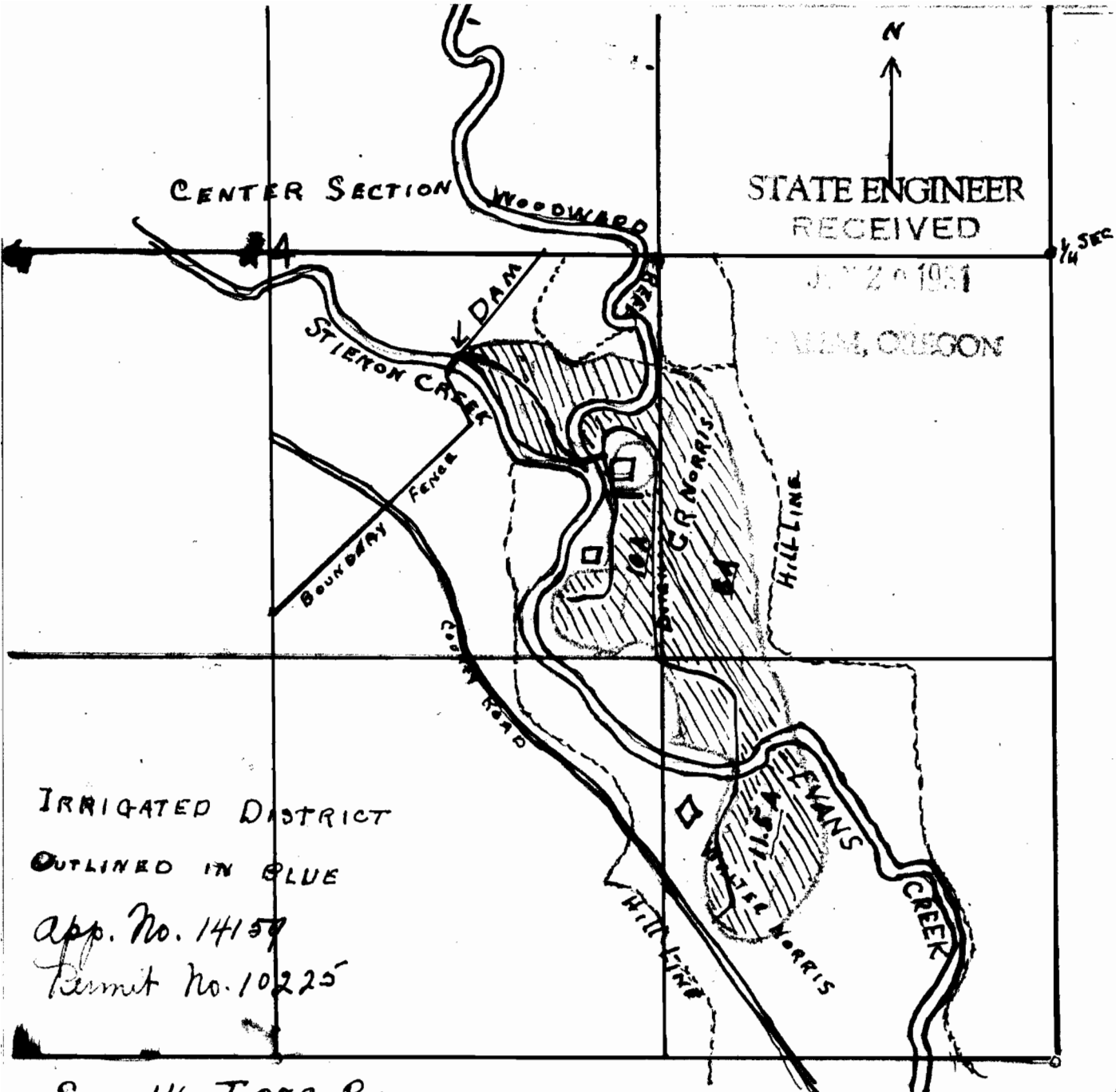

CENTER SECTION

STATE ENGINEER
RECEIVED

JUN 20 1951

LANE, OREGON

WOODWARD
DAM
STIERON CREEK

BOUNDARY FENCE

104
104
C.R. NORRIS

HILL LINE

COUNTY ROAD

EVANS
1134
WALTER NORRIS

HILL LINE

IRRIGATED DISTRICT

OUTLINED IN BLUE

App. No. 14159

Permit No. 10225

SEC 14. T 27S R 12W