

SECTION

Sec 27

TOWNSHIP 13 S, RANGE 10 W, W. M.

North

West

East

STATE ENGINEER
RECEIVED
AUG 13 1931
SALEM, OREGON

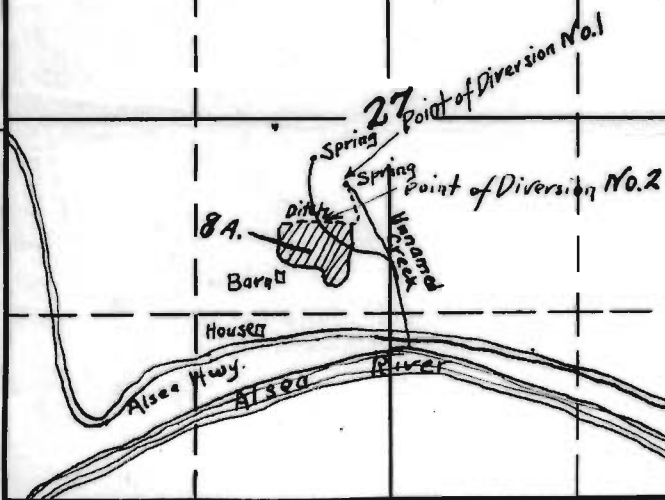

South

We are not positive about the diversion line
It runs into the Alsea River during
the winter months having heavy rainfall, only.
Mrs. G. Heckman

APPLICATION No. 14231

PERMIT No. 10293