

PORTION T. 3 S., R. 8 E., W. M.  
MOUNT HOOD NATIONAL FOREST, OREGON.

North

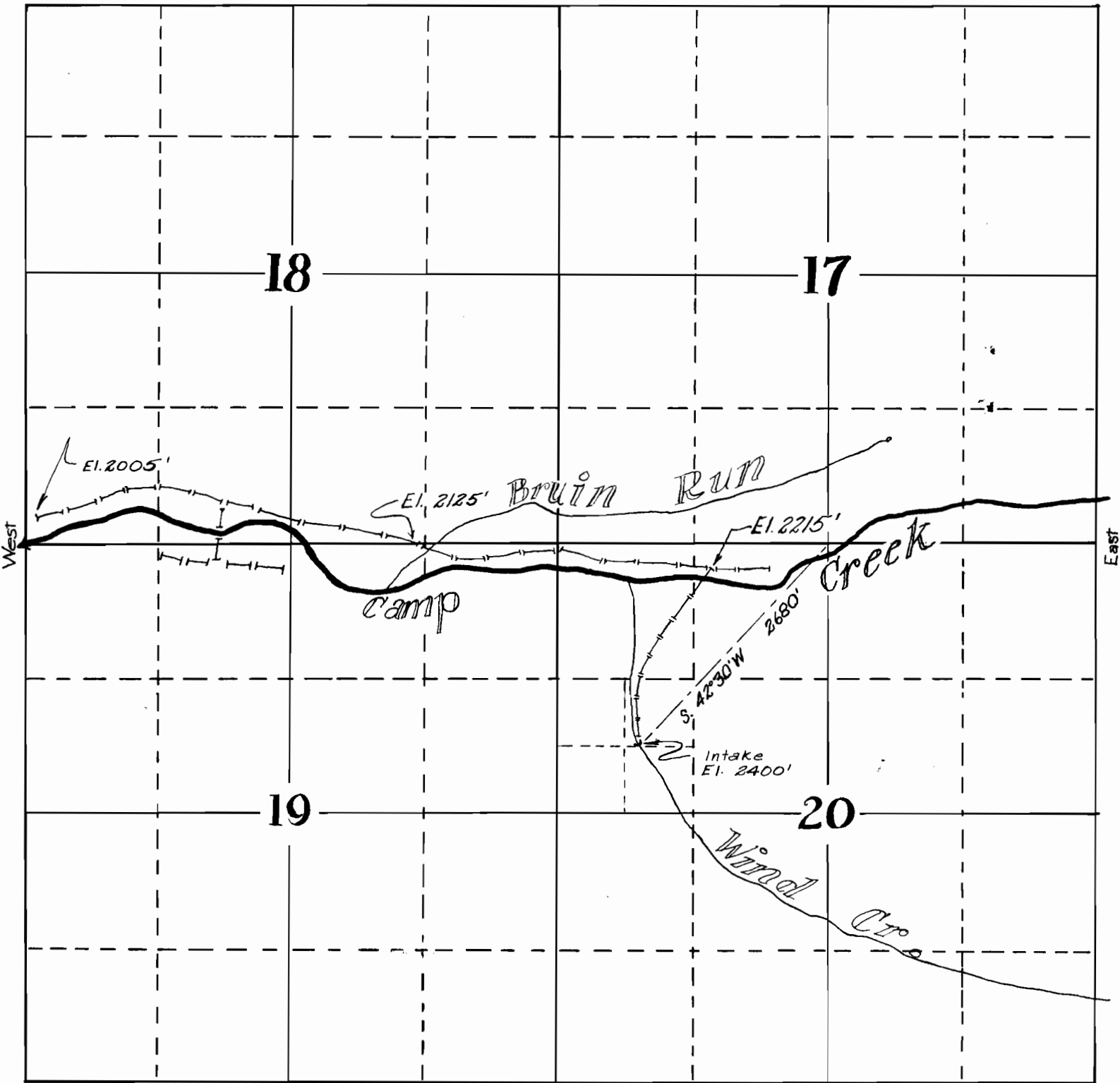

South

I, Francis E. Williamson, Jr. of the U.S. Forest Service, do hereby certify that this map was made from notes taken during an actual survey made by me and Forest Service maps, on August 11, 1931, and that it correctly represents the works described in the attached application, together with the location of streams and proposed pipe lines.

*Francis E. Williamson, Jr.*  
Senior Forest Ranger.

APPLICATION No. 14250  
PERMIT No. 10294

Scale 4" = 1 Mile  
Mag. Decl. 21°30'E