

T.13S. R.10W. W.M.

Application No. 14346  
Permit No. 10374

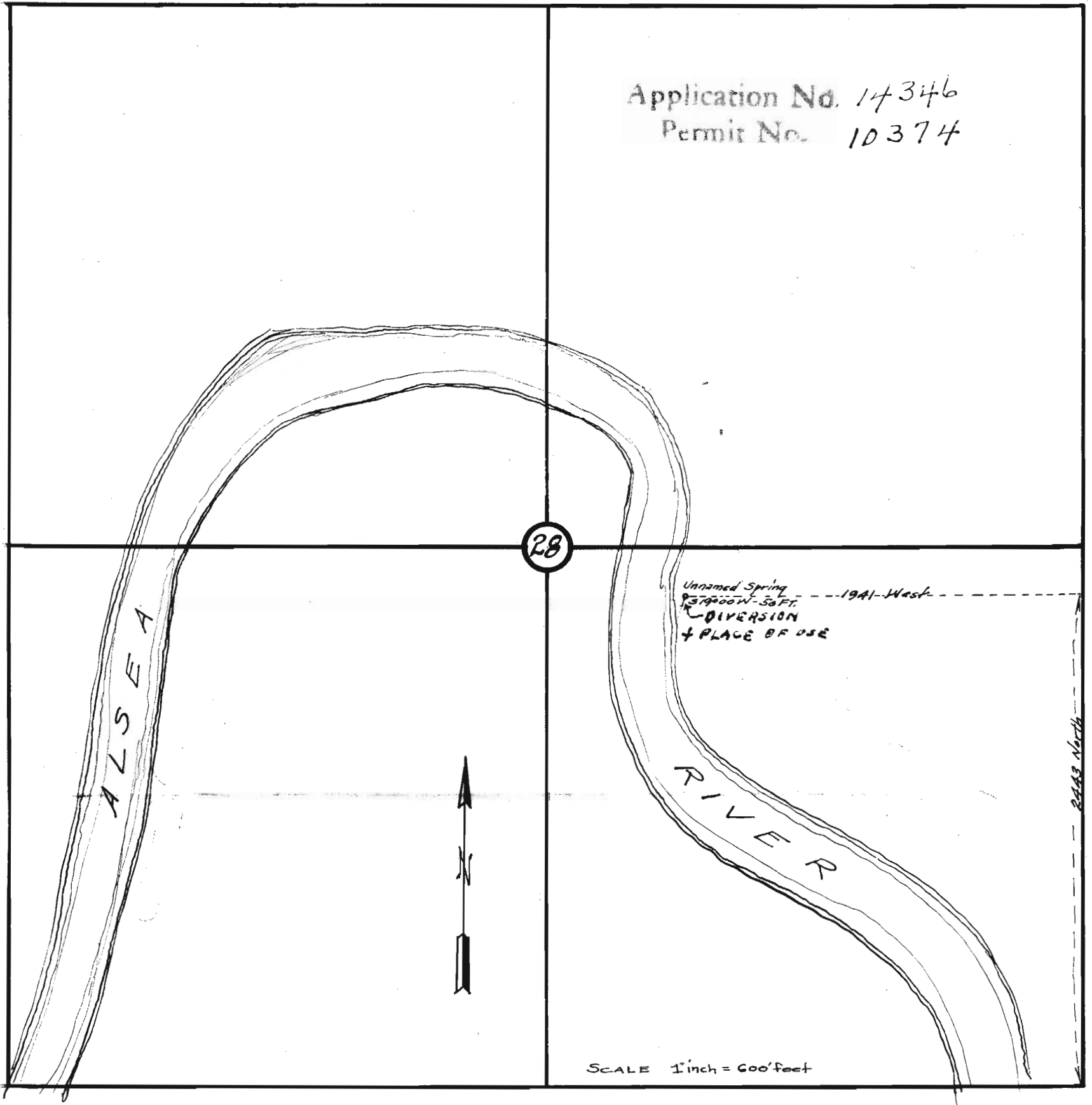

I, H.M. Teel of Toledo, Oregon do hereby certify that this map was made from notes taken during an actual survey made by me September 25, 1931 and that it correctly represents all other streams and ditches in the immediate vicinity, and correctly represents the works described in the accompanying application.

Oregon No. 1013 -----

H.M. Teel  
Registered Professional Engineer

-----  
Date of Registration May 8, 1920