

SECTION

10

TOWNSHIP 6-5, RANGE 8-W, W. M.

North

NW $\frac{1}{4}$

NE $\frac{1}{4}$

SW

SE $\frac{1}{4}$

South

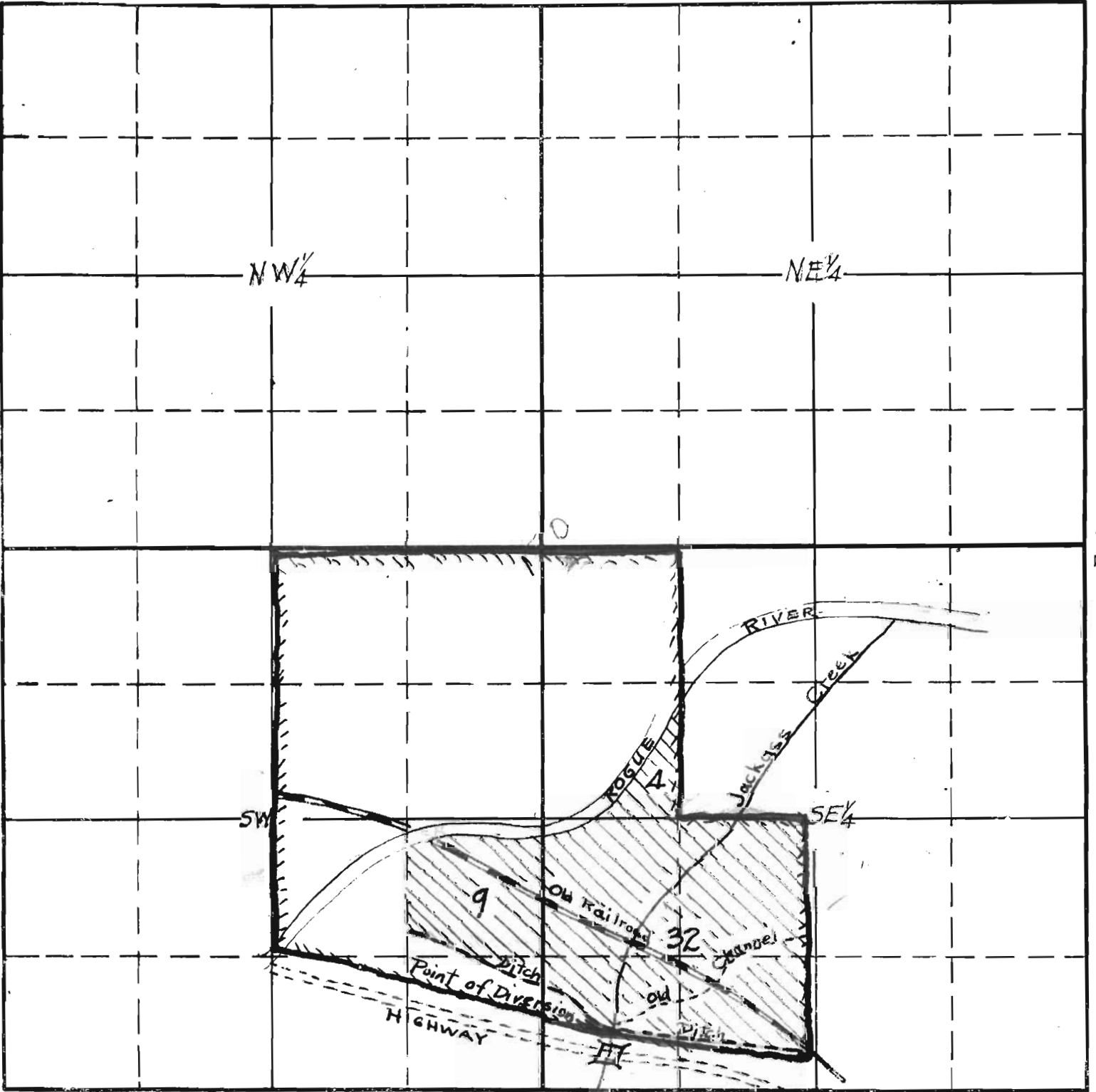

APPLICATION No. 14373

PERMIT No. 10390

T.6 S. R.8 W.

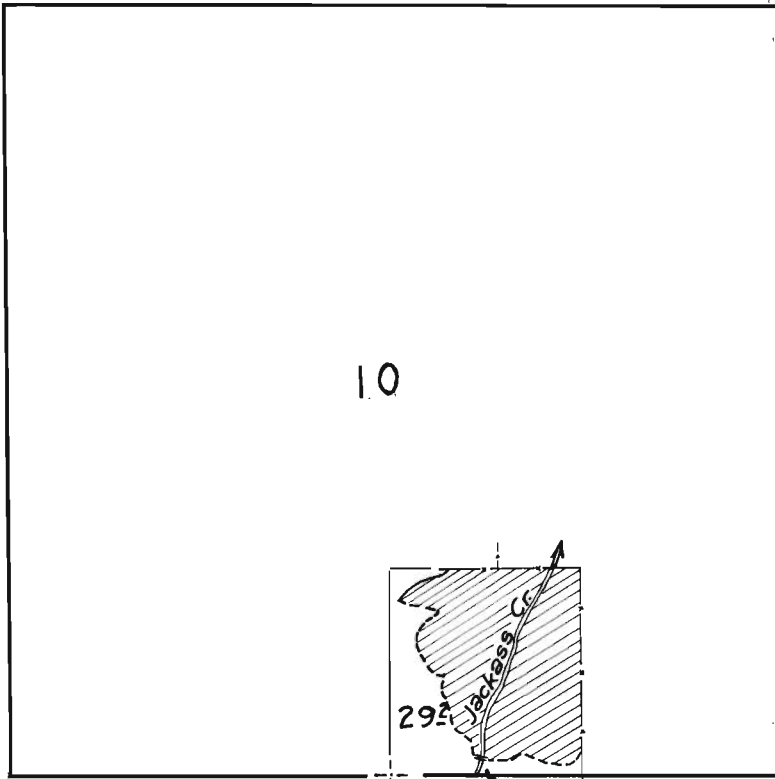

1/4 Cor

Diversion

Dean Stewart  
Oct. 13, 1937

App. 14373  
Permit 10390

itches Large enough to  
carry all water required  
to irrigate. Land the land  
is poorly irrigated