

SECTION

TOWNSHIP 25S, RANGE 11W, W. M.

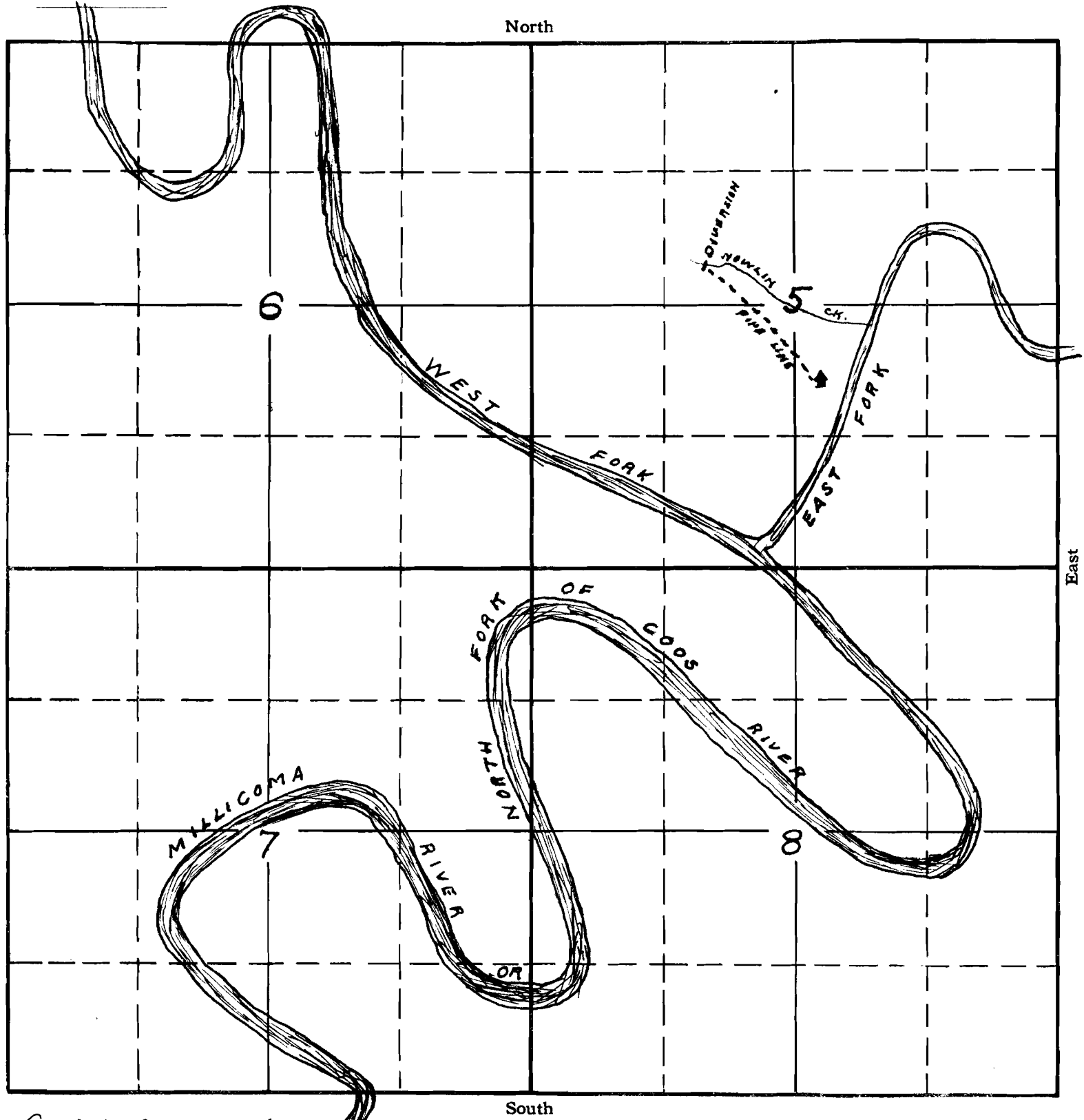

Copied from applicant's
 sketch - checked with plat
 record - 3/17/33.

APPLICATION No. 104879
 PERMIT No. 10852

Re: James Nowlin Water Permit
in Section 5 Township 25, South Range 11 West.
Coos County, Oregon

STATE ENGINEER

RECEIVED

MAR 17 1935

CLATSOP, OREGON

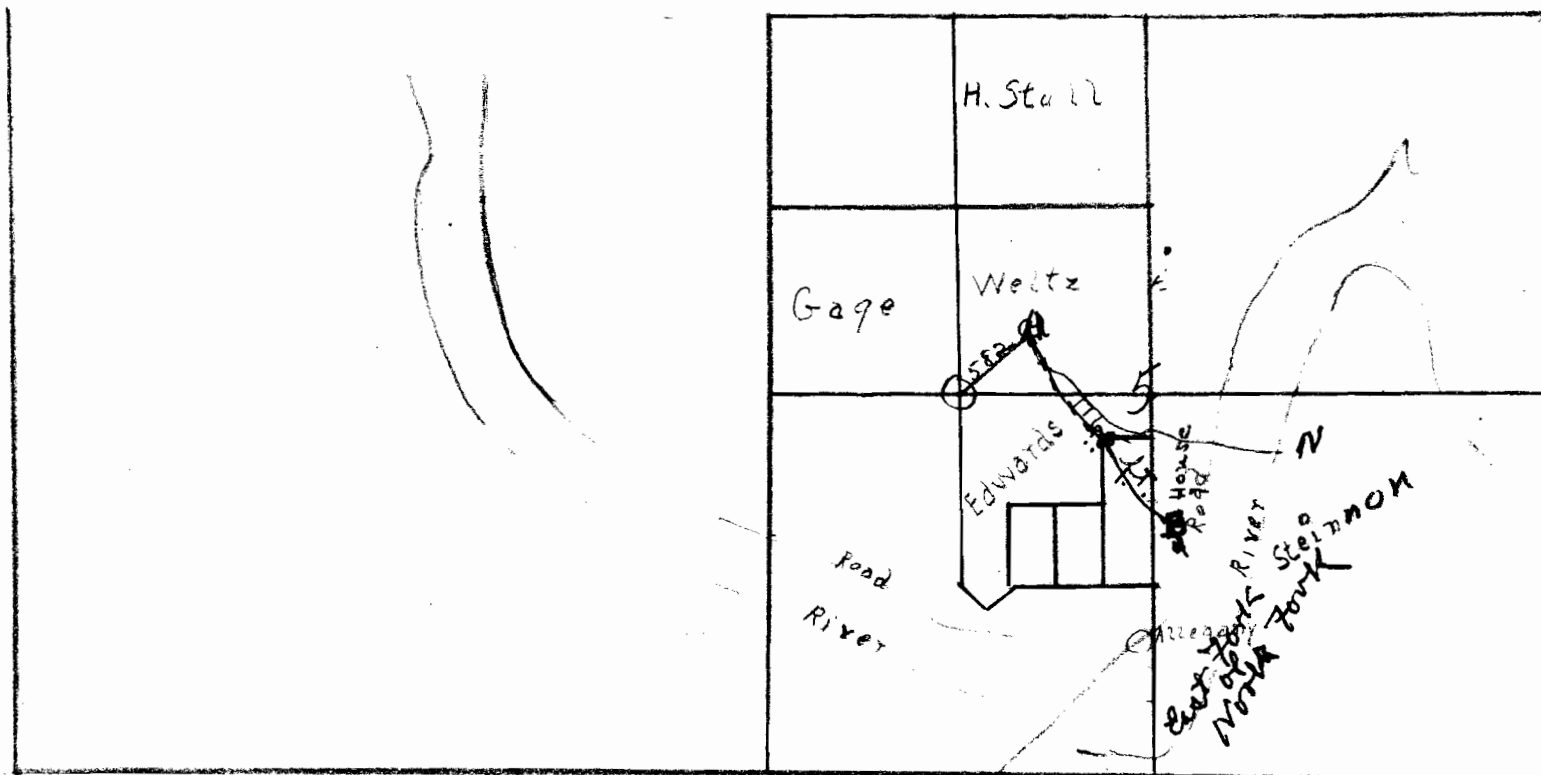

- A. Indicates point of diversion found by starting at SW corner of S.E $\frac{1}{4}$ of NW $\frac{1}{4}$ of Sec 5. Running E 10 $^{\circ}$ N. 582 feet to location of spring. The proposed point of diversion and water tank.
- B. indicates the place of termination and is found by running in a south-easterly direction from point A by substantially by running E. 40 $^{\circ}$ S 1165 ft. to applicant's residence in NW $\frac{1}{4}$ of SW $\frac{1}{4}$ of said Section 5. Pipe line in present use is about 500 feet in length, and will be extended to point A.

Application No. 14679
Permit No. 10825