

Northwest quarter section - Sec 6

Southeast 40 acres
of NW 9 sec. - Sec 6.

Spring - 100' West then 50' South of
location corner of place.

2720.19' N of quarter section
corner between Sec 6 & 7.
(location corner for place being
purchased.)

Center point Sec 6.

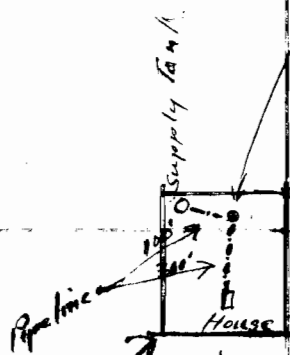

Area to be irrigated
includes the complete
property.

RECEIVED

DEC 6 1933

STATE ENGINEER
SALEM, OREGON

RECEIVED

DEC 10 1933



Scale 10" = 1 mile

App. No. 15163
Per. No. 11110

quarter section corner
between Sec 6 & 7
T.I.S. R.I.E. W.M