

PRIORITY, DATE DEC. 6, 1933.

21

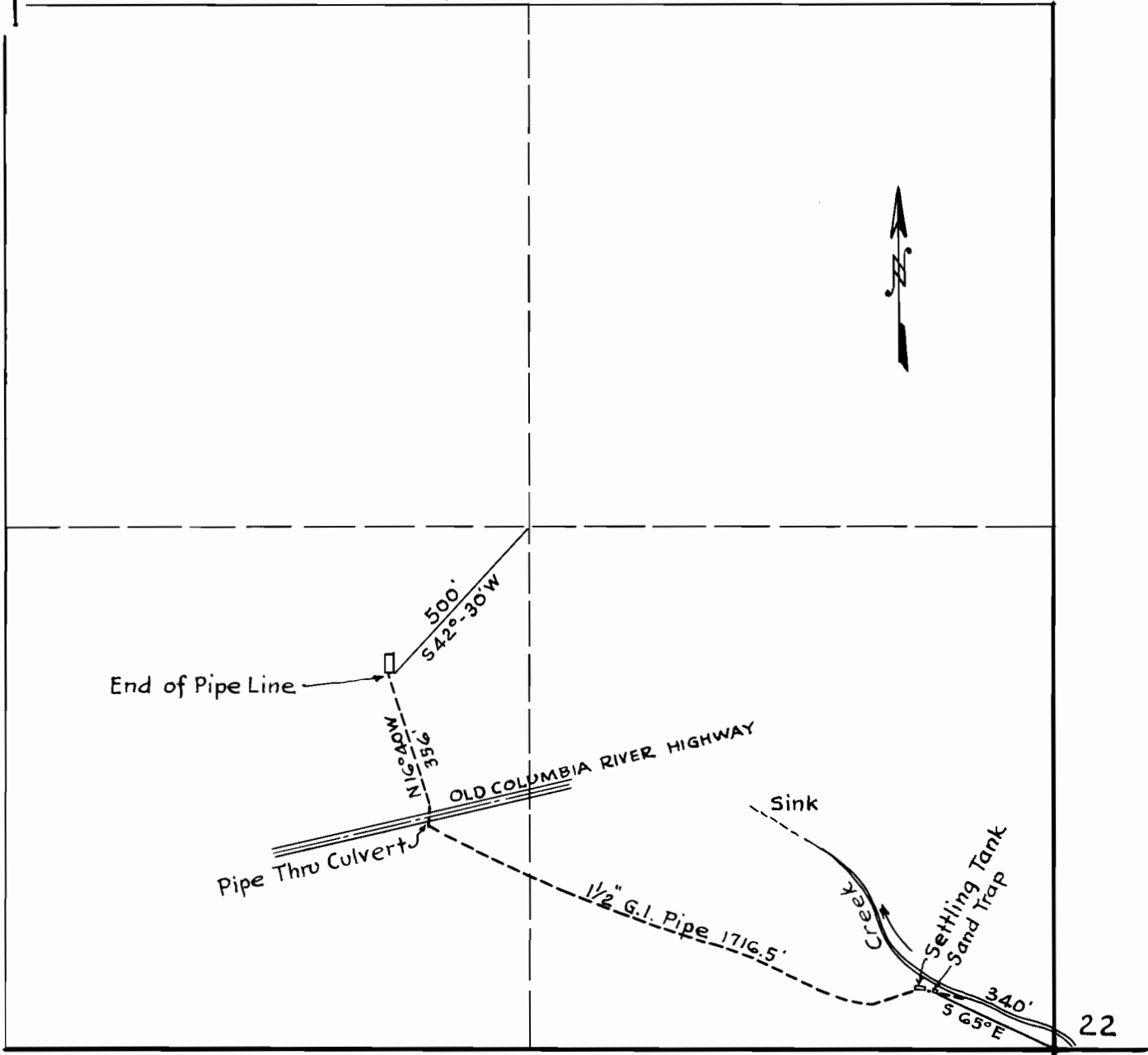

SEC. 21 T 2. N.  
R. 7 E. W. M.  
MULTNOMAH COUNTY, OREGON.

MAP TO ACCOMPANY PROOF OF APPROPRIATION OF WATER  
UNITED STATES OF AMERICA  
BY THE DISTRICT ENGINEER  
U. S. ENGINEER DEPT.  
BONNEVILLE OREGON.

APRIL 1938

SCALE 1" = 400'