

SECTION _____

TOWNSHIP _____, RANGE _____, W. M.

T 37 S, R 4 W, N.M.

North

T 37 S, R 3 W, N.M.

RECEIVED
DEC 1 1905
S. E. DEPT. OF THE INTERIOR
BUREAU OF LANDS

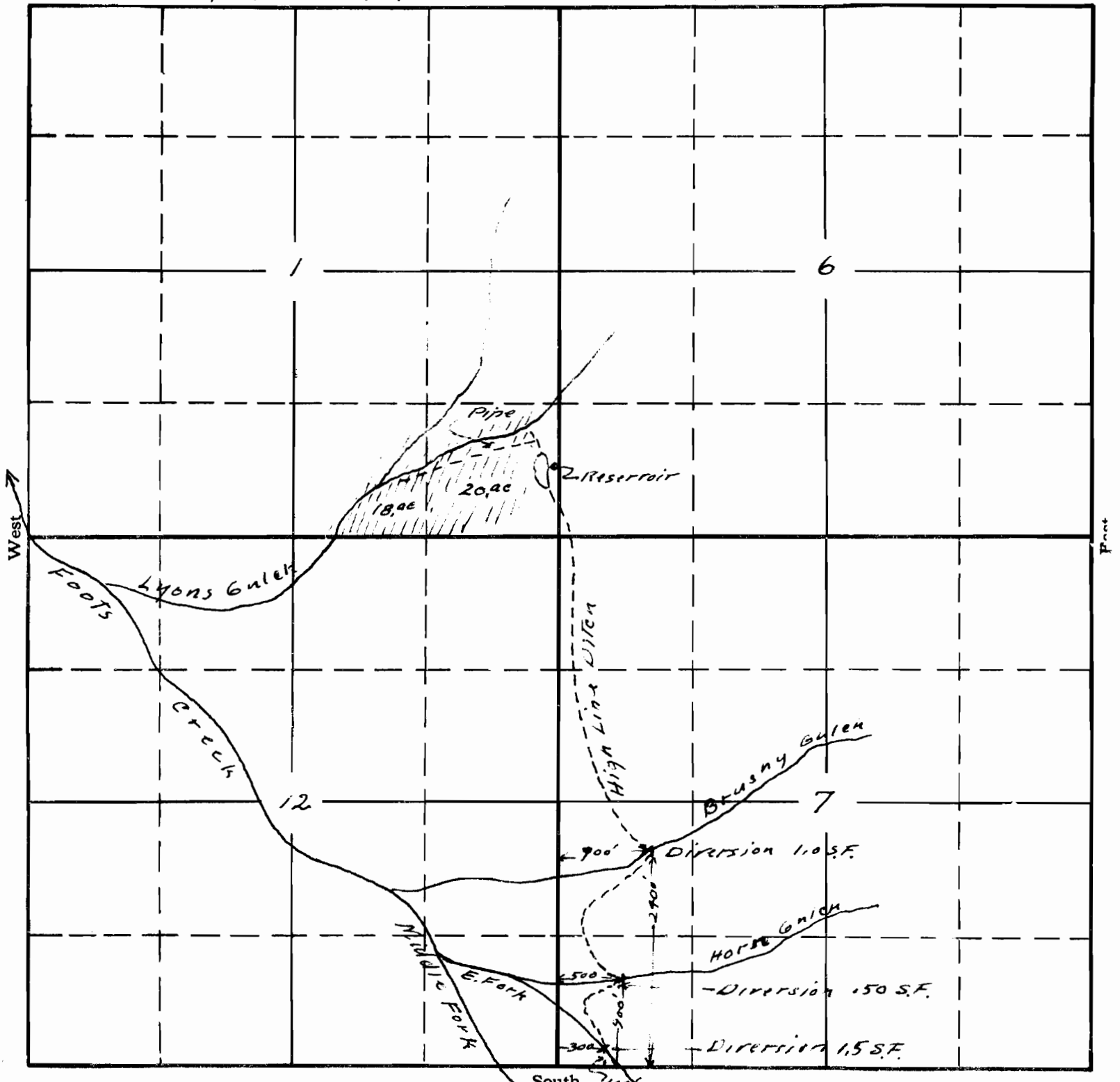

Map accompanying application
of Edward B. Pretountain
for mining.

APPLICATION No. 15219

PERMIT No. 11136